

## Mechanically Attached TPO Membrane - Cover Board - Flute Filler - Existing Metal Roof - Purlin Fastened (Recover)

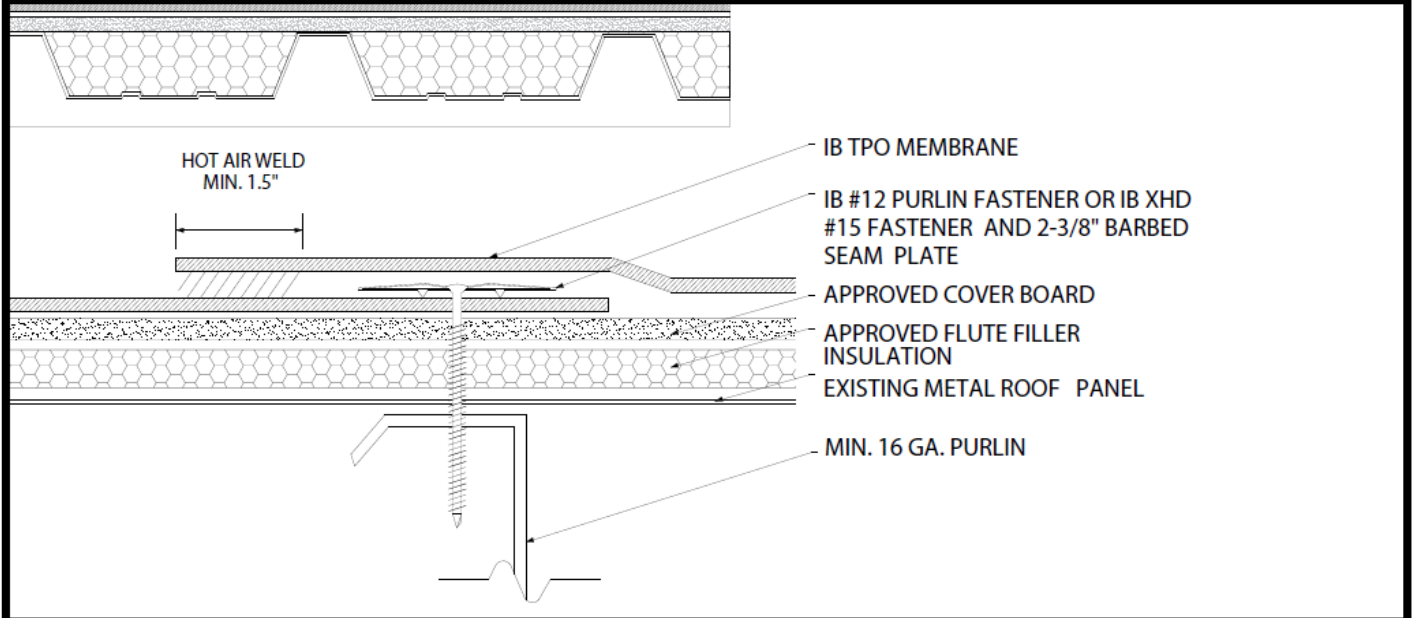

| Deck Type <sup>1</sup>                        | Cover Board /Flute Filler (over Existing Metal Roof) <sup>1</sup> |                                   |  | IB Membrane Securement <sup>4</sup>                 |                           |
|---|---|-----------------------------------|--|---|---------------------------|
|   | Type <sup>2,3,4</sup>   | Attachment                        | Fastener/Plate                         | Fastener/Plate <sup>**</sup>                        | Attachment <sup>***</sup> |
| Metal Roof Panel & 16 ga. Purlin, max 48" oc. | Approved Cover Board & Approved Flute Filler Insulation           | 1 per 6.4 sq. ft. (5 per 4' x 8') | Min. IB SD #12, 3" IB Insulation Plate | IB #12 Purlin Fastener, IB 2-3/8" Barbed Seam Plate | In-Seam @ 12" oc. x 48"   |
| Metal Roof Panel & 16 ga. Purlin, max 48" oc. | Approved Cover Board & Approved Flute Filler Insulation           | 1 per 6.4 sq. ft. (5 per 4' x 8') | Min. IB SD #12, 3" IB Insulation Plate | IB #12 Purlin Fastener, IB 2-3/8" Barbed Seam Plate | In-Seam @ 6" oc. x 48"    |
| Metal Roof Panel & 16 ga. Purlin, max 60" oc. | Approved Cover Board & Approved Flute Filler Insulation           | 1 per 6.4 sq. ft. (5 per 4' x 8') | Min. IB SD #12, 3" IB Insulation Plate | IB #12 Purlin Fastener, IB 2-3/8" Barbed Seam Plate | In-Seam @ 12" oc. x 60"   |
| Metal Roof Panel & 16 ga. Purlin, max 60" oc. | Approved Cover Board & Approved Flute Filler Insulation           | 1 per 6.4 sq. ft. (5 per 4' x 8') | Min. IB SD #12, 3" IB Insulation Plate | IB #12 Purlin Fastener, IB 2-3/8" Barbed Seam Plate | In-Seam @ 6" oc. x 60"    |

<sup>1</sup>Existing Roof: Metal Standing Seam or lapped seam Metal Panel Roof, having a min. 16 gauge, 50 ksi steel purlin

<sup>2</sup>Approved Flute Filler: IB Energy Board II or III, or IB Approved UL Classified Polyisocyanurate, IB Approved UL Classified Expanded Polystyrene, IB Approved UL Classified Extruded Polystyrene Insulation

<sup>3</sup>Approved Cover Board: DensDeck, DensDeck Prime, DensDeck StormX Prime, Securock Ultralight Glass-Mat, Securock Ultralight Coated Glass-Mat, Securock Gypsum Fiber Board, DEXcell Glass-Mat Roof Board, or DEXcell FA Glass Mat Roof Board, minimum 1/2" thickness; or minimum 7/16" DEXcell Cement Roof Board; or minimum 1/2" IB HD ISO-J, or 1/2" IB Recovery Energy Board III-J.

<sup>4</sup>The use of some IB Approved Flute Filler Insulations and/or Cover Boards or combinations thereof may not achieve UL Classification.

System Uplift Note(s): \*Refer to applicable Approval Guide for System Code and/or FM Approvals Information.

\*\*Refer to Substrate Resistance Table for required pull-out values. \*\*\*Contact IB Technical Services for maximum sheet width allowed relative to in-seam fastening pattern.

For additional information about IB Roof Systems requirements, recommendations, installation details, approvals, and limitations for the above assemblies, please refer to the latest edition of the IB Roof Systems Specifications Manual. For Technical Services please contact IB Technical Department at 800-426-1626.

| Membranes:        |  | Membrane Color: |      |     | Warranty Length <sup>**</sup> |         |         | Warranty Type <sup>**</sup>                  |  |
|-------------------|--|-----------------|------|-----|-------------------------------|---------|---------|--|--|
| IB TPO SM 60 Mil  |  | White*          | Gray | Tan | 10 Year                       | 15 Year | 20 Year | Contractor Warranty Only                     |  |
| IB TPO SM 80 Mil  |  | White*          | Gray | Tan | 15 Year                       | 20 Year | 25 Year | Total Systems - No Dollar Limit (TSW)        |  |
| IB TPO FB 115 Mil |  | White*          |      |     | 10 Year                       | 15 Year | 20 Year | Warranty Plus (WP)                           |  |
| IB TPO FB 135 Mil |  | White*          |      |     | 15 Year                       | 20 Year | 25 Year | Commercial Limited Material Warranty (CLMW)  |  |
|                   |  |                 |      |     |                               |         |         | Residential Limited Material Warranty (RLMW) |  |

\*Meets CRRC, Title 24, LEED (SRI)

\*\*Refer to Warranty Selection Guide for Warranty Riders, Term Length Limitations, and eligibility requirements of the IB Warranty Program

|               |  |               |  |
|---------------|--|---------------|--|
| Submitted By: |  | Project Name: |  |
| Company Name: |  | Address:      |  |
| Email/Phone:  |  | City/State:   |  |

## Mechanically Attached TPO Membrane - Insulation - Flute Filler - Existing Metal Roof - Purlin Fastened (Recover)

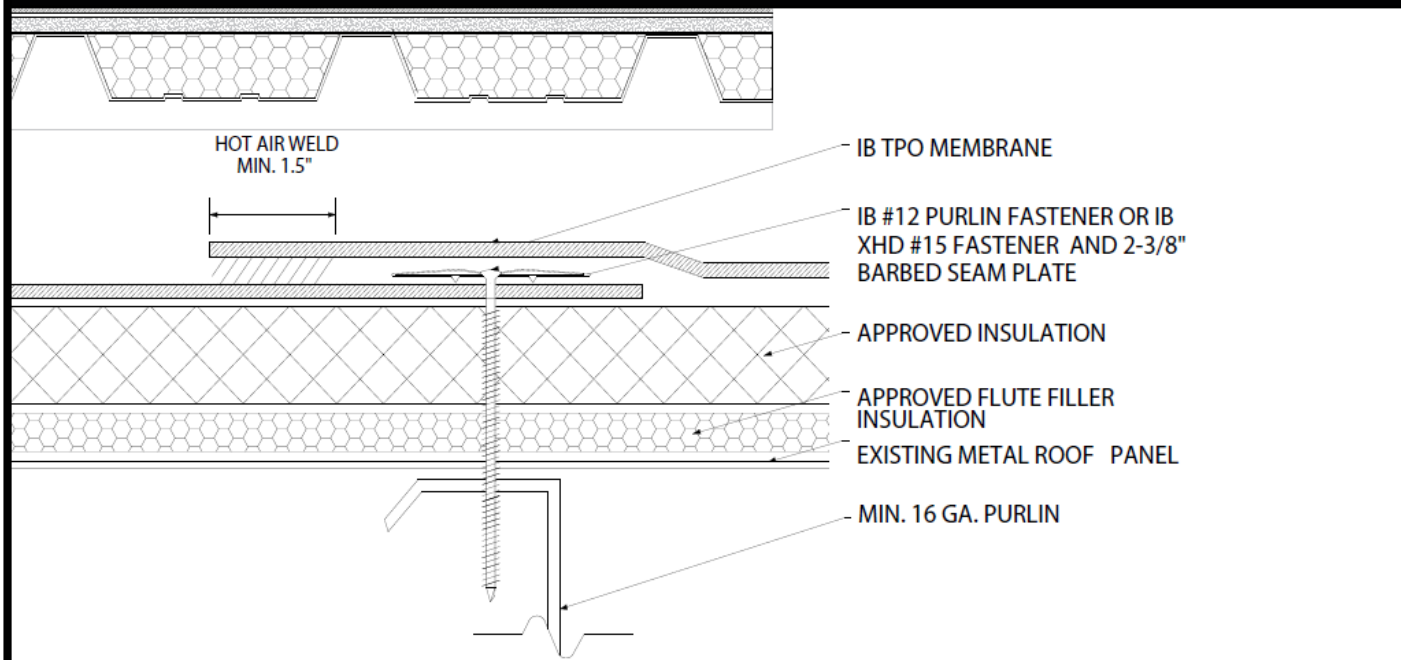

| Deck Type <sup>1</sup>                        | Insulation / Flute Filler (over Existing Metal Roof) <sup>1</sup> |                                   |  | IB Membrane Securement <sup>*</sup>                 |                           |
|---|---|-----------------------------------|--|---|---------------------------|
|   | Type <sup>2,3,4</sup>   | Attachment                        | Fastener/Plate                         | Fastener/Plate <sup>**</sup>                        | Attachment <sup>***</sup> |
| Metal Roof Panel & 16 ga. Purlin, max 48" oc. | Approved Insulation & Approved Flute Filler Insulation            | 1 per 6.4 sq. ft. (5 per 4' x 8') | Min. IB SD #12, 3" IB Insulation Plate | IB #12 Purlin Fastener, IB 2-3/8" Barbed Seam Plate | In-Seam @ 12" oc. x 48"   |
| Metal Roof Panel & 16 ga. Purlin, max 48" oc. | Approved Insulation & Approved Flute Filler Insulation            | 1 per 6.4 sq. ft. (5 per 4' x 8') | Min. IB SD #12, 3" IB Insulation Plate | IB #12 Purlin Fastener, IB 2-3/8" Barbed Seam Plate | In-Seam @ 6" oc. x 48"    |
| Metal Roof Panel & 16 ga. Purlin, max 60" oc. | Approved Insulation & Approved Flute Filler Insulation            | 1 per 6.4 sq. ft. (5 per 4' x 8') | Min. IB SD #12, 3" IB Insulation Plate | IB #12 Purlin Fastener, IB 2-3/8" Barbed Seam Plate | In-Seam @ 12" oc. x 60"   |
| Metal Roof Panel & 16 ga. Purlin, max 60" oc. | Approved Insulation & Approved Flute Filler Insulation            | 1 per 6.4 sq. ft. (5 per 4' x 8') | Min. IB SD #12, 3" IB Insulation Plate | IB #12 Purlin Fastener, IB 2-3/8" Barbed Seam Plate | In-Seam @ 6" oc. x 60"    |

<sup>1</sup>Existing Roof: Metal Standing Seam or lapped seam Metal Panel Roof, having a min. 16 gauge, 50 ksi steel purlin  
<sup>2</sup>Approved Flute Filler: IB Energy Board II or III, or IB Approved UL Classified Polyisocyanurate, IB Approved UL Classified Expanded Polystyrene, IB Approved UL Classified Extruded Polystyrene Insulation  
<sup>3</sup>Approved Insulation: IB Energy Board II or III, or IB Approved UL Classified Polyisocyanurate  
<sup>4</sup>The use of some IB Approved Flute Filler Insulations and polyisocyanurate insulations and/or combinations thereof may not achieve UL Classification.  
System Uplift Note(s): \*Refer to applicable Approval Guide for System Code and/or FM Approvals Information.  
\*\*Refer to Substrate Resistance Table for required pull-out values. \*\*\*Contact IB Technical Services for maximum sheet width allowed relative to in-seam fastening pattern.

For additional information about IB Roof Systems requirements, recommendations, installation details, approvals, and limitations for the above assemblies, please refer to the latest edition of the IB Roof Systems Specifications Manual. For Technical Services please contact IB Technical Department at 800-426-1626.

| Membranes:        | Membrane Color:       | Warranty Length <sup>**</sup> | Warranty Type <sup>**</sup>  |
|-------------------|-----------------------|-------------------------------|--|
| IB TPO SM 60 Mil  | White*<br>Gray<br>Tan | 10 Year<br>15 Year<br>20 Year | Contractor Warranty Only<br>Total Systems - No Dollar Limit (TSW)<br>Warranty Plus (WP)<br>Commercial Limited Material Warranty (CLMW)<br>Residential Limited Material Warranty (RLMW) |
| IB TPO SM 80 Mil  | White*<br>Gray<br>Tan | 15 Year<br>20 Year<br>25 Year |  |
| IB TPO FB 115 Mil | White*                | 10 Year<br>15 Year<br>20 Year |  |
| IB TPO FB 135 Mil | White*                | 15 Year<br>20 Year<br>25 Year |  |

\*Meets CRRC, Title 24, LEED (SRI)

\*\*Refer to Warranty Selection Guide for Warranty Riders, Term Length Limitations, and eligibility requirements of the IB Warranty Program

|               |               |
|---------------|---------------|
| Submitted By: | Project Name: |
| Company Name: | Address:      |
| Email/Phone:  | City/State:   |