

Mechanically Attached TPO Membrane - Insulation - Flute Filler - Existing Metal Roof - Purlin Fastened (Recover)

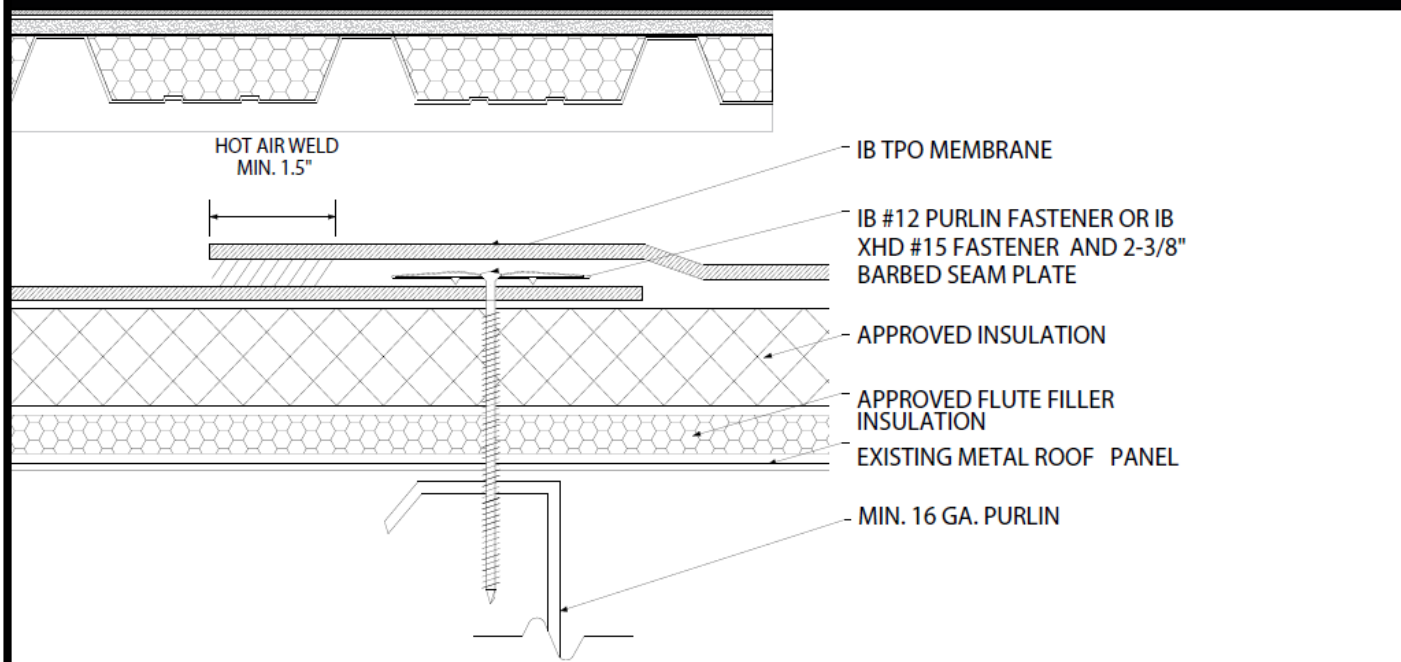

Deck Type ¹	Insulation / Flute Filler (over Existing Metal Roof) ¹			IB Membrane Securement [*]	
	Type ^{2,3,4}	Attachment	Fastener/Plate	Fastener/Plate ^{**}	Attachment ^{***}
Metal Roof Panel & 16 ga. Purlin, max 48" oc.	Approved Insulation & Approved Flute Filler Insulation	1 per 6.4 sq. ft. (5 per 4' x 8')	Min. IB SD #12, 3" IB Insulation Plate	IB #12 Purlin Fastener, IB 2-3/8" Barbed Seam Plate	In-Seam @ 12" oc. x 48"
Metal Roof Panel & 16 ga. Purlin, max 48" oc.	Approved Insulation & Approved Flute Filler Insulation	1 per 6.4 sq. ft. (5 per 4' x 8')	Min. IB SD #12, 3" IB Insulation Plate	IB #12 Purlin Fastener, IB 2-3/8" Barbed Seam Plate	In-Seam @ 6" oc. x 48"
Metal Roof Panel & 16 ga. Purlin, max 60" oc.	Approved Insulation & Approved Flute Filler Insulation	1 per 6.4 sq. ft. (5 per 4' x 8')	Min. IB SD #12, 3" IB Insulation Plate	IB #12 Purlin Fastener, IB 2-3/8" Barbed Seam Plate	In-Seam @ 12" oc. x 60"
Metal Roof Panel & 16 ga. Purlin, max 60" oc.	Approved Insulation & Approved Flute Filler Insulation	1 per 6.4 sq. ft. (5 per 4' x 8')	Min. IB SD #12, 3" IB Insulation Plate	IB #12 Purlin Fastener, IB 2-3/8" Barbed Seam Plate	In-Seam @ 6" oc. x 60"

¹Existing Roof: Metal Standing Seam or lapped seam Metal Panel Roof, having a min. 16 gauge, 50 ksi steel purlin
²Approved Flute Filler: IB Energy Board II or III, or IB Approved UL Classified Polyisocyanurate, IB Approved UL Classified Expanded Polystyrene, IB Approved UL Classified Extruded Polystyrene Insulation
³Approved Insulation: IB Energy Board II or III, or IB Approved UL Classified Polyisocyanurate
⁴The use of some IB Approved Flute Filler Insulations and polyisocyanurate insulations and/or combinations thereof may not achieve UL Classification.
System Uplift Note(s): *Refer to applicable Approval Guide for System Code and/or FM Approvals Information.
Refer to Substrate Resistance Table for required pull-out values. *Contact IB Technical Services for maximum sheet width allowed relative to in-seam fastening pattern.

For additional information about IB Roof Systems requirements, recommendations, installation details, approvals, and limitations for the above assemblies, please refer to the latest edition of the IB Roof Systems Specifications Manual. For Technical Services please contact IB Technical Department at 800-426-1626.

Membranes:	Membrane Color:	Warranty Length ^{**}	Warranty Type ^{**}
IB TPO SM 60 Mil	White* Gray Tan	10 Year 15 Year 20 Year	Contractor Warranty Only Total Systems - No Dollar Limit (TSW) Warranty Plus (WP) Commercial Limited Material Warranty (CLMW) Residential Limited Material Warranty (RLMW)
IB TPO SM 80 Mil	White* Gray Tan	15 Year 20 Year 25 Year	
IB TPO FB 115 Mil	White*	10 Year 15 Year 20 Year	
IB TPO FB 135 Mil	White*	15 Year 20 Year 25 Year	

*Meets CRRC, Title 24, LEED (SRI)

**Refer to Warranty Selection Guide for Warranty Riders, Term Length Limitations, and eligibility requirements of the IB Warranty Program

Submitted By:	Project Name:
Company Name:	Address:
Email/Phone:	City/State: