

## Mechanically Attached TPO Membrane - Insulation - Vapor Barrier - Steel Deck (New or Tear-Off)

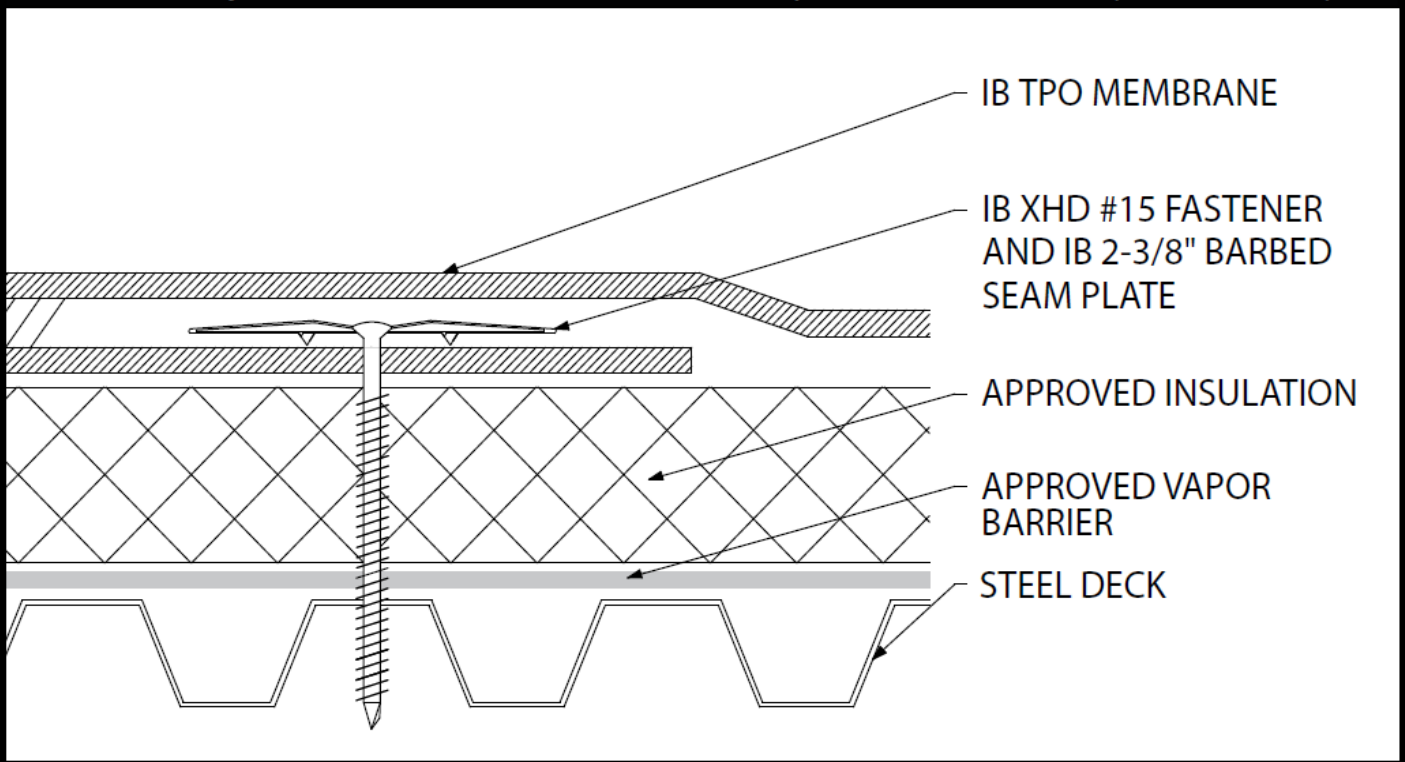

Deck Type	Insulation (over Vapor Barrier)			IB Membrane Securement**	
	Type <sup>1,2,3</sup>	Attachment	Fastener/Plate	Fastener/Plate***	Attachment
Min. 24 ga. Type B Steel	Approved Insulation & Approved Vapor Barrier	1 per 6.4 Sq. Ft. (5 per 4' x 8')	Min. IB SD #12, 3" IB Insulation Plate	IB HD #14 or XHD #15, IB 2-3/8" Barbed Seam Plate	In-Seam @ 6" oc. x 90" max width
Min. 24 ga. Type B Steel	Approved Insulation & Approved Vapor Barrier	1 per 6.4 Sq. Ft. (5 per 4' x 8')	Min. IB SD #12, 3" IB Insulation Plate	IB HD #14 or XHD #15, IB 2-3/8" Barbed Seam Plate	In-Seam @ 12" oc. x 90" max width
Min. 22 ga. Type B Grade 33 Steel	Approved Insulation & Approved Vapor Barrier	1 per 6.4 Sq. Ft. (5 per 4' x 8')	Min. IB SD #12, 3" IB Insulation Plate	IB HD #14 or XHD #15, IB 2-3/8" Barbed Seam Plate	In-Seam @ 6" oc. x 90" max width
Min. 22 ga. Type B Grade 33 Steel	Approved Insulation & Approved Vapor Barrier	1 per 6.4 Sq. Ft. (5 per 4' x 8')	Min. IB SD #12, 3" IB Insulation Plate	IB XHD #15, IB 2-3/8" Barbed Seam Plate	In-Seam @ 12" oc. x 66" max width
Min. 22 ga. Type B Grade 80 Steel	Approved Insulation & Approved Vapor Barrier	1 per 6.4 Sq. Ft. (5 per 4' x 8')	Min. IB SD #12, 3" IB Insulation Plate	IB XHD #15, IB 2-3/8" Barbed Seam Plate	In-Seam @ 6" oc. x 90" max width
Min. 22 ga. Type B Grade 80 Steel	Approved Insulation & Approved Vapor Barrier	1 per 6.4 Sq. Ft. (5 per 4' x 8')	Min. IB SD #12, 3" IB Insulation Plate	IB XHD #15, IB 2-3/8" Barbed Seam Plate	In-Seam @ 12" oc. x 66" max width

<sup>1</sup>Approved Vapor Barrier: IBarrier SA Membrane, IBarrier SA 106, IBarrier FG SAR, IBarrier XP SA Membrane, applied using self-adhesive techniques  
<sup>2</sup>Approved Insulation: IB Energy Board II or III, IB HD ISO, or IB Approved UL Classified polyisocyanurate.  
<sup>3</sup>The use of some IB Approved Insulations and/or vapor barrier combinations may not achieve UL Classification.  
**System Uplift Note(s): \*Refer to applicable Approval Guide for System Code and/or FM Approvals Information.**  
**\*\*Refer to Substrate Resistance Table for required pull-out values. \*\*\*Contact IB Technical Services for maximum sheet width allowed relative to in-seam fastening pattern.**  
 For additional information about IB Roof Systems requirements, recommendations, installation details, approvals, and limitations for the above assemblies, please refer to the latest edition of the IB Roof Systems Specifications Manual. For Technical Services please contact IB Technical Department at 800-426-1626.

Membranes:	Membrane Color:	Warranty Length**	Warranty Type**
IB TPO SM 60 Mil	White* Gray Tan	10 Year 15 Year 20 Year	Contractor Warranty Only Total Systems - No Dollar Limit (TSW) Warranty Plus (WP) Commercial Limited Material Warranty (CLMW) Residential Limited Material Warranty (RLMW)
IB TPO SM 80 Mil	White* Gray Tan	15 Year 20 Year 25 Year	
IB TPO FB 115 Mil	White*	10 Year 15 Year 20 Year	
IB TPO FB 135 Mil	White*	15 Year 20 Year 25 Year	

\*Meets CRRC, Title 24, LEED (SR)

\*\*Refer to Warranty Selection Guide for Warranty Riders, Term Length Limitations, and eligibility requirements of the IB Warranty Program

Submitted By:	Project Name:
Company Name:	Address:
Email/Phone:	City/State: