

Mechanically Attached TPO Membrane - Separation Sheet - Existing Roof - Wood Deck (Recover)

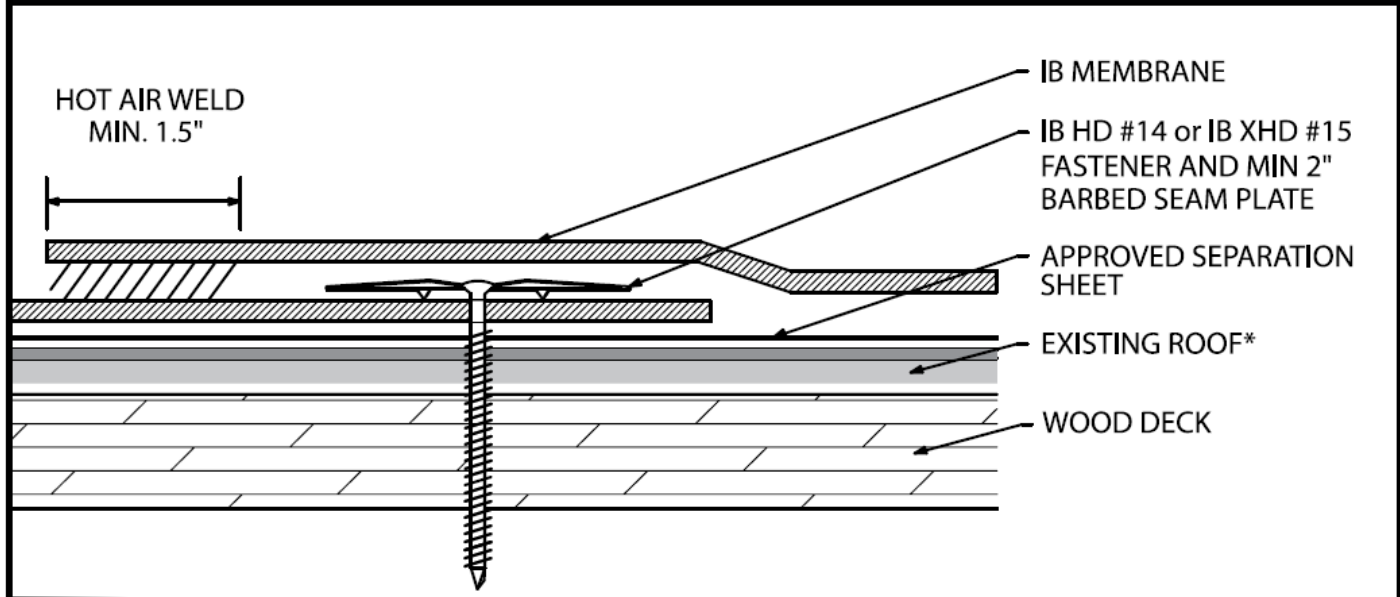

Deck Type	Separation Sheet (over Existing Roof) ¹			IB Membrane Securement [*]	
	Type ^{2,3}	Attachment	Fastener/Plate	Fastener/Plate ^{**}	Attachment ^{***}
Min. 7/16" OSB	Approved IB Separation Sheet	(Preliminarily Attached)	Min. IB SD #12, 3" IB Insulation Plate	IB HD #14 or XHD #15, IB 2-3/8" Barbed Seam Plate	In-Seam @ 6" oc. x 90" max width
Min. 5/8" OSB	Approved IB Separation Sheet	(Preliminarily Attached)	Min. IB SD #12, 3" IB Insulation Plate	IB HD #14 or XHD #15, IB 2-3/8" Barbed Seam Plate	In-Seam @ 12" oc. x 90" max width
Min. 1/2" Plywood	Approved IB Separation Sheet	(Preliminarily Attached)	Min. IB SD #12, 3" IB Insulation Plate	IB HD #14 or XHD #15, IB 2-3/8" Barbed Seam Plate	In-Seam @ 6" oc. x 90" max width
Min. 1/2" Plywood	Approved IB Separation Sheet	(Preliminarily Attached)	Min. IB SD #12, 3" IB Insulation Plate	IB XHD #15, IB 2-3/8" Barbed Seam Plate	In-Seam @ 12" oc. x 66" max width
Min. 19/32" Plywood	Approved IB Separation Sheet	(Preliminarily Attached)	Min. IB SD #12, 3" IB Insulation Plate	IB XHD #15, IB 2-3/8" Barbed Seam Plate	In-Seam @ 6" oc. x 90" max width
Min. 19/32" Plywood	Approved IB Separation Sheet	(Preliminarily Attached)	Min. IB SD #12, 3" IB Insulation Plate	IB XHD #15, IB 2-3/8" Barbed Seam Plate	In-Seam @ 12" oc. x 66" max width
Min. 3/4" Plywood	Approved IB Separation Sheet	(Preliminarily Attached)	Min. IB SD #12, 3" IB Insulation Plate	IB XHD #15, IB 2-3/8" Barbed Seam Plate	In-Seam @ 12" oc. x 90" max width
Min. 1" Wood Plank	Approved IB Separation Sheet	(Preliminarily Attached)	Min. IB SD #12, 3" IB Insulation Plate	IB XHD #15, IB 2-3/8" Barbed Seam Plate	In-Seam @ 12" oc. x 90" max width

¹Existing Roof: APP or SBS modified bitumen, smooth or granule surfaced asphaltic built-up roof, or single-ply membrane (CPA, CSPE, EPDM, PVC, or TPO)
²Approved Separation Sheet: IB Separator Sheet, IB Poly Separator Sheet, IB HD Poly Separator Sheet, or Atlas Fire Sheet 10
³The use of some IB Approved Separation Sheets may not achieve UL Classification.
 System Uplift Note(s): *Refer to applicable Approval Guide for System Code and/or FM Approvals Information.
^{**}Refer to Substrate Resistance Table for required pull-out values. ^{***}Contact IB Technical Services for maximum sheet width allowed relative to in-seam fastening pattern.
 For additional information about IB Roof Systems requirements, recommendations, installation details, approvals, and limitations for the above assemblies, please refer to the latest edition of the IB Roof Systems Specifications Manual. For Technical Services please contact IB Technical Department at 800-426-1626.

Membranes:		Membrane Color:			Warranty Length ^{**}			Warranty Type ^{**}	
IB TPO SM 60 Mil	White*	Gray	Tan	10 Year	15 Year	20 Year	Contractor Warranty Only		
IB TPO SM 80 Mil	White*	Gray	Tan	10 Year	15 Year	20 Year	Total Systems - No Dollar Limit (TSW)		
IB TPO FB 115 Mil	White*			10 Year	15 Year	20 Year	Warranty Plus (WP)		
IB TPO FB 135 Mil	White*			10 Year	15 Year	20 Year	Commercial Limited Material Warranty (CLMW)		
								Residential Limited Material Warranty (RLMW)	
[*] Meets CRRC, Title 24, LEED (SRI)				^{**} Refer to Warranty Selection Guide for Warranty Riders, Term Length Limitations, and eligibility requirements of the IB Warranty Program					
Submitted By:		Project Name:							
Company Name:		Address:							
Email/Phone:		City/State:							

Mechanically Attached TPO Membrane - Cover Board - Existing Roof - Wood Deck (Recover)

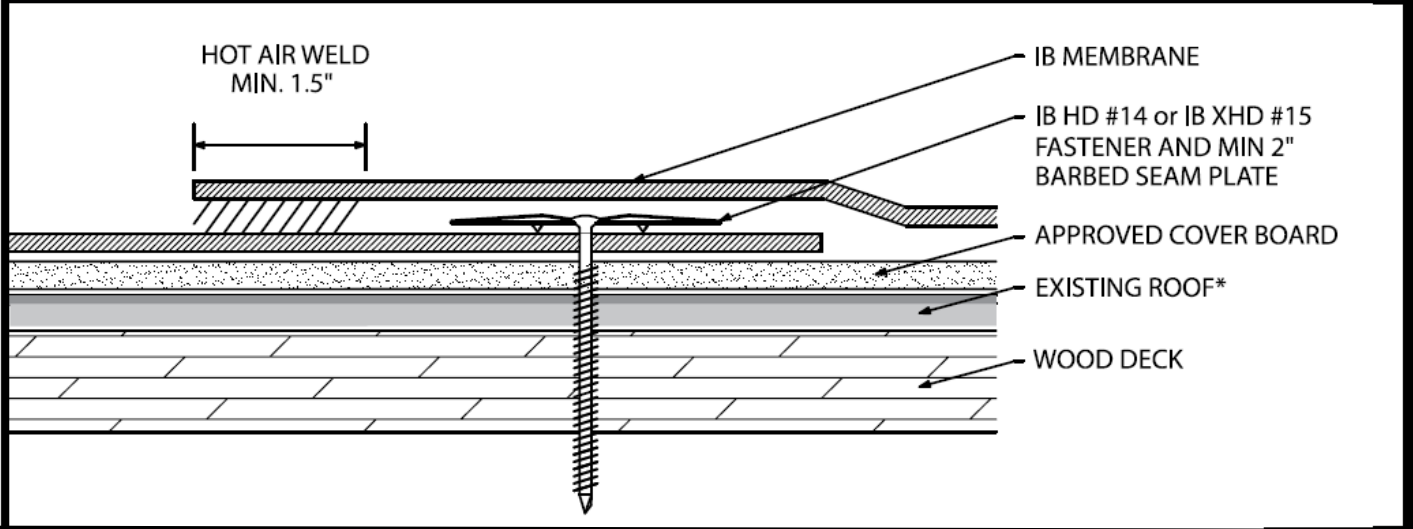

Deck Type	Cover Board (over Existing Roof) ¹			IB Membrane Securement [*]	
	Type ^{2,3}	Attachment	Fastener/Plate	Fastener/Plate ^{**}	Attachment ^{***}
Min. 7/16" OSB	Approved Cover Board	1 per 6.4 Sq. Ft. (5 per 4' x 8')	Min. IB SD #12, 3" IB Insulation Plate	IB HD #14 or XHD #15, IB 2-3/8" Barbed Seam Plate	In-Seam @ 6" oc. x 90" max width
Min. 5/8" OSB	Approved Cover Board	1 per 6.4 Sq. Ft. (5 per 4' x 8')	Min. IB SD #12, 3" IB Insulation Plate	IB HD #14 or XHD #15, IB 2-3/8" Barbed Seam Plate	In-Seam @ 12" oc. x 90" max width
Min. 1/2" Plywood	Approved Cover Board	1 per 6.4 Sq. Ft. (5 per 4' x 8')	Min. IB SD #12, 3" IB Insulation Plate	IB HD #14 or XHD #15, IB 2-3/8" Barbed Seam Plate	In-Seam @ 6" oc. x 90" max width
Min. 1/2" Plywood	Approved Cover Board	1 per 6.4 Sq. Ft. (5 per 4' x 8')	Min. IB SD #12, 3" IB Insulation Plate	IB XHD #15, IB 2-3/8" Barbed Seam Plate	In-Seam @ 12" oc. x 66" max width
Min. 19/32" Plywood	Approved Cover Board	1 per 6.4 Sq. Ft. (5 per 4' x 8')	Min. IB SD #12, 3" IB Insulation Plate	IB XHD #15, IB 2-3/8" Barbed Seam Plate	In-Seam @ 6" oc. x 90" max width
Min. 19/32" Plywood	Approved Cover Board	1 per 6.4 Sq. Ft. (5 per 4' x 8')	Min. IB SD #12, 3" IB Insulation Plate	IB XHD #15, IB 2-3/8" Barbed Seam Plate	In-Seam @ 12" oc. x 66" max width
Min. 3/4" Plywood	Approved Cover Board	1 per 6.4 Sq. Ft. (5 per 4' x 8')	Min. IB SD #12, 3" IB Insulation Plate	IB XHD #15, IB 2-3/8" Barbed Seam Plate	In-Seam @ 12" oc. x 90" max width
Min. 1" Wood Plank	Approved Cover Board	1 per 6.4 Sq. Ft. (5 per 4' x 8')	Min. IB SD #12, 3" IB Insulation Plate	IB XHD #15, IB 2-3/8" Barbed Seam Plate	In-Seam @ 12" oc. x 90" max width

¹Existing Roof: APP or SBS modified bitumen, smooth or granule surfaced asphaltic built-up roof, or single-ply membrane (CPA, CSPE, EPDM, PVC, or TPO)

²Approved Cover Board: DensDeck, DensDeck Prime, DensDeck StormX Prime, Securock UltraLight Glass-Mat, Securock UltraLight Coated Glass-Mat, Securock Gypsum Fiber Board, DEXcell Glass-Mat Roof Board, or DEXcell FA Glass Mat Roof Board, minimum 1/4" thickness; or minimum 7/16" DEXcell Cement Roof Board; or minimum 1/2" IB HD ISO-J, or 1/2" IB Recovery Energy Board III-J.

³The use of some IB Approved Cover Boards may not achieve UL Classification.

System Uplift Note(s): *Refer to applicable Approval Guide for System Code and/or FM Approvals Information.

Refer to Substrate Resistance Table for required pull-out values. *Contact IB Technical Services for maximum sheet width allowed relative to in-seam fastening pattern.

For additional information about IB Roof Systems requirements, recommendations, installation details, approvals, and limitations for the above assemblies, please refer to the latest edition of the IB Roof Systems Specifications Manual. For Technical Services please contact IB Technical Department at 800-426-1626.

Membranes:		Membrane Color:			Warranty Length ^{**}			Warranty Type ^{**}	
IB TPO SM 60 Mil	White*	Gray	Tan	10 Year	15 Year	20 Year	Contractor Warranty Only		
IB TPO SM 80 Mil	White*	Gray	Tan	10 Year	15 Year	20 Year	Total Systems - No Dollar Limit (TSW)		
IB TPO FB 115 Mil	White*			10 Year	15 Year	20 Year	Warranty Plus (WP)		
IB TPO FB 135 Mil	White*			10 Year	15 Year	20 Year	Commercial Limited Material Warranty (CLMW)		
							Residential Limited Material Warranty (RLMW)		

*Meets CRRC, Title 24, LEED (SRI)

**Refer to Warranty Selection Guide for Warranty Riders, Term Length Limitations, and eligibility requirements of the IB Warranty Program

Submitted By:		Project Name:	
Company Name:		Address:	
Email/Phone:		City/State:	

Mechanically Attached TPO Membrane - Cover Board - Insulation - Existing Roof - Wood Deck (Recover)

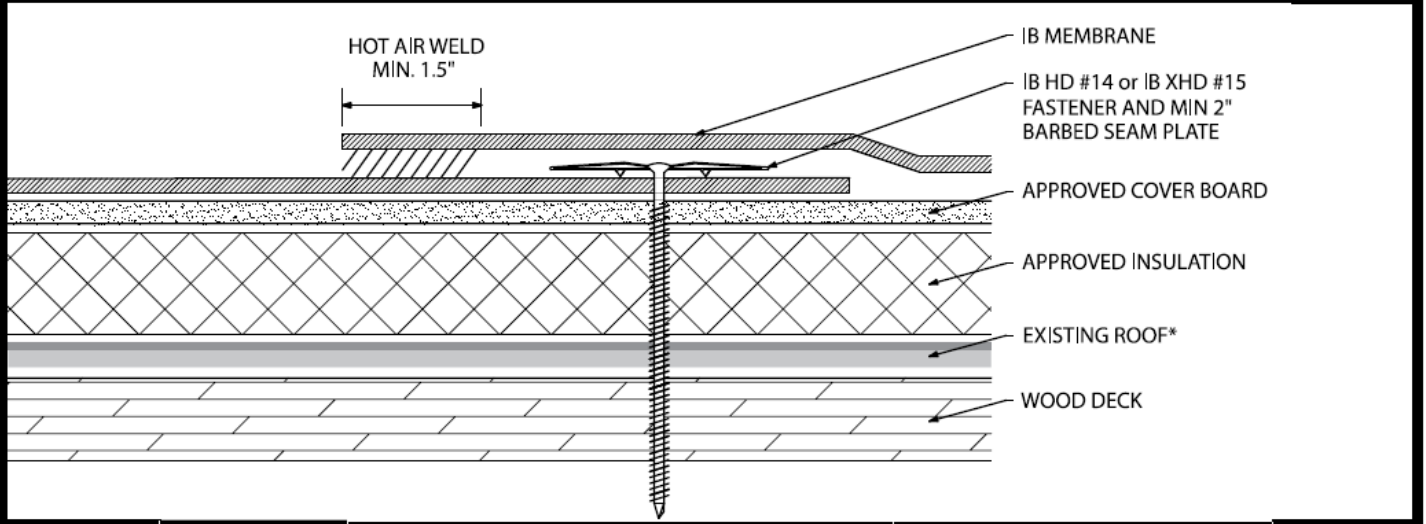

Deck Type	Insulation / Cover Board (over Existing Roof) ¹			IB Membrane Securement [*]	
	Type ^{2,3,4}	Attachment	Fastener/Plate	Fastener/Plate ^{**}	Attachment ^{***}
Min. 7/16\"/>					

¹Existing Roof: APP or SBS modified bitumen, smooth or granule surfaced asphaltic built-up roof, or single-ply membrane (CPA, CSPE, EPDM, PVC, or TPO)
²Approved Insulation: IB EnergyBoard II or III, or IB Approved UL Classified Polyisocyanurate, IB Approved UL Classified Expanded Polystyrene, IB Approved UL Classified Extruded Polystyrene Insulation
³Approved Cover Board: DensDeck, DensDeck Prime, DensDeck StormX Prime, Securock Ultralight Glass-Mat, Securock Ultralight Coated Glass-Mat, Securock Gypsum Fiber Board, DEXcell Glass-Mat Roof Board, or DEXcell FA Glass Mat Roof Board, minimum 1/4\"/>

Membranes:	Membrane Color:	Warranty Length ^{***}			Warranty Type ^{***}
IB TPO SM 60 Mil	White* Gray Tan	10 Year	15 Year	20 Year	Contractor Warranty Only
IB TPO SM 80 Mil	White* Gray Tan	10 Year	15 Year	20 Year	Total Systems - No Dollar Limit (TSW)
IB TPO FB 115 Mil	White*	10 Year	15 Year	20 Year	Warranty Plus (WP)
IB TPO FB 135 Mil	White*	10 Year	15 Year	20 Year	Commercial Limited Material Warranty (CLMW) Residential Limited Material Warranty (RLMW)

^{*}Meets CRRC, Title 24, LEED (SRI)

^{**}Refer to Warranty Selection Guide for Warranty Riders, Term Length Limitations, and eligibility requirements of the IB Warranty Program

Submitted By:	Project Name:
Company Name:	Address:
Email/Phone:	City/State:

Mechanically Attached TPO Membrane - Fan-Fold - Existing Roof - Wood Deck (Recover)

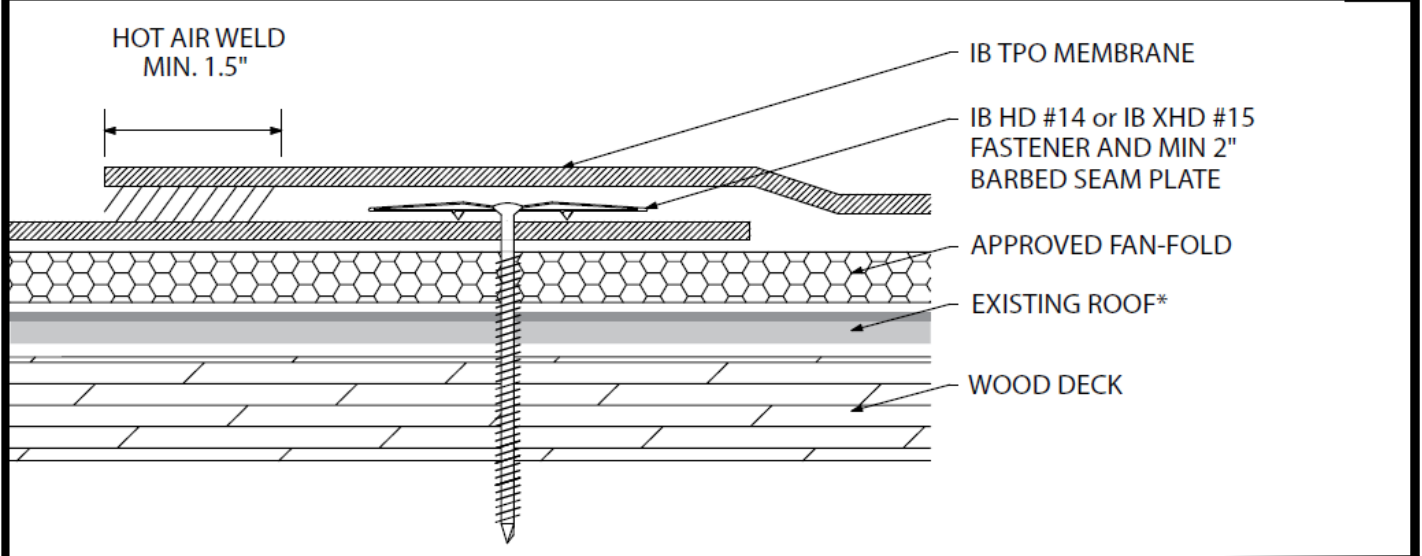

Deck Type	Fan-Fold (over Existing Roof) ¹			IB Membrane Securement [*]	
	Type ^{2,3}	Attachment	Fastener/Plate	Fastener/Plate ^{**}	Attachment ^{***}
Min. 7/16" OSB	Approved Fanfold Insulation	1 per 12 sq. ft.	Min. IB SD #12, 3" IB Insulation Plate	IB HD #14 or XHD #15, IB 2-3/8" Barbed Seam Plate	In-Seam @ 6" oc. x 90" max width
Min. 5/8" OSB	Approved Fanfold Insulation	1 per 12 sq. ft.	Min. IB SD #12, 3" IB Insulation Plate	IB HD #14 or XHD #15, IB 2-3/8" Barbed Seam Plate	In-Seam @ 12" oc. x 90" max width
Min. 1/2" Plywood	Approved Fanfold Insulation	1 per 12 sq. ft.	Min. IB SD #12, 3" IB Insulation Plate	IB HD #14 or XHD #15, IB 2-3/8" Barbed Seam Plate	In-Seam @ 6" oc. x 90" max width
Min. 1/2" Plywood	Approved Fanfold Insulation	1 per 12 sq. ft.	Min. IB SD #12, 3" IB Insulation Plate	IB XHD #15, IB 2-3/8" Barbed Seam Plate	In-Seam @ 12" oc. x 66" max width
Min. 19/32" Plywood	Approved Fanfold Insulation	1 per 12 sq. ft.	Min. IB SD #12, 3" IB Insulation Plate	IB XHD #15, IB 2-3/8" Barbed Seam Plate	In-Seam @ 6" oc. x 90" max width
Min. 19/32" Plywood	Approved Fanfold Insulation	1 per 12 sq. ft.	Min. IB SD #12, 3" IB Insulation Plate	IB XHD #15, IB 2-3/8" Barbed Seam Plate	In-Seam @ 12" oc. x 66" max width
Min. 3/4" Plywood	Approved Fanfold Insulation	1 per 12 sq. ft.	Min. IB SD #12, 3" IB Insulation Plate	IB XHD #15, IB 2-3/8" Barbed Seam Plate	In-Seam @ 12" oc. x 90" max width
Min. 1" Wood Plank	Approved Fanfold Insulation	1 per 12 sq. ft.	Min. IB SD #12, 3" IB Insulation Plate	IB XHD #15, IB 2-3/8" Barbed Seam Plate	In-Seam @ 12" oc. x 90" max width

¹Existing Roof: APP or SBS modified bitumen, smooth or granule surfaced asphaltic built-up roof, or single-ply membrane (CPA, CSPE, EPDM, PVC, or TPO).

²Approved EPS Fan-Fold Insulation: IB supplied EPS Fanfold Insulation, minimum 1.5 density or IB supplied GreenGuard PB6, PB6HD, or PB6W Roofing Cover Board

³The use of some IB Supplied/ Approved EPS/XPS Fanfold insulations may not achieve UL Classification.

System Uplift Note(s): *Refer to applicable Approval Guide for System Code and/or FM Approvals Information.

Refer to Substrate Resistance Table for required pull-out values. *Contact IB Technical Services for maximum sheet width allowed relative to in-seam fastening pattern.

For additional information about IB Roof Systems requirements, recommendations, installation details, approvals, and limitations for the above assemblies, please refer to the latest edition of the IB Roof Systems Specifications Manual. For Technical Services please contact IB Technical Department at 800-426-1626.

Membranes:		Membrane Color:			Warranty Length ^{**}			Warranty Type ^{**}	
IB TPO SM 60 Mil	White*	Gray		Tan	10 Year	15 Year	20 Year	Contractor Warranty Only	
IB TPO SM 80 Mil	White*	Gray		Tan	10 Year	15 Year	20 Year	Total Systems - No Dollar Limit (TSW)	
IB TPO FB 115 Mil	White*				10 Year	15 Year	20 Year	Warranty Plus (WP)	
IB TPO FB 135 Mil	White*				10 Year	15 Year	20 Year	Commercial Limited Material Warranty (CLMW)	
								Residential Limited Material Warranty (RLMW)	

*Meets CRRC, Title 24, LEED (SRI)

**Refer to Warranty Selection Guide for Warranty Riders, Term Length Limitations, and eligibility requirements of the IB Warranty Program

Submitted By:		Project Name:	
Company Name:		Address:	
Email/Phone:		City/State:	

Mechanically Attached TPO Membrane - Insulation - Existing Roof - Wood Deck (Recover)

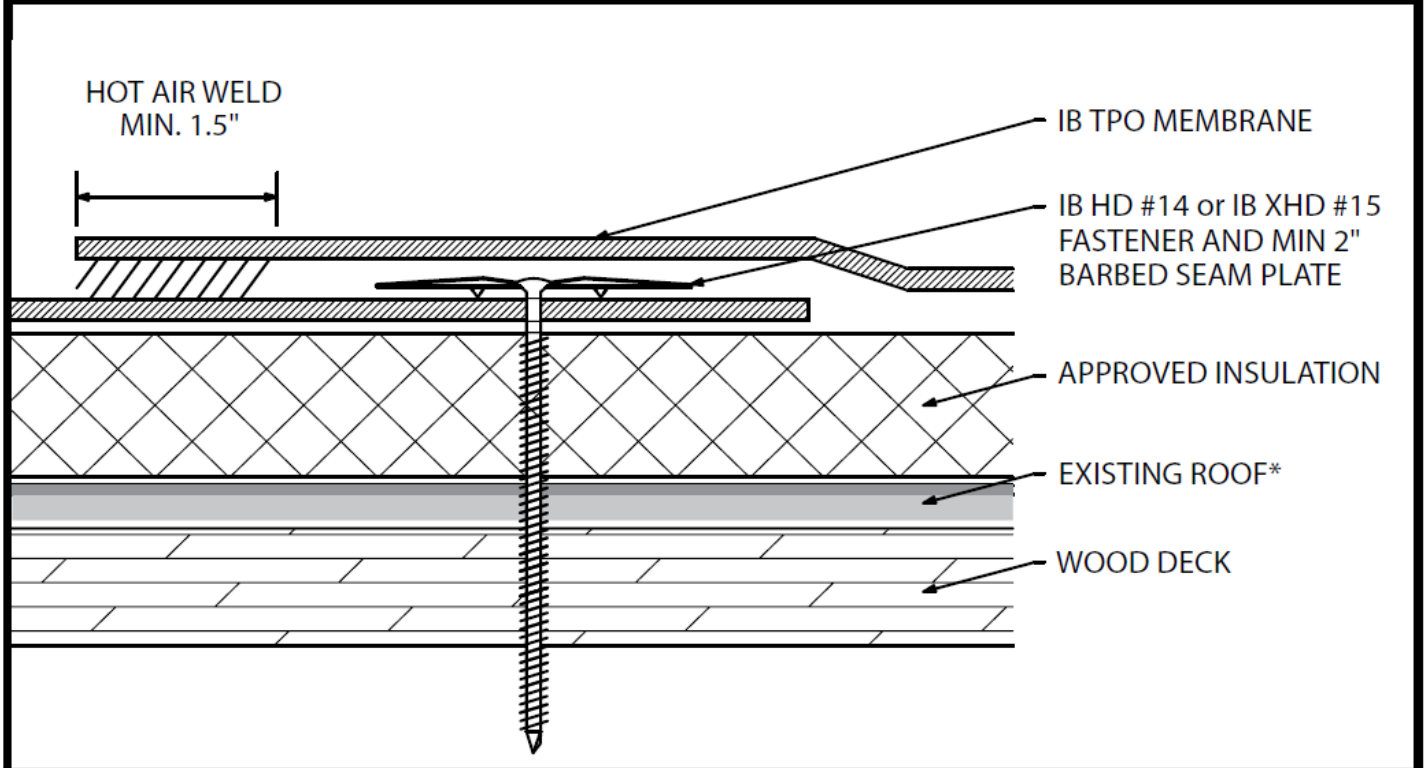

Deck Type	Insulation (over Existing Roof) ¹			IB Membrane Securement [*]	
	Type ^{2,3}	Attachment	Fastener/Plate	Fastener/Plate ^{**}	Attachment ^{***}
Min. 7/16\" OSB	Approved Insulation	1 per 6.4 Sq. Ft. (5 per 4' x 8')	Min. IB SD #12, 3\" IB Insulation Plate	IB HD #14 or XHD #15, IB 2-3/8\" Barbed Seam Plate	In-Seam @ 6\" oc. x 90\" max width
Min. 5/8\" OSB	Approved Insulation	1 per 6.4 Sq. Ft. (5 per 4' x 8')	Min. IB SD #12, 3\" IB Insulation Plate	IB HD #14 or XHD #15, IB 2-3/8\" Barbed Seam Plate	In-Seam @ 12\" oc. x 90\" max width
Min. 1/2\" Plywood	Approved Insulation	1 per 6.4 Sq. Ft. (5 per 4' x 8')	Min. IB SD #12, 3\" IB Insulation Plate	IB HD #14 or XHD #15, IB 2-3/8\" Barbed Seam Plate	In-Seam @ 6\" oc. x 90\" max width
Min. 1/2\" Plywood	Approved Insulation	1 per 6.4 Sq. Ft. (5 per 4' x 8')	Min. IB SD #12, 3\" IB Insulation Plate	IB XHD #15, IB 2-3/8\" Barbed Seam Plate	In-Seam @ 12\" oc. x 66\" max width
Min. 19/32\" Plywood	Approved Insulation	1 per 6.4 Sq. Ft. (5 per 4' x 8')	Min. IB SD #12, 3\" IB Insulation Plate	IB XHD #15, IB 2-3/8\" Barbed Seam Plate	In-Seam @ 6\" oc. x 90\" max width
Min. 19/32\" Plywood	Approved Insulation	1 per 6.4 Sq. Ft. (5 per 4' x 8')	Min. IB SD #12, 3\" IB Insulation Plate	IB XHD #15, IB 2-3/8\" Barbed Seam Plate	In-Seam @ 12\" oc. x 66\" max width
Min. 3/4\" Plywood	Approved Insulation	1 per 6.4 Sq. Ft. (5 per 4' x 8')	Min. IB SD #12, 3\" IB Insulation Plate	IB XHD #15, IB 2-3/8\" Barbed Seam Plate	In-Seam @ 12\" oc. x 90\" max width
Min. 1\" Wood Plank	Approved Insulation	1 per 6.4 Sq. Ft. (5 per 4' x 8')	Min. IB SD #12, 3\" IB Insulation Plate	IB XHD #15, IB 2-3/8\" Barbed Seam Plate	In-Seam @ 12\" oc. x 90\" max width

¹Existing Roof: APP or SBS modified bitumen, smooth, granule or gravel surfaced asphaltic built-up roof, or Single-Ply (CPA, CSPE, EPDM, PVC or TPO)

²Approved Insulation: IB Energy Board II or III, or IB Approved UL Classified Polyisocyanurate

³The use of some IB Approved Insulations may not achieve UL Classification.

System Uplift Note(s): *Refer to applicable Approval Guide for System Code and/or FM Approvals Information.

Refer to Substrate Resistance Table for required pull-out values. *Contact IB Technical Services for maximum sheet width allowed relative to in-seam fastening pattern.

For additional information about IB Roof Systems requirements, recommendations, installation details, approvals, and limitations for the above assemblies, please refer to the latest edition of the IB Roof Systems Specifications Manual. For Technical Services please contact IB Technical Department at 800-426-1626.

Membranes:		Membrane Color:			Warranty Length ^{**}			Warranty Type ^{**}	
IB TPO SM 60 Mil	White*	Gray		Tan	10 Year	15 Year	20 Year	Contractor Warranty Only	
IB TPO SM 80 Mil	White*	Gray		Tan	10 Year	15 Year	20 Year	Total Systems - No Dollar Limit (TSW)	
IB TPO FB 115 Mil	White*				10 Year	15 Year	20 Year	Warranty Plus (WP)	
IB TPO FB 135 Mil	White*				10 Year	15 Year	20 Year	Commercial Limited Material Warranty (CLMW)	
					Residential Limited Material Warranty (RLMW)				

*Meets CRRC, Title 24, LEED (SRI)

**Refer to Warranty Selection Guide for Warranty Riders, Term Length Limitations, and eligibility requirements of the IB Warranty Program

Submitted By:		Project Name:	
Company Name:		Address:	
Email/Phone:		City/State:	