

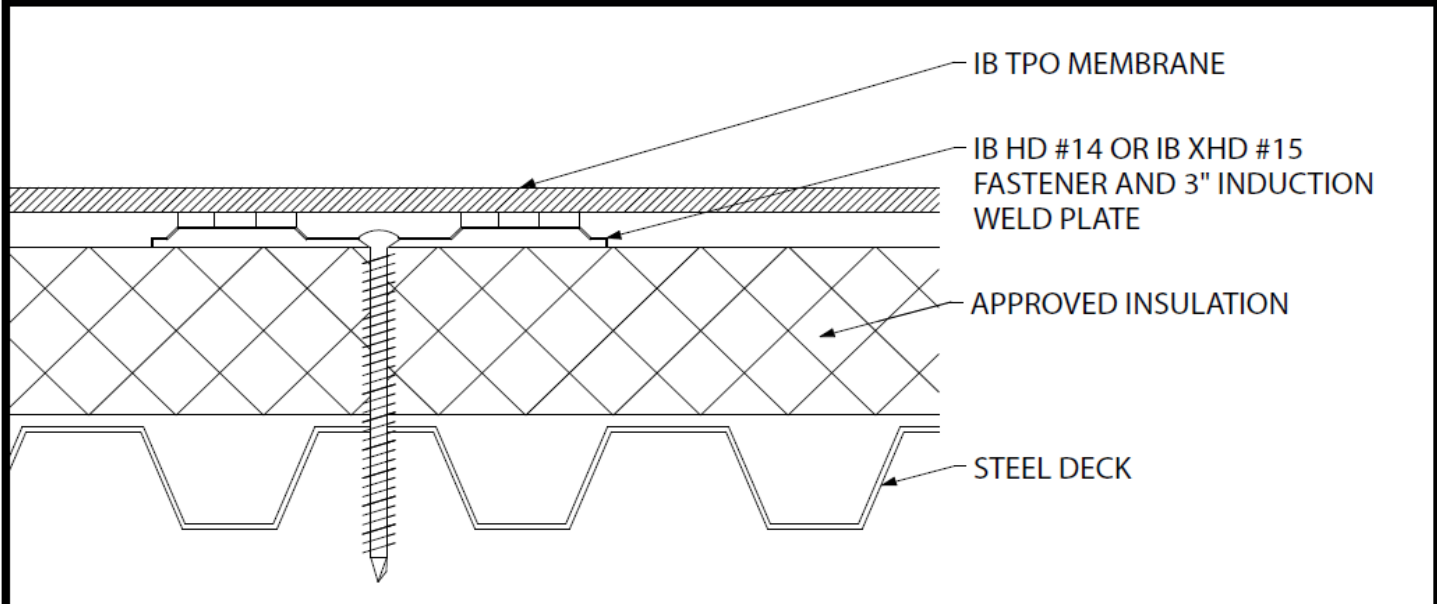

Induction Welded TPO Membrane - Insulation - Steel Deck (New or Tear Off)



Deck Type	Insulation Type ^{1,2}	Insulation Securement			IB Membrane Securement** Attachment***
		Insulation Attachment	TPO Induction Plate	Density	
Min. 22 ga. Type B, Grade 33 Steel	Approved Insulation	IB XHD #15 Roofing Fastener	Rhinobond TPO Plate	1 per 5.33 sq. ft. (6 per 4' x 8')	Plate bonded
Min. 22 ga. Type B, Grade 33 Steel	Approved Insulation	IB XHD #15 Roofing Fastener	Rhinobond TPO Plate or isoweld TPO Plate	1 per 4 sq. ft. (8 per 4' x 8')	Plate bonded
Min. 22 ga. Type B, Grade 33 Steel	Approved Insulation	IB XHD #15 Roofing Fastener	isoweld TPO Plate	1 per 3.2 sq. ft. (10 per 4' x 8')	Plate bonded
Min. 22 ga. Type B, Grade 33 Steel	Approved Insulation	IB XHD #15 Roofing Fastener	isoweld TPO Plate	1.5x2-ft grid, staggered (11 per 4' x 8')	Plate bonded
Min. 22 ga. Type B, Grade 33 Steel	Approved Insulation	IB XHD #15 Roofing Fastener	Rhinobond TPO Plate	1 per 2.67 sq. ft. (12 per 4' x 8')	Plate bonded
Min. 22 ga. Type B, Grade 80 Steel	Approved Insulation	IB XHD #15 Roofing Fastener	isoweld TPO Plate	1.5x1.5-ft grid, staggered (14 per 4' x 8')	Plate bonded
Min. 22 ga. Type B, Grade 33 Steel	Approved Insulation	IB XHD #15 Roofing Fastener	Rhinobond TPO Plate	1 per 2.13 sq. ft. (15 per 4' x 8')	Plate bonded
Min. 22 ga. Type B, Grade 80 Steel	Approved Insulation	Trufast #15 Fastener	Trufast TPO IW Plate	1 per 2 sq. ft. (16 per 4' x 8')	Plate bonded
Min. 22 ga. Type B, Grade 33 Steel	Approved Insulation	IB SD #12 & 3" IB Insulation Plate (5 per 4' x 8') & IB XHD #15	Rhinobond TPO Plate	12" oc. in rows 60-inch oc.	Plate bonded
Min. 22 ga. Type B, Grade 33 Steel	Approved Insulation	IB SD #12 & 3" IB Insulation Plate (5 per 4' x 8') & IB XHD #15 Roofing Fastener	Rhinobond TPO Plate	6" oc. in rows 120-inch oc.	Plate bonded
Min. 22 ga. Type B, Grade 80 Steel	Approved Insulation	IB SD #12 & 3" IB Insulation Plate (5 per 4' x 8') & Trufast #15 Fastener	Trufast TPO IW Plate	6" oc. in rows 60-inch oc.	Plate bonded
Min. 22 ga. Type B, Grade 33 Steel	Approved Insulation	IB SD #12 & 3" IB Insulation Plate (5 per 4' x 8') & IB XHD #15 Roofing Fastener	isoweld TPO Plate	6" oc. in rows 60-inch oc.	Plate bonded

¹Approved Insulation: IB Energy Board II or III, or IB Approved UL Classified Polyisocyanurate, IB Approved UL Classified Expanded Polystyrene, IB Approved UL Classified Extruded Polystyrene Insulation

²The use of some IB Approved Insulations/Cover Boards and or combinations thereof may not achieve UL Classification.

System Uplift Note(s): **Refer to applicable Approval Guide for System Code and/or FM Approvals Information. ***Refer to Substrate Resistance Table for required pull-out values.

For additional information about IB Roof Systems requirements, recommendations, installation details, approvals, and limitations for the above assemblies, please refer to the latest edition of the IB Roof Systems Specifications Manual. For Technical Services please contact IB Technical Department at 800-426-1626.

Membranes:		Membrane Color:			Warranty Length**			Warranty Type**	
IB TPO SM 60 Mil		White*	Gray	Tan	10 Year	15 Year	20 Year	Contractor Warranty Only	
IB TPO SM 80 Mil		White*	Gray	Tan	15 Year	20 Year	25 Year	Total Systems - No Dollar Limit (TSW)	
*Meets CRRC, Title 24, LEED (SRI)					**Refer to Warranty Selection Guide for Warranty Riders, Term Length Limitations, and eligibility requirements of the IB Warranty Program			Warranty Plus (WP)	
								Commercial Limited Material Warranty (CLMW)	
								Residential Limited Material Warranty (RLMW)	
Submitted By:					Project Name:				
Company Name:					Address:				
Email/Phone:					City/State:				