

**Adhered TPO Membrane (SP) - Insulation (RB) - Vapor Barrier - Thermal Barrier (MA) - Steel Deck (New or Tear-Off)**

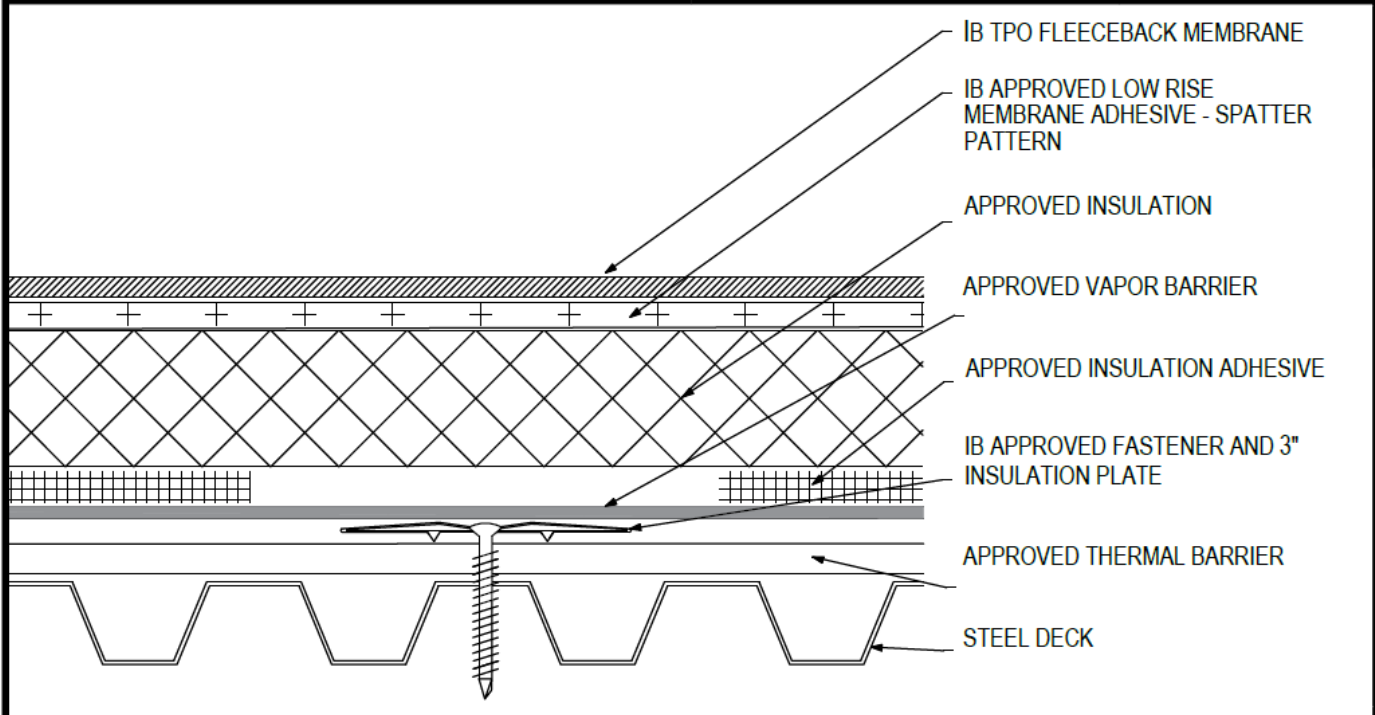

Deck Type	Thermal Barrier			Vapor Barrier/Insulation			IB Membrane Securement**
	Type <sup>1</sup>	Attachment	Type	Type <sup>2,3,4</sup>	Adhesive Type <sup>5</sup>	Pattern <sup>***</sup>	Attachment <sup>6,7</sup>
Min. 22 ga. Type B Grade 33 Steel	Approved Thermal Barrier	8 per 4' x 8' (1 per 4.0 sq. ft.)	IB SD #12 or HD #14, IB 3" Insulation Plate	Approved Vapor Barrier/Insulation	Approved Insulation Adhesive	Continuous Ribbons, 12" oc.	IB Approved Low Rise Membrane Adhesive
Min. 22 ga. Type B Grade 33 Steel	Approved Thermal Barrier	16 per 4' x 8' (1 per 2.0 sq. ft.)	IB SD #12 or HD #14, IB 3" Insulation Plate	Approved Vapor Barrier/Insulation	Approved Insulation Adhesive	Continuous Ribbons, 6" oc.	IB Approved Low Rise Membrane Adhesive
Min. 22 ga. Type B Grade 80 Steel	Approved Thermal Barrier	8 per 4' x 8' (1 per 4.0 sq. ft.)	IB SD #12 or HD #14, IB 3" Insulation Plate	Approved Vapor Barrier/Insulation	Approved Insulation Adhesive	Continuous Ribbons, 12" oc.	IB Approved Low Rise Membrane Adhesive
Min. 22 ga. Type B Grade 80 Steel	Approved Thermal Barrier	16 per 4' x 8' (1 per 2.0 sq. ft.)	IB SD #12 or HD #14, IB 3" Insulation Plate	Approved Vapor Barrier/Insulation	Approved Insulation Adhesive	Continuous Ribbons, 6" oc.	IB Approved Low Rise Membrane Adhesive

<sup>1</sup>**Thermal Barrier:** DensDeck, DensDeck Prime, DensDeck StormX, Securock UltraLight Coated Glass-Mat, Securock Gypsum Fiber Board, or DexCell FA Glass Mat Roof Board, minimum 1/2" thickness  
<sup>2</sup>**Approved Vapor Barrier:** IBarrier SA Membrane, IBarrier SA 106, IBarrier SA FG, IBarrier XP SA Membrane, applied using self-adhesive techniques; IBarrier 90G TG SBS, IBarrier 120G TG SBS, IBarrier 120P TG SGS, applied using torch welding techniques.  
<sup>3</sup>**Approved Insulation:** IB Energy Board II or III, or IB Approved UL Classified Polyisocyanurate.  
<sup>4</sup>The use of some IB Approved Insulations and/or insulation/vapor barrier combinations may not achieve UL Classification.  
<sup>5</sup>**Approved Insulation Adhesive:** Rapid Set Adhesive, Rapid Set PG Foam, Rapid Set ECO Spray Foam, Rapid Set ECO; Spray Foam, Millennium One Step, Millennium PG-1 SAF Pump Grade, Millennium PG-1 EF ECO, Millennium PG-1 EF ECO<sub>2</sub>, OB500 Adhesive Fastener, OB500 Cannister, or TruFast Roofing Adhesive.  
<sup>6</sup>**Approved Low Rise Membrane Adhesive:** IB Rapid Set ECO<sub>2</sub> Spray Foam, Millennium PG-1 EF ECO<sub>2</sub> Adhesive.  
<sup>7</sup>The use of some IB Approved Low Rise Membrane Adhesives may not achieve UL Classification.  
**System Uplift Note(s):** \*\*Refer to applicable Approval Guide for System Code and/or FM Approvals Information. \*\*\*Refer to Substrate Resistance Table for required pull-out values.

For additional information about IB Roof Systems requirements, recommendations, installation details, approvals, and limitations for the above assemblies, please refer to the latest edition of the IB Roof Systems Specifications Manual. For Technical Services please contact IB Technical Department at 800-426-1626.

Membranes:		Membrane Color:		Warranty Length**			Warranty Type**	
IB TPO FB 115 Mil	White*	10 Year	15 Year	20 Year	Contractor Warranty Only Total Systems - No Dollar Limit (TSW) Warranty Plus (WP) Commercial Limited Material Warranty (CLMW) Residential Limited Material Warranty (RLMW)			
IB TPO FB 135 Mil	White*	15 Year	20 Year	25 Year				
<sup>*</sup> Meets CRRC, Title 24, LEED (SRI)		<sup>**</sup> Refer to Warranty Selection Guide for Warranty Riders, Term Length Limitations, and eligibility requirements of the IB Warranty Program						

Submitted By:	Project Name:
Company Name:	Address:
Email/Phone:	City/State: