

Adhered TPO Membrane (SP) - Insulation (MA) - Vapor Barrier - Steel Deck (New or Tear-Off)

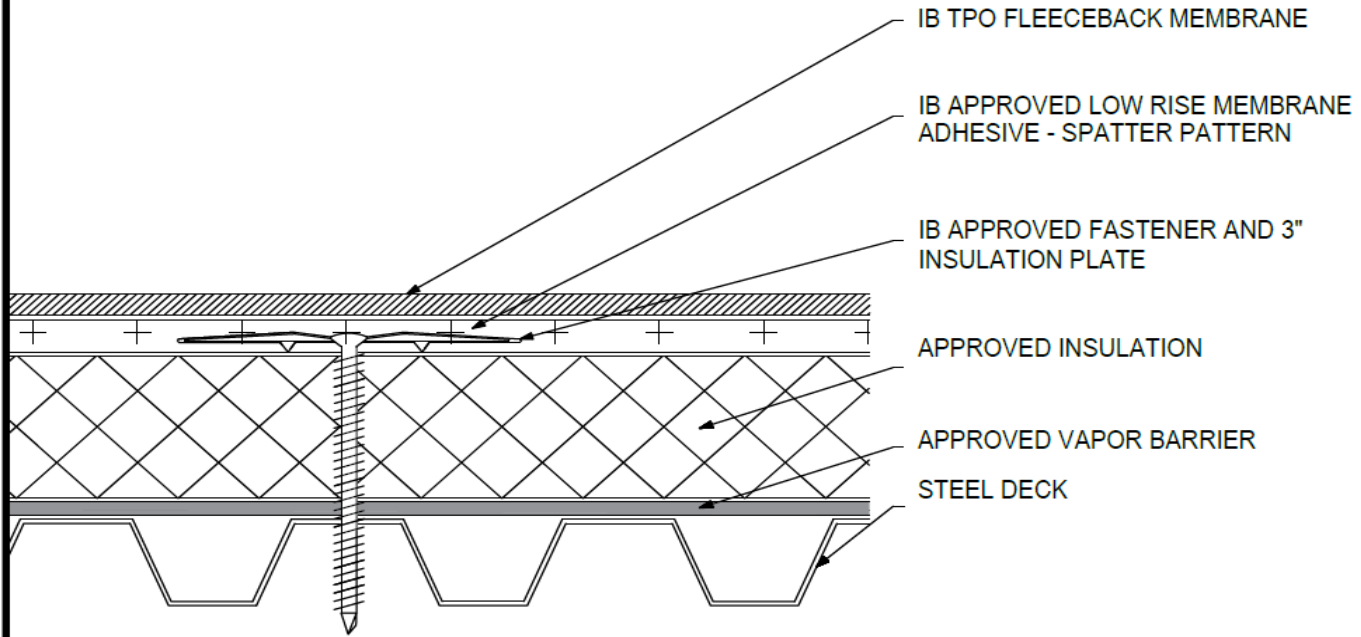

| Deck Type | Insulation/Vapor Barrier | | | IB Membrane Securement** |
|-----------------------------------|--|-------------------------------------|---|--|
| | Type ^{1,2,3} | Attachment | Fastener/Plate ^{***} | |
| Min. 22 ga. Type B Grade 33 Steel | Approved Insulation & Approved Vapor Barrier | 8 per 4' x 8' (1 per 4.0 sq. ft.) | IB SD #12 or HD #14, IB 3" Insulation Plate | IB Approved Low Rise Membrane Adhesive |
| Min. 22 ga. Type B Grade 33 Steel | Approved Insulation & Approved Vapor Barrier | 10 per 4' x 8' (1 per 3.2 sq. ft.) | IB SD #12 or HD #14, IB 3" Insulation Plate | IB Approved Low Rise Membrane Adhesive |
| Min. 22 ga. Type B Grade 33 Steel | Approved Insulation & Approved Vapor Barrier | 12 per 4' x 8' (1 per 2.67 sq. ft.) | IB SD #12 or HD #14, IB 3" Insulation Plate | IB Approved Low Rise Membrane Adhesive |
| Min. 22 ga. Type B Grade 33 Steel | Approved Insulation & Approved Vapor Barrier | 16 per 4' x 8' (1 per 2.0 sq. ft.) | IB SD #12 or HD #14, IB 3" Insulation Plate | IB Approved Low Rise Membrane Adhesive |
| Min. 22 ga. Type B Grade 80 Steel | Approved Insulation & Approved Vapor Barrier | 12 per 4' x 8' (1 per 2.67 sq. ft.) | IB SD #12 or HD #14, IB 3" Insulation Plate | IB Approved Low Rise Membrane Adhesive |
| Min. 22 ga. Type B Grade 80 Steel | Approved Insulation & Approved Vapor Barrier | 16 per 4' x 8' (1 per 2.0 sq. ft.) | IB SD #12 or HD #14, IB 3" Insulation Plate | IB Approved Low Rise Membrane Adhesive |
| Min. 22 ga. Type B Grade 80 Steel | Approved Insulation & Approved Vapor Barrier | 20 per 4' x 8' (1 per 1.6 sq. ft.) | IB SD #12 or HD #14, IB 3" Insulation Plate | IB Approved Low Rise Membrane Adhesive |
| Min. 22 ga. Type B Grade 80 Steel | Approved Insulation & Approved Vapor Barrier | 24 per 4' x 8' (1 per 1.3 sq. ft.) | IB SD #12 or HD #14, IB 3" Insulation Plate | IB Approved Low Rise Membrane Adhesive |

¹Approved Vapor Barrier: IBarrier SA Membrane, IBarrier FG SAR, IBarrier XP SA Membrane, applied using self-adhesive techniques.

²Approved Insulation: IB Energy Board II or III, or IB Approved UL Classified Polyisocyanurate.

³The use of some IB Approved Insulations may not achieve UL Classification.

⁴Approved Low Rise Membrane Adhesive: IB Rapid Set ECO₂ Spray Foam, Millennium PG-1 EF ECO₂ Adhesive.

⁵The use of some IB Approved Low Rise Membrane Adhesives may not achieve UL Classification.

System Uplift Note(s): **Refer to applicable Approval Guide for System Code and/or FM Approvals Information. *Refer to Substrate Resistance Table for required pull-out values.**

For additional information about IB Roof Systems requirements, recommendations, installation details, approvals, and limitations for the above assemblies, please refer to the latest edition of the IB Roof Systems Specifications Manual. For Technical Services please contact IB Technical Department at 800-426-1626.

| Membranes: | | Membrane Color: | | Warranty Length** | | | | Warranty Type** | |
|-------------------|--|-----------------|--|-------------------|---------|---------|--|--|--|
| IB TPO FB 115 Mil | | White* | | 10 Year | 15 Year | 20 Year | | Contractor Warranty Only | |
| IB TPO FB 135 Mil | | White* | | 15 Year | 20 Year | 25 Year | | Total Systems - No Dollar Limit (TSW) | |
| | | | | | | | | Warranty Plus (WP) | |
| | | | | | | | | Commercial Limited Material Warranty (CLMW) | |
| | | | | | | | | Residential Limited Material Warranty (RLMW) | |

*Meets CRRC, Title 24, LEED (SRI)

**Refer to Warranty Selection Guide for Warranty Riders, Term Length Limitations, and eligibility requirements of the IB Warranty Program

| | | | |
|---------------|--|---------------|--|
| Submitted By: | | Project Name: | |
| Company Name: | | Address: | |
| Email/Phone: | | City/State: | |