

Adhered TPO Membrane - Cover Board (RB) - Insulation (RB) - Vapor Barrier - Thermal Barrier (MA) - Steel Deck (New or Tear-Off)

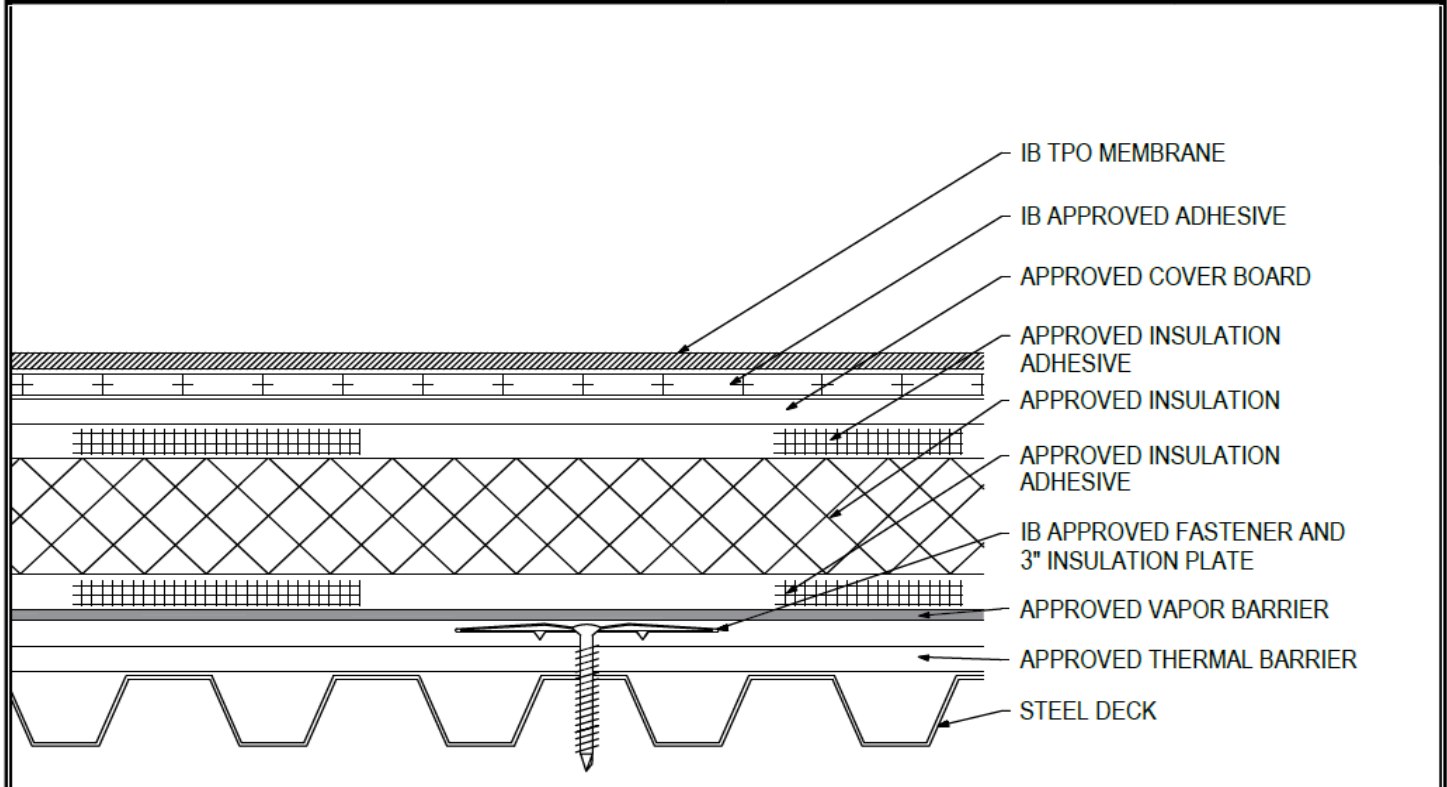

Deck Type	Thermal Barrier		Vapor Barrier/Insulation/Cover Board			IB Membrane Securement**	
	Type ¹	Attachment	Type	Type ^{2,3,4,5}	Adhesive Type ⁶	Pattern***	Attachment ⁷
Min. 22 ga. Type B Grade 33 Steel	Approved Thermal Barrier	8 per 4' x 8' (1 per 4.0 sq. ft.)	IB SD #12 or HD #14, IB 3" Insulation Plate	Approved Vapor Barrier/Insulation/Cover Board	Approved Insulation Adhesive	Continuous Ribbons, 12" oc.	IB Approved Adhesive
Min. 22 ga. Type B Grade 33 Steel	Approved Thermal Barrier	16 per 4' x 8' (1 per 2.0 sq. ft.)	IB SD #12 or HD #14, IB 3" Insulation Plate	Approved Vapor Barrier/Insulation/Cover Board	Approved Insulation Adhesive	Continuous Ribbons, 6" oc.	IB Approved Adhesive
Min. 22 ga. Type B Grade 80 Steel	Approved Thermal Barrier	8 per 4' x 8' (1 per 4.0 sq. ft.)	IB SD #12 or HD #14, IB 3" Insulation Plate	Approved Vapor Barrier/Insulation/Cover Board	Approved Insulation Adhesive	Continuous Ribbons, 12" oc.	IB Approved Adhesive
Min. 22 ga. Type B Grade 80 Steel	Approved Thermal Barrier	16 per 4' x 8' (1 per 2.0 sq. ft.)	IB SD #12 or HD #14, IB 3" Insulation Plate	Approved Vapor Barrier/Insulation/Cover Board	Approved Insulation Adhesive	Continuous Ribbons, 6" oc.	IB Approved Adhesive

¹Thermal Barrier: DensDeck, DensDeck Prime, DensDeck StormX, Securock Ultralight Coated Glass-Mat, Securock Gypsum Fiber Board, or DexCell FA Glass Mat Roof Board, minimum 1/2" thickness
²Approved Vapor Barrier: IBarrier SA Membrane, IBarrier SA 106, IBarrier SA FG, IBarrier XP SA Membrane, applied using self-adhesive techniques; IBarrier 90G TG SBS, IBarrier 120G TG SBS, IBarrier 120P TG SGS, applied using torch welding techniques. ³Approved Insulation: IB Energy Board II or III, or IB Approved UL Classified Polyisocyanurate, IB Approved UL Classified Expanded Polystyrene, IB Approved UL Classified Extruded Polystyrene Insulation. ⁴Approved Cover Board: DensDeck, DensDeck Prime, DensDeck StormX Prime, Securock Ultralight Glass-Mat, Securock Ultralight Coated Glass-Mat, Securock Gypsum Fiber Board, DEXcell Glass-Mat Roof Board, or DEXcell FA Glass Mat Roof Board, minimum 1/4" thickness; or minimum 7/16" DEXcell Cement Roof Board; or minimum 1/2" IB HD ISO-J, or 1/2" IB Recovery Energy Board III-J. ⁵The use of some IB Approved Insulations / Cover Boards and/or insulation/vapor barrier combinations may not achieve UL Classification. ⁶Approved Insulation Adhesive: Rapid Set Adhesive, Rapid Set PG Foam, Rapid Set ECO Spray Foam, Rapid Set ECO₂ Spray Foam, Millennium One Step, Millennium PG-1 SAF Pump Grade, Millennium PG-1 EF ECO, Millennium PG-1 EF ECO₂, OB500 Adhesive Fastener, OB500 Cannister, or TruFast Roofing Adhesive. ⁷Approved Adhesive: IB TPO Water Based Adhesive, IB TPO Bonding Adhesive, IB TPO LVOC Adhesive, IB TPO CA LVOC Adhesive, or IB TPO Spray Contact Adhesive.
Note: IB TPO Bonding Adhesive, IB TPO LVOC Adhesive and IB TPO CA LVOC Adhesive cannot be used with IB TPO FB Membranes. System Uplift Note(s): **Refer to applicable Approval Guide for System Code and/or FM Approvals Information. *Refer to Substrate Resistance Table for required pull-out values.**

For additional information about IB Roof Systems requirements, recommendations, installation details, approvals, and limitations for the above assemblies, please refer to the latest edition of the IB Roof Systems Specifications Manual. For Technical Services please contact IB Technical Department at 800-426-1626.

Membranes:	Membrane Color:	Warranty Length**			Warranty Type**
IB TPO SM 60 Mil	White* Gray Tan	10 Year	15 Year	20 Year	Contractor Warranty Only
IB TPO SM 80 Mil	White* Gray Tan	15 Year	20 Year	25 Year	Total Systems - No Dollar Limit (TSW)
IB TPO FB 115 Mil	White*	10 Year	15 Year	20 Year	Warranty Plus (WP)
IB TPO FB 135 Mil	White*	15 Year	20 Year	25 Year	Commercial Limited Material Warranty (CLMW) Residential Limited Material Warranty (RLMW)

*Meets CRRC, Title 24, LEED (SFI)

**Refer to Warranty Selection Guide for Warranty Riders, Term Length Limitations, and eligibility requirements of the IB Warranty Program

Submitted By:	Project Name:
Company Name:	Address:
Email/Phone:	City/State: