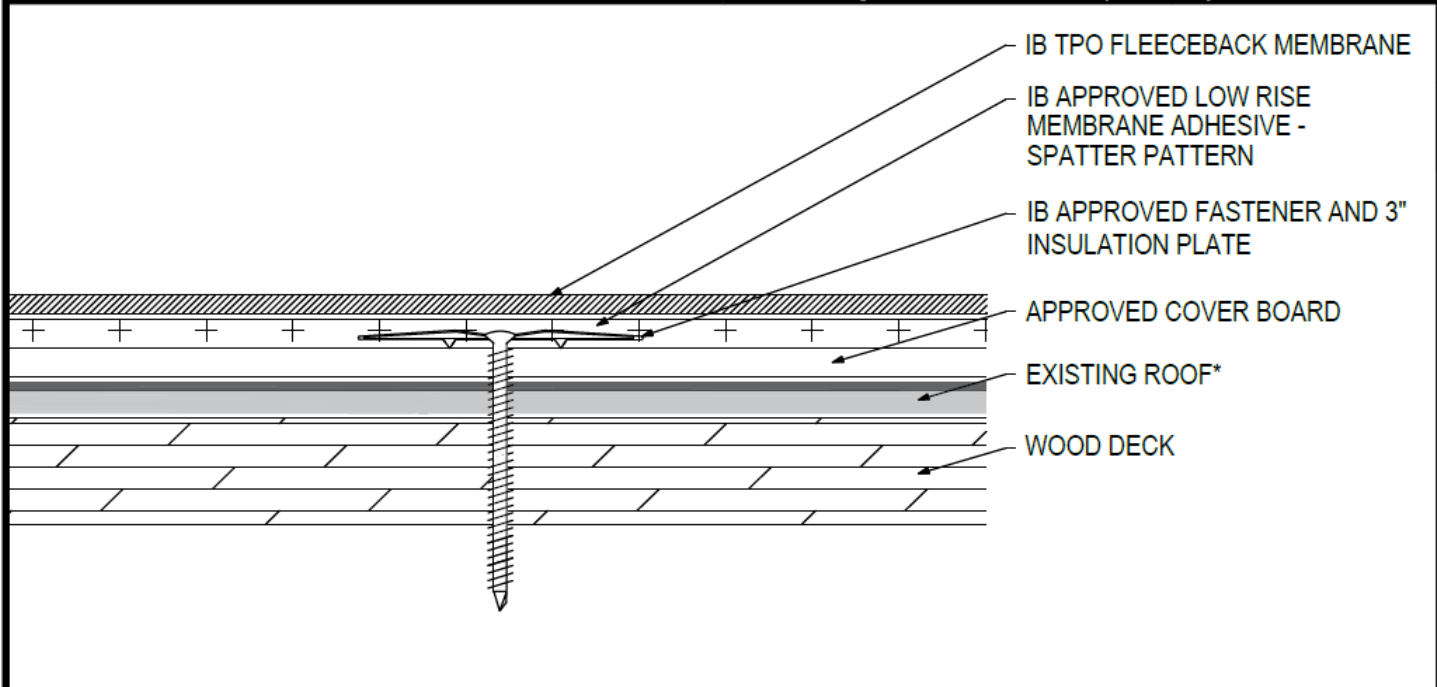

Adhered TPO Membrane (SP) - Cover Board (MA) - Existing Roof - Wood Deck (Recover)

| Deck Type | Cover Board (over Existing Roof) ¹ | | | IB Membrane Securement ^{**} |
|---------------------|---|--|--|--|
| | Type ^{2,3} | Attachment | Fastener/Plate ^{***} | Attachment ⁴ |
| Min. 7/16" OSB | Approved Cover Board | 12 per 4' x 8' (1 per 2.67 sq. ft.) | IB SD #12 or HD #14, IB 3" Insulation Plate | IB Approved Low Rise Membrane Adhesive |
| Min. 7/16" OSB | Approved Cover Board | 16 per 4' x 8' (1 per 2.0 sq. ft.) | IB SD #12 or HD #14, IB 3" Insulation Plate | IB Approved Low Rise Membrane Adhesive |
| Min. 1/2" Plywood | Approved Cover Board | 8 per 4' x 8' (1 per 4.0 sq. ft.) | IB SD #12 or HD #14, IB 3" Insulation Plate | IB Approved Low Rise Membrane Adhesive |
| Min. 1/2" Plywood | Approved Cover Board | 10 per 4' x 8' (1 per 3.2 sq. ft.) | IB SD #12 or HD #14, IB 3" Insulation Plate | IB Approved Low Rise Membrane Adhesive |
| Min. 1/2" Plywood | Approved Cover Board | 12 per 4' x 8' (1 per 2.67 sq. ft.) | IB SD #12 or HD #14, IB 3" Insulation Plate | IB Approved Low Rise Membrane Adhesive |
| Min. 19/32" Plywood | Approved Cover Board | 16 per 4' x 8' (1 per 2.0 sq. ft.) | IB SD #12 or HD #14, IB 3" Insulation Plate | IB Approved Low Rise Membrane Adhesive |
| Min. 19/32" Plywood | Approved Cover Board | 20 per 4' x 8' (1 per 1.6 sq. ft.) | IB SD #12 or HD #14, IB 3" Insulation Plate | IB Approved Low Rise Membrane Adhesive |
| Min. 19/32" Plywood | Approved Cover Board | 24 per 4' x 8' (1 per 1.3 sq. ft.) | IB SD #12 or HD #14, IB 3" Insulation Plate | IB Approved Low Rise Membrane Adhesive |

¹Existing Roof: APP or SBS modified bitumen, smooth or granule surfaced asphaltic built-up roof, or single-ply membrane (CPA, CSPE, EPDM, PVC, or TPO).
²Approved Cover Board: DensDeck Prime, DensDeck ProFast Prime, DensDeck StormX Prime, Securock Ultralight Coated Glass-Mat, Securock Gypsum Fiber Board, or DEXcell FA Glass Mat Roof Board, minimum 1/4" thickness; or minimum 7/16" DEXcell Cement Roof Board; or minimum 1/2" IB HD ISO-J, or 1/2" IB Recovery Energy Board III-J.
³The use of some IB Approved Cover Boards may not achieve UL Classification.
⁴Approved Low Rise Membrane Adhesive: IB Rapid Set ECO₂ Spray Foam, Millennium PG-1 EF ECO₂ Adhesive.
 System Uplift Note(s): **Refer to applicable Approval Guide for System Code and/or FM Approvals Information. ***Refer to Substrate Resistance Table for required pull-out values.

For additional information about IB Roof Systems requirements, recommendations, installation details, approvals, and limitations for the above assemblies, please refer to the latest edition of the IB Roof Systems Specifications Manual. For Technical Services please contact IB Technical Department at 800-426-1626.

| Membranes: | | Membrane Color: | | Warranty Length ^{**} | | | Warranty Type ^{**} | |
|-----------------------------------|--------|-----------------|--|---|---------|---------|--|--|
| IB TPO FB 115 Mil | White* | | | 10 Year | 15 Year | 20 Year | Contractor Warranty Only | |
| IB TPO FB 135 Mil | White* | | | 10 Year | 15 Year | 20 Year | Total Systems - No Dollar Limit (TSW) | |
| *Meets CRRC, Title 24, LEED (SRI) | | | | **Refer to Warranty Selection Guide for Warranty Riders, Term Length Limitations, and eligibility requirements of the IB Warranty Program | | | Warranty Plus (WP) | |
| | | | | | | | Commercial Limited Material Warranty (CLMW) | |
| | | | | | | | Residential Limited Material Warranty (RLMW) | |

| | | | |
|---------------|--|---------------|--|
| Submitted By: | | Project Name: | |
| Company Name: | | Address: | |
| Email/Phone: | | City/State: | |

Adhered TPO Membrane (SP) - Cover Board (RB) - Existing Roof - Wood Deck (Recover)

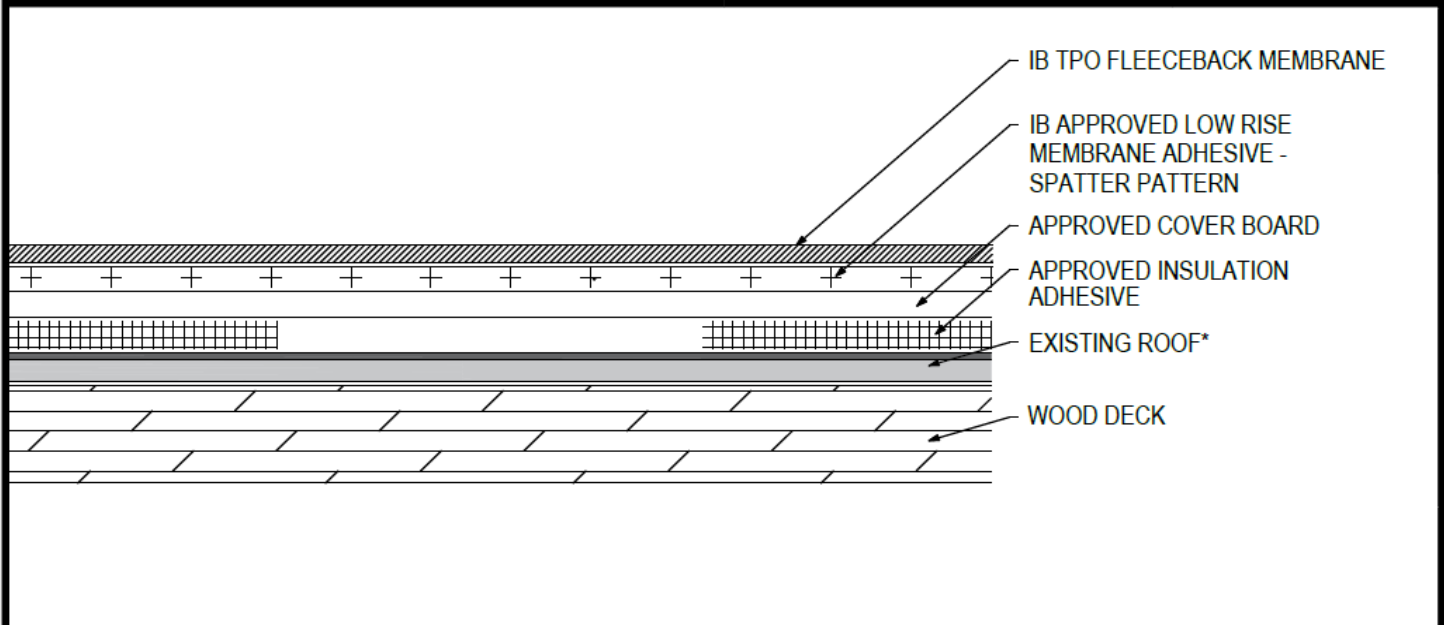

| Deck Type | Cover Board (over Existing Roof) ¹ | | | IB Membrane Securement ^{**} |
|---------------------|---|----------------------------------|---------------------------------------|--|
| | Type ^{2,3} | Insulation Adhesive ⁴ | Pattern ^{***} | Attachment ⁵ |
| Min. 7/16" OSB | Approved Cover Board | Approved Insulation Adhesive | Min. Four Continuous Ribbons, 12" oc. | IB Approved Low Rise Membrane Adhesive |
| Min. 1/2" Plywood | Approved Cover Board | Approved Insulation Adhesive | Min. Four Continuous Ribbons, 12" oc. | IB Approved Low Rise Membrane Adhesive |
| Min. 19/32" Plywood | Approved Cover Board | Approved Insulation Adhesive | Min. Four Continuous Ribbons, 12" oc. | IB Approved Low Rise Membrane Adhesive |

¹Existing Roof: APP or SBS modified bitumen, smooth or granule surfaced asphaltic built-up roof only.
²Approved Cover Board: DensDeck Prime, DensDeck ProFast Prime, DensDeck StormX Prime, Securock Ultralight Coated Glass-Mat, Securock Gypsum Fiber Board, or DEXcell FA Glass Mat Roof Board, minimum 1/4" thickness; or minimum 7/16" DEXcell Cement Roof Board; or minimum 1/2" IB HD ISO-J, or 1/2" IB Recovery Energy Board III-J.
³The use of some IB Approved Cover Boards may not achieve UL Classification.
⁴Approved Insulation Adhesive: Rapid Set Adhesive, Rapid Set PG Foam, Rapid Set ECO₂ Spray Foam, Millennium One Step, Millennium PG-1 SAF Pump Grade, Millennium PG-1 EF ECO, Millennium PG-1 EF ECO₂, OB500 Adhesive Fastener, OB500 Cannister, or TruFast Roofing Adhesive.
⁵Approved Low Rise Membrane Adhesive: IB Rapid Set ECO₂ Spray Foam Adhesive, Millennium PG-1 EF ECO₂ Adhesive.
System Uplift Note(s): **Refer to applicable Approval Guide for System Code and/or FM Approvals Information. *Refer to Substrate Resistance Table for required pull-out values.**

For additional information about IB Roof Systems requirements, recommendations, installation details, approvals, and limitations for the above assemblies, please refer to the latest edition of the IB Roof Systems Specifications Manual. For Technical Services please contact IB Technical Department at 800-426-1626.

| Membranes: | | Membrane Color: | | Warranty Length ^{**} | | | Warranty Type ^{**} | |
|-----------------------------------|--------|-----------------|--|-------------------------------|---------|---------|--|--|
| IB TPO FB 115 Mil | White* | | | 10 Year | 15 Year | 20 Year | Contractor Warranty Only | |
| IB TPO FB 135 Mil | White* | | | 10 Year | 15 Year | 20 Year | Total Systems - No Dollar Limit (TSW) | |
| *Meets CRRC, Title 24, LEED (SRI) | | | | | | | Warranty Plus (WP) | |
| | | | | | | | Commercial Limited Material Warranty (CLMW) | |
| | | | | | | | Residential Limited Material Warranty (RLMW) | |

^{**}Refer to Warranty Selection Guide for Warranty Riders, Term Length Limitations, and eligibility requirements of the IB Warranty Program

| | | | |
|---------------|--|---------------|--|
| Submitted By: | | Project Name: | |
| Company Name: | | Address: | |
| Email/Phone: | | City/State: | |



FA_{SP}-CB_{MA}-IN_{MA}-EX-W

Adhered TPO Membrane (SP) - Cover Board (MA) - Insulation (MA) - Existing Roof - Wood Deck (Recover)

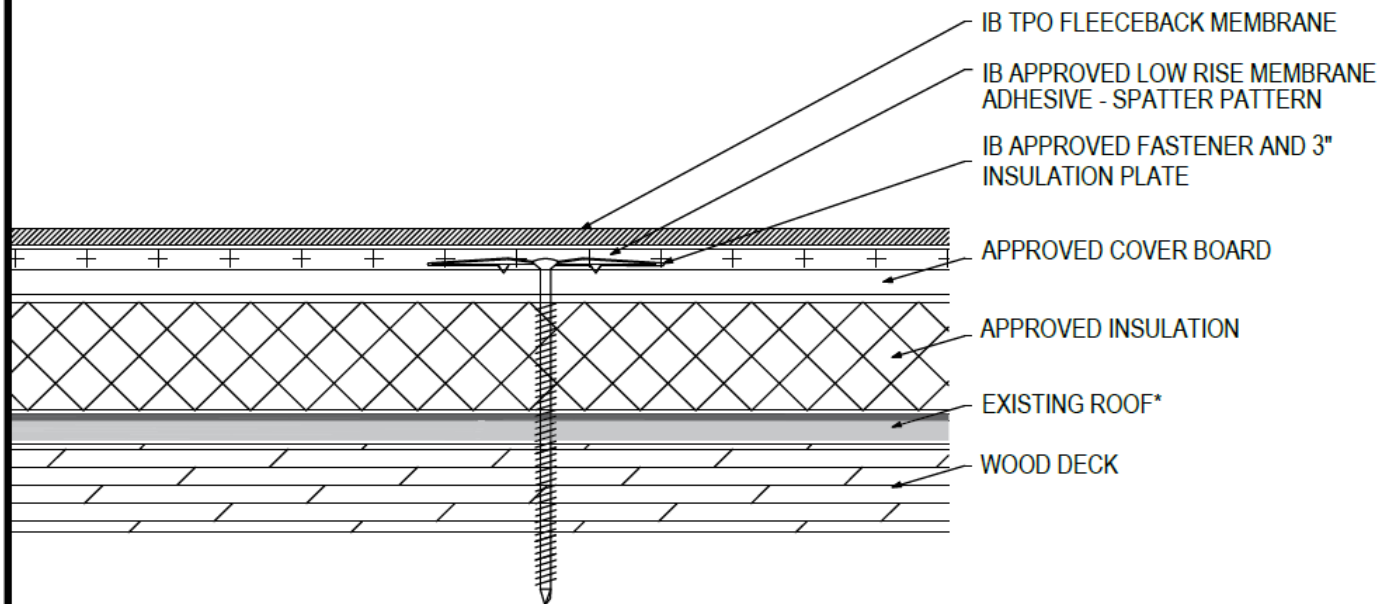

| Deck Type | Insulation/Cover Board (over Existing Roof) ¹ | | | IB Membrane Securement** |
|---------------------|--|-------------------------------------|---|--|
| | Type ^{2,3,4} | Attachment | Fastener/Plate*** | |
| Min. 7/16" OSB | Approved Insulation & Approved Cover Board | 12 per 4' x 8' (1 per 2.67 sq. ft.) | IB SD #12 or HD #14, IB 3" Insulation Plate | IB Approved Low Rise Membrane Adhesive |
| Min. 7/16" OSB | Approved Insulation & Approved Cover Board | 16 per 4' x 8' (1 per 2.0 sq. ft.) | IB SD #12 or HD #14, IB 3" Insulation Plate | IB Approved Low Rise Membrane Adhesive |
| Min. 1/2" Plywood | Approved Insulation & Approved Cover Board | 8 per 4' x 8' (1 per 4.0 sq. ft.) | IB SD #12 or HD #14, IB 3" Insulation Plate | IB Approved Low Rise Membrane Adhesive |
| Min. 1/2" Plywood | Approved Insulation & Approved Cover Board | 10 per 4' x 8' (1 per 3.2 sq. ft.) | IB SD #12 or HD #14, IB 3" Insulation Plate | IB Approved Low Rise Membrane Adhesive |
| Min. 1/2" Plywood | Approved Insulation & Approved Cover Board | 12 per 4' x 8' (1 per 2.67 sq. ft.) | IB SD #12 or HD #14, IB 3" Insulation Plate | IB Approved Low Rise Membrane Adhesive |
| Min. 19/32" Plywood | Approved Insulation & Approved Cover Board | 16 per 4' x 8' (1 per 2.0 sq. ft.) | IB SD #12 or HD #14, IB 3" Insulation Plate | IB Approved Low Rise Membrane Adhesive |
| Min. 19/32" Plywood | Approved Insulation & Approved Cover Board | 20 per 4' x 8' (1 per 1.6 sq. ft.) | IB SD #12 or HD #14, IB 3" Insulation Plate | IB Approved Low Rise Membrane Adhesive |
| Min. 19/32" Plywood | Approved Insulation & Approved Cover Board | 24 per 4' x 8' (1 per 1.3 sq. ft.) | IB SD #12 or HD #14, IB 3" Insulation Plate | IB Approved Low Rise Membrane Adhesive |

¹Existing Roof: APP or SBS modified bitumen, smooth or granule surfaced asphaltic built-up roof, or single-ply membrane (CPA, CSPE, EPDM, PVC, or TPO).
²Approved Insulation: IB Energy Board II or III, or IB Approved UL Classified Polyisocyanurate, IB Approved UL Classified Expanded Polystyrene, IB Approved UL Classified Extruded Polystyrene Insulation.
³Approved Cover Board: DensDeck Prime, DensDeck ProFast Prime, DensDeck StormX Prime, Securock Ultralight Coated Glass-Mat, Securock Gypsum Fiber Board, or DEXcell FA Glass Mat Roof Board, minimum 1/4" thickness; or minimum 7/16" DEXcell Cement Roof Board; or minimum 1/2" IB HD ISO-J, or 1/2" IB Recovery Energy Board III-J.
⁴The use of some IB Approved Insulations and/or Cover Boards or combinations thereof may not achieve UL Classification.
⁵Approved Low Rise Membrane Adhesive: IB Rapid Set ECO₂ Spray Foam, Millennium PG-1 EF ECO₂ Adhesive.
 System Uplift Note(s): **Refer to applicable Approval Guide for System Code and/or FM Approvals Information. ***Refer to Substrate Resistance Table for required pull-out values.

For additional information about IB Roof Systems requirements, recommendations, installation details, approvals, and limitations for the above assemblies, please refer to the latest edition of the IB Roof Systems Specifications Manual. For Technical Services please contact IB Technical Department at 800-426-1626.

| Membranes: | | Membrane Color: | | Warranty Length** | | | Warranty Type** | |
|-----------------------------------|--|-----------------|--|---|---------|---------|--|--|
| IB TPO FB 115 Mil | | White* | | 10 Year | 15 Year | 20 Year | Contractor Warranty Only | |
| IB TPO FB 135 Mil | | White* | | 10 Year | 15 Year | 20 Year | Total Systems - No Dollar Limit (TSW) | |
| *Meets CRRC, Title 24, LEED (SRI) | | | | **Refer to Warranty Selection Guide for Warranty Riders, Term Length Limitations, and eligibility requirements of the IB Warranty Program | | | Warranty Plus (WP) | |
| | | | | | | | Commercial Limited Material Warranty (CLMW) | |
| | | | | | | | Residential Limited Material Warranty (RLMW) | |

| | | | |
|---------------|--|---------------|--|
| Submitted By: | | Project Name: | |
| Company Name: | | Address: | |
| Email/Phone: | | City/State: | |

Adhered TPO Membrane (SP) - Cover Board (RB) - Insulation (MA) - Existing Roof - Wood Deck (Recover)

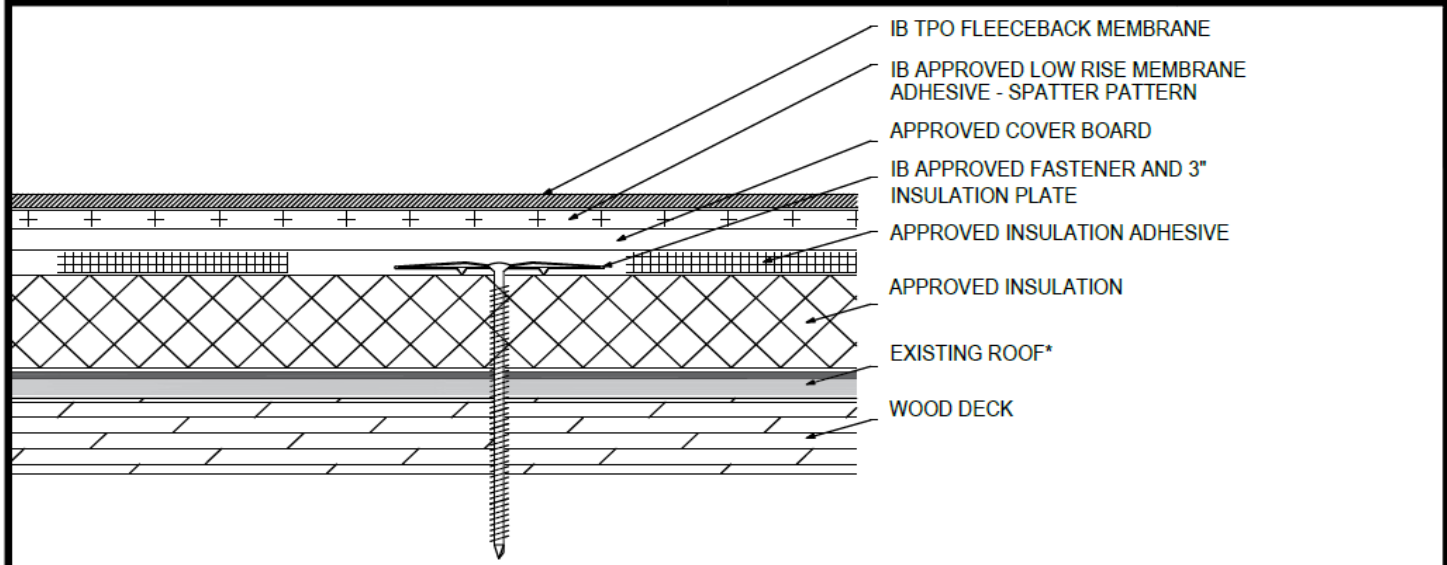

| Deck Type | Insulation (over Existing Roof) ¹ | | | Cover Board | | | IB Membrane Securement ^{**} |
|---------------------|--|-------------------------------------|---|----------------------|------------------------------|---------------------------------------|--|
| | Type ^{2,4} | Attachment | Fastener/Plate ^{***} | Type ^{3,4} | Adhesive Type ⁵ | Pattern ^{***} | Attachment ⁶ |
| Min. 7/16" OSB | Approved Insulation | 12 per 4' x 8' (1 per 2.67 sq. ft.) | IB SD #12 or HD #14, IB 3" Insulation Plate | Approved Cover Board | Approved Insulation Adhesive | Min. Four Continuous Ribbons, 12" oc. | IB Approved Low Rise Membrane Adhesive |
| Min. 7/16" OSB | Approved Insulation | 16 per 4' x 8' (1 per 2.0 sq. ft.) | IB SD #12 or HD #14, IB 3" Insulation Plate | Approved Cover Board | Approved Insulation Adhesive | Min. Eight Continuous Ribbons, 6" oc. | IB Approved Low Rise Membrane Adhesive |
| Min. 1/2" Plywood | Approved Insulation | 8 per 4' x 8' (1 per 4.0 sq. ft.) | IB SD #12 or HD #14, IB 3" Insulation Plate | Approved Cover Board | Approved Insulation Adhesive | Min. Four Continuous Ribbons, 12" oc. | IB Approved Low Rise Membrane Adhesive |
| Min. 1/2" Plywood | Approved Insulation | 10 per 4' x 8' (1 per 3.2 sq. ft.) | IB SD #12 or HD #14, IB 3" Insulation Plate | Approved Cover Board | Approved Insulation Adhesive | Min. Eight Continuous Ribbons, 6" oc. | IB Approved Low Rise Membrane Adhesive |
| Min. 1/2" Plywood | Approved Insulation | 12 per 4' x 8' (1 per 2.67 sq. ft.) | IB SD #12 or HD #14, IB 3" Insulation Plate | Approved Cover Board | Approved Insulation Adhesive | Min. Four Continuous Ribbons, 12" oc. | IB Approved Low Rise Membrane Adhesive |
| Min. 19/32" Plywood | Approved Insulation | 16 per 4' x 8' (1 per 2.0 sq. ft.) | IB SD #12 or HD #14, IB 3" Insulation Plate | Approved Cover Board | Approved Insulation Adhesive | Min. Eight Continuous Ribbons, 6" oc. | IB Approved Low Rise Membrane Adhesive |
| Min. 19/32" Plywood | Approved Insulation | 20 per 4' x 8' (1 per 1.6 sq. ft.) | IB SD #12 or HD #14, IB 3" Insulation Plate | Approved Cover Board | Approved Insulation Adhesive | Min. Four Continuous Ribbons, 12" oc. | IB Approved Low Rise Membrane Adhesive |
| Min. 19/32" Plywood | Approved Insulation | 24 per 4' x 8' (1 per 1.3 sq. ft.) | IB SD #12 or HD #14, IB 3" Insulation Plate | Approved Cover Board | Approved Insulation Adhesive | Min. Eight Continuous Ribbons, 6" oc. | IB Approved Low Rise Membrane Adhesive |

¹Existing Roof: APP or SBS modified bitumen, smooth or granule surfaced asphaltic built-up roof, or single-ply membrane (CPA, CSPE, EPDM, PVC, or TPO).
²Approved Insulation: IB Energy Board II or III, or IB Approved UL Classified Polyisocyanurate, IB Approved UL Classified Expanded Polystyrene, IB Approved UL Classified Extruded Polystyrene Insulation.
³Approved Cover Board: DensDeck Prime, DensDeck ProFast Prime, DensDeck StormX Prime, Securock Ultralight Coated Glass-Mat, Securock Gypsum Fiber Board, or DEXcell FA Glass Mat Roof Board, minimum 1/4" thickness; or minimum 7/16" DEXcell Cement Roof Board; or minimum 1/2" IB HD ISO-J, or 1/2" IB Recovery Energy Board III-J.
⁴The use of some IB Approved Insulations and/or Cover Boards or combinations thereof may not achieve UL Classification.
⁵Approved Insulation Adhesive: Rapid Set Adhesive, Rapid Set PG Foam, Rapid Set ECO Spray Foam, Rapid Set ECO₂ Spray Foam, Millennium One Step, Millennium PG-1 SAF Pump Grade, Millennium PG-1 EF ECO, Millennium PG-1 EF ECO₂, OB500 Adhesive Fastener, OB500 Cannister, or TruFast Roofing Adhesive.
⁶Approved Low Rise Membrane Adhesive: IB Rapid Set ECO₂ Spray Foam, Millennium PG-1 EF ECO₂ Adhesive.
System Uplift Note(s): **Refer to applicable Approval Guide for System Code and/or FM Approvals Information. *Refer to Substrate Resistance Table for required pull-out values.**

For additional information about IB Roof Systems requirements, recommendations, installation details, approvals, and limitations for the above assemblies, please refer to the latest edition of the IB Roof Systems Specifications Manual. For Technical Services please contact IB Technical Department at 800-426-1626.

| Membranes: | Membrane Color: | Warranty Length ^{**} | | | Warranty Type ^{**} |
|-----------------------------------|-----------------|---|---------|---------|--|
| IB TPO FB 115 Mil | White* | 10 Year | 15 Year | 20 Year | Contractor Warranty Only |
| IB TPO FB 135 Mil | White* | 10 Year | 15 Year | 20 Year | Total Systems - No Dollar Limit (TSW) |
| *Meets CRRC, Title 24, LEED (SFI) | | **Refer to Warranty Selection Guide for Warranty Riders, Term Length Limitations, and eligibility requirements of the IB Warranty Program | | | Warranty Plus (WP) |
| | | | | | Commercial Limited Material Warranty (CLMW) |
| | | | | | Residential Limited Material Warranty (RLMW) |

| | |
|---------------|---------------|
| Submitted By: | Project Name: |
| Company Name: | Address: |
| Email/Phone: | City/State: |

Adhered TPO Membrane (SP) - Cover Board (RB) - Insulation (RB) - Existing Roof - Wood Deck (Recover)

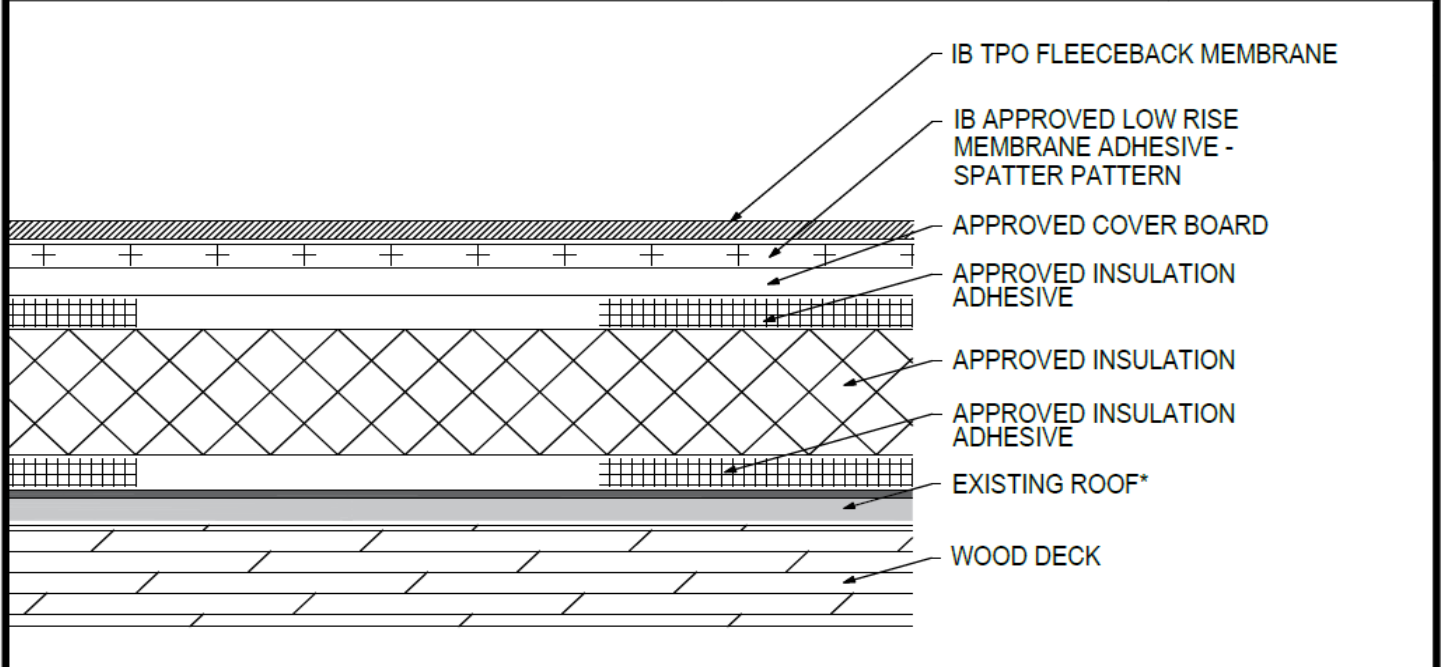

| Deck Type | Insulation (over Existing Roof) ¹ | | | Cover Board | | | IB Membrane Securement ^{**} |
|---------------------|--|------------------------------|---------------------------------------|----------------------|------------------------------|---------------------------------------|--------------------------------------|
| | Type ^{2,4} | Attachment | Fastener/Plate ^{***} | Type ^{3,4} | Adhesive Type ⁵ | Pattern ^{***} | Attachment ⁶ |
| Min. 7/16" OSB | Approved Insulation | Approved Insulation Adhesive | Min. Four Continuous Ribbons, 12" oc. | Approved Cover Board | Approved Insulation Adhesive | Min. Four Continuous Ribbons, 12" oc. | IB Approved Adhesive |
| Min. 7/16" OSB | Approved Insulation | Approved Insulation Adhesive | Min. Eight Continuous Ribbons, 6" oc. | Approved Cover Board | Approved Insulation Adhesive | Min. Eight Continuous Ribbons, 6" oc. | IB Approved Adhesive |
| Min. 1/2" Plywood | Approved Insulation | Approved Insulation Adhesive | Min. Four Continuous Ribbons, 12" oc. | Approved Cover Board | Approved Insulation Adhesive | Min. Four Continuous Ribbons, 12" oc. | IB Approved Adhesive |
| Min. 1/2" Plywood | Approved Insulation | Approved Insulation Adhesive | Min. Eight Continuous Ribbons, 6" oc. | Approved Cover Board | Approved Insulation Adhesive | Min. Eight Continuous Ribbons, 6" oc. | IB Approved Adhesive |
| Min. 19/32" Plywood | Approved Insulation | Approved Insulation Adhesive | Min. Four Continuous Ribbons, 12" oc. | Approved Cover Board | Approved Insulation Adhesive | Min. Four Continuous Ribbons, 12" oc. | IB Approved Adhesive |
| Min. 19/32" Plywood | Approved Insulation | Approved Insulation Adhesive | Min. Eight Continuous Ribbons, 6" oc. | Approved Cover Board | Approved Insulation Adhesive | Min. Eight Continuous Ribbons, 6" oc. | IB Approved Adhesive |

¹Existing Roof: APP or SBS modified bitumen, smooth or granule surfaced asphaltic built-up roof only.
²Approved Insulation: IB Energy Board II or III, or IB Approved UL Classified Polyisocyanurate, IB Approved UL Classified Expanded Polystyrene, IB Approved UL Classified Extruded Polystyrene Insulation.
³Approved Cover Board: DensDeck Prime, DensDeck ProFast Prime, DensDeck StormX Prime, Securock Ultralight Coated Glass-Mat, Securock Gypsum Fiber Board, or DEXcell FA Glass Mat Roof Board, minimum 1/4" thickness; or minimum 7/16" DEXcell Cement Roof Board; or minimum 1/2" IB HD ISO-J, or 1/2" IB Recovery Energy Board III-J.
⁴The use of some IB Approved Insulations and/or Cover Boards or combinations thereof may not achieve UL Classification.
⁵Approved Insulation Adhesive: Rapid Set Adhesive, Rapid Set PG Foam, Rapid Set ECO Spray Foam, Rapid Set ECO₂ Spray Foam, Millennium One Step, Millennium PG-1 SAF Pump Grade, Millennium PG-1 EF ECO, Millennium PG-1 EF ECO₂, OB500 Adhesive Fastener, OB500 Cannister, or TruFast Roofing Adhesive.
⁶Approved Low Rise Membrane Adhesive: IB Rapid Set ECO₂ Spray Foam, Millennium PG-1 EF ECO₂ Adhesive.

System Uplift Note(s): **Refer to applicable Approval Guide for System Code and/or FM Approvals Information. ***Refer to Substrate Resistance Table for required pull-out values.
 For additional information about IB Roof Systems requirements, recommendations, installation details, approvals, and limitations for the above assemblies, please refer to the latest edition of the IB Roof Systems Specifications Manual. For Technical Services please contact IB Technical Department at 800-426-1626.

| Membranes: | | Membrane Color: | | Warranty Length ^{**} | | | Warranty Type ^{**} | |
|-----------------------------------|--|-----------------|--|---|---------|---------|--|--|
| IB TPO FB 115 Mil | | White* | | 10 Year | 15 Year | 20 Year | Contractor Warranty Only | |
| IB TPO FB 135 Mil | | White* | | 10 Year | 15 Year | 20 Year | Total Systems - No Dollar Limit (TSW) | |
| *Meets CRRC, Title 24, LEED (SRI) | | | | **Refer to Warranty Selection Guide for Warranty Riders, Term Length Limitations, and eligibility requirements of the IB Warranty Program | | | Warranty Plus (WP) | |
| | | | | | | | Commercial Limited Material Warranty (CLMW) | |
| | | | | | | | Residential Limited Material Warranty (RLMW) | |

| | | | |
|---------------|--|---------------|--|
| Submitted By: | | Project Name: | |
| Company Name: | | Address: | |
| Email/Phone: | | City/State: | |

Adhered TPO Membrane (SP) - Insulation (MA) - Existing Roof - Wood Deck (Recover)

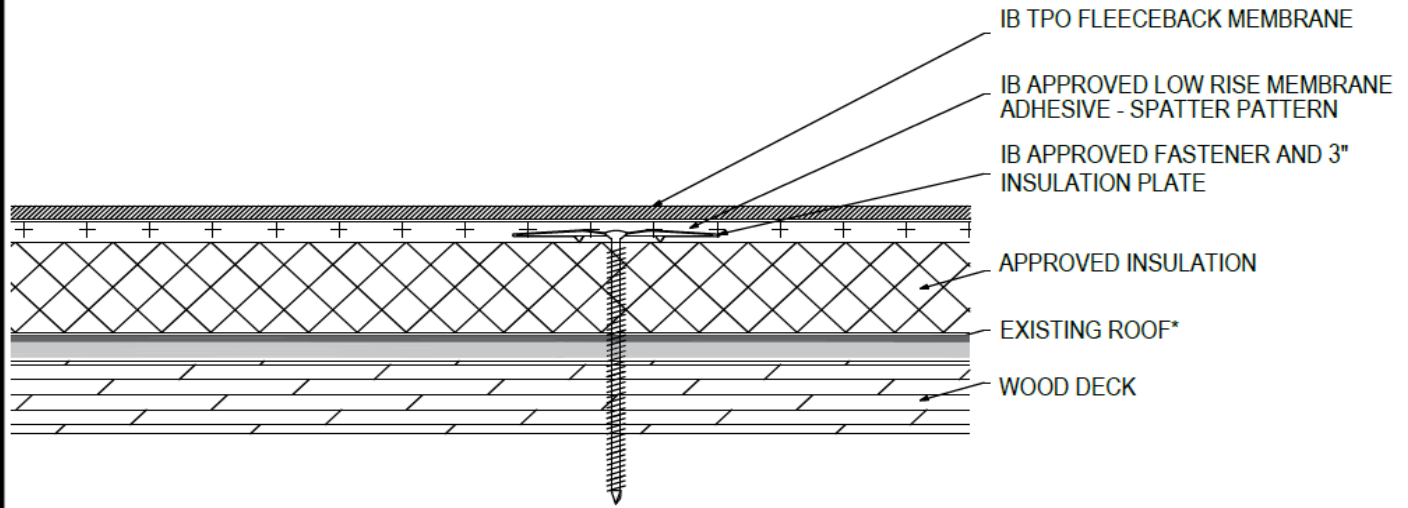

| Deck Type | Insulation (over Existing Roof) ¹ | | | IB Membrane Securement ^{**} |
|---------------------|--|--|--|--|
| | Type ^{2,3} | Attachment | Fastener/Plate ^{***} | Attachment [‡] |
| Min. 7/16" OSB | Approved Insulation | 12 per 4' x 8' (1 per 2.67 sq. ft.) | IB SD #12 or HD #14, IB 3" Insulation Plate | IB Approved Low Rise Membrane Adhesive |
| Min. 7/16" OSB | Approved Insulation | 16 per 4' x 8' (1 per 2.0 sq. ft.) | IB SD #12 or HD #14, IB 3" Insulation Plate | IB Approved Low Rise Membrane Adhesive |
| Min. 1/2" Plywood | Approved Insulation | 8 per 4' x 8' (1 per 4.0 sq. ft.) | IB SD #12 or HD #14, IB 3" Insulation Plate | IB Approved Low Rise Membrane Adhesive |
| Min. 1/2" Plywood | Approved Insulation | 10 per 4' x 8' (1 per 3.2 sq. ft.) | IB SD #12 or HD #14, IB 3" Insulation Plate | IB Approved Low Rise Membrane Adhesive |
| Min. 1/2" Plywood | Approved Insulation | 12 per 4' x 8' (1 per 2.67 sq. ft.) | IB SD #12 or HD #14, IB 3" Insulation Plate | IB Approved Low Rise Membrane Adhesive |
| Min. 19/32" Plywood | Approved Insulation | 16 per 4' x 8' (1 per 2.0 sq. ft.) | IB SD #12 or HD #14, IB 3" Insulation Plate | IB Approved Low Rise Membrane Adhesive |
| Min. 19/32" Plywood | Approved Insulation | 20 per 4' x 8' (1 per 1.6 sq. ft.) | IB SD #12 or HD #14, IB 3" Insulation Plate | IB Approved Low Rise Membrane Adhesive |
| Min. 19/32" Plywood | Approved Insulation | 24 per 4' x 8' (1 per 1.3 sq. ft.) | IB SD #12 or HD #14, IB 3" Insulation Plate | IB Approved Low Rise Membrane Adhesive |

¹Existing Roof: APP or SBS modified bitumen, smooth or granule surfaced asphaltic built-up roof, or single-ply membrane (CPA, CSPE, EPDM, PVC, or TPO).

²Approved Insulation: IB Energy Board II or III, or IB Approved UL Classified Polyisocyanurate.

³The use of some IB Approved Insulations may not achieve UL Classification.

⁴Approved Low Rise Membrane Adhesive: IB Rapid Set ECO₂ Spray Foam, Millennium PG-1 EF ECO₂ Adhesive.

System Uplift Note(s): ****Refer to applicable Approval Guide for System Code and/or FM Approvals Information. ***Refer to Substrate Resistance Table for required pull-out values.**

For additional information about IB Roof Systems requirements, recommendations, installation details, approvals, and limitations for the above assemblies, please refer to the latest edition of the IB Roof Systems Specifications Manual. For Technical Services please contact IB Technical Department at 800-426-1626.

| Membranes: | | Membrane Color: | | Warranty Length ^{**} | | | Warranty Type ^{**} | |
|-----------------------------------|--------|-----------------|---------|---|---------------------------------------|--|--|--|
| IB TPO FB 115 Mil | White* | 10 Year | 15 Year | 20 Year | Contractor Warranty Only | | | |
| IB TPO FB 135 Mil | White* | 10 Year | 15 Year | 20 Year | Total Systems - No Dollar Limit (TSW) | | | |
| *Meets CRRC, Title 24, LEED (SRI) | | | | **Refer to Warranty Selection Guide for Warranty Riders, Term Length Limitations, and eligibility requirements of the IB Warranty Program | | | Warranty Plus (WP) | |
| | | | | | | | Commercial Limited Material Warranty (CLMW) | |
| | | | | | | | Residential Limited Material Warranty (RLMW) | |

| | |
|---------------|---------------|
| Submitted By: | Project Name: |
| Company Name: | Address: |
| Email/Phone: | City/State: |

Adhered TPO Membrane (SP) - Insulation (RB) - Existing Roof - Wood Deck (Recover)

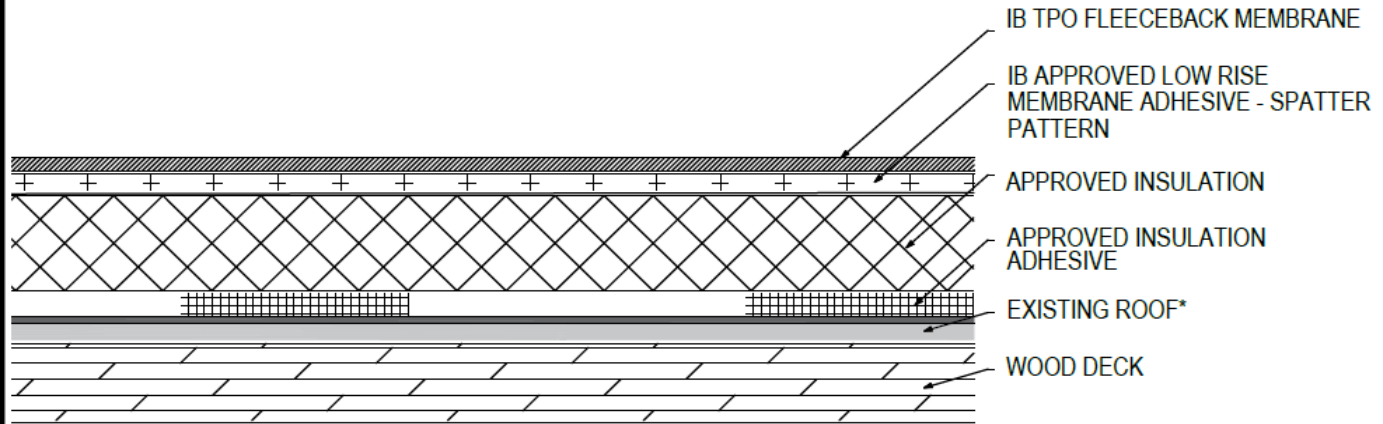

| Deck Type | Insulation (over Existing Roof) ¹ | | | IB Membrane Securement ^{**} |
|---------------------|--|----------------------------------|---------------------------------------|--|
| | Type ^{2,3} | Insulation Adhesive ⁴ | Pattern | |
| Min. 7/16" OSB | Approved Insulation | Approved Insulation Adhesive | Min. Four Continuous Ribbons, 12" oc. | IB Approved Low Rise Membrane Adhesive |
| Min. 1/2" Plywood | Approved Insulation | Approved Insulation Adhesive | Min. Four Continuous Ribbons, 12" oc. | IB Approved Low Rise Membrane Adhesive |
| Min. 19/32" Plywood | Approved Insulation | Approved Insulation Adhesive | Min. Four Continuous Ribbons, 12" oc. | IB Approved Low Rise Membrane Adhesive |

¹Existing Roof: APP or SBS modified bitumen, smooth or granule surfaced asphaltic built-up roof only.
²Approved Insulation: IB Energy Board II or III, or IB Approved UL Classified Polyisocyanurate.
³The use of some IB Approved Insulations may not achieve UL Classification.
⁴Approved Insulation Adhesive: Rapid Set Adhesive, Rapid Set PG Foam, Rapid Set ECO Spray Foam, Rapid Set ECO₂ Spray Foam, Millennium One Step, Millennium PG-1 SAF Pump Grade, Millennium PG-1 EF ECO, Millennium PG-1 EF ECO₂, OB500 Adhesive Fastener, OB500 Cannister, or TruFast Roofing Adhesive.
⁵Approved Low Rise Membrane Adhesive: IB Rapid Set ECO₂ Spray Foam, Millennium PG-1 EF ECO₂ Adhesive.
 System Uplift Note(s): **Refer to applicable Approval Guide for System Code and/or FM Approvals Information. ***Refer to Substrate Resistance Table for required pull-out values.

For additional information about IB Roof Systems requirements, recommendations, installation details, approvals, and limitations for the above assemblies, please refer to the latest edition of the IB Roof Systems Specifications Manual. For Technical Services please contact IB Technical Department at 800-426-1626.

| Membranes: | | Membrane Color: | | Warranty Length ^{**} | | | | Warranty Type ^{**} | |
|-----------------------------------|--|-----------------|--|-------------------------------|---------|---------|--|---------------------------------------|--|
| IB TPO FB 115 Mil | | White* | | 10 Year | 15 Year | 20 Year | | Contractor Warranty Only | |
| IB TPO FB 135 Mil | | White* | | 10 Year | 15 Year | 20 Year | | Total Systems - No Dollar Limit (TSW) | |
| *Meets CRRC, Title 24, LEED (SRI) | | | | | | | | | Warranty Plus (WP) |
| | | | | | | | | | Commercial Limited Material Warranty (CLMW) |
| | | | | | | | | | Residential Limited Material Warranty (RLMW) |

^{**}Refer to Warranty Selection Guide for Warranty Riders, Term Length Limitations, and eligibility requirements of the IB Warranty Program

| | | | |
|---------------|--|---------------|--|
| Submitted By: | | Project Name: | |
| Company Name: | | Address: | |
| Email/Phone: | | City/State: | |

Adhered TPO Membrane (SP) - Existing Roof (MB) - Wood Deck (Recover)

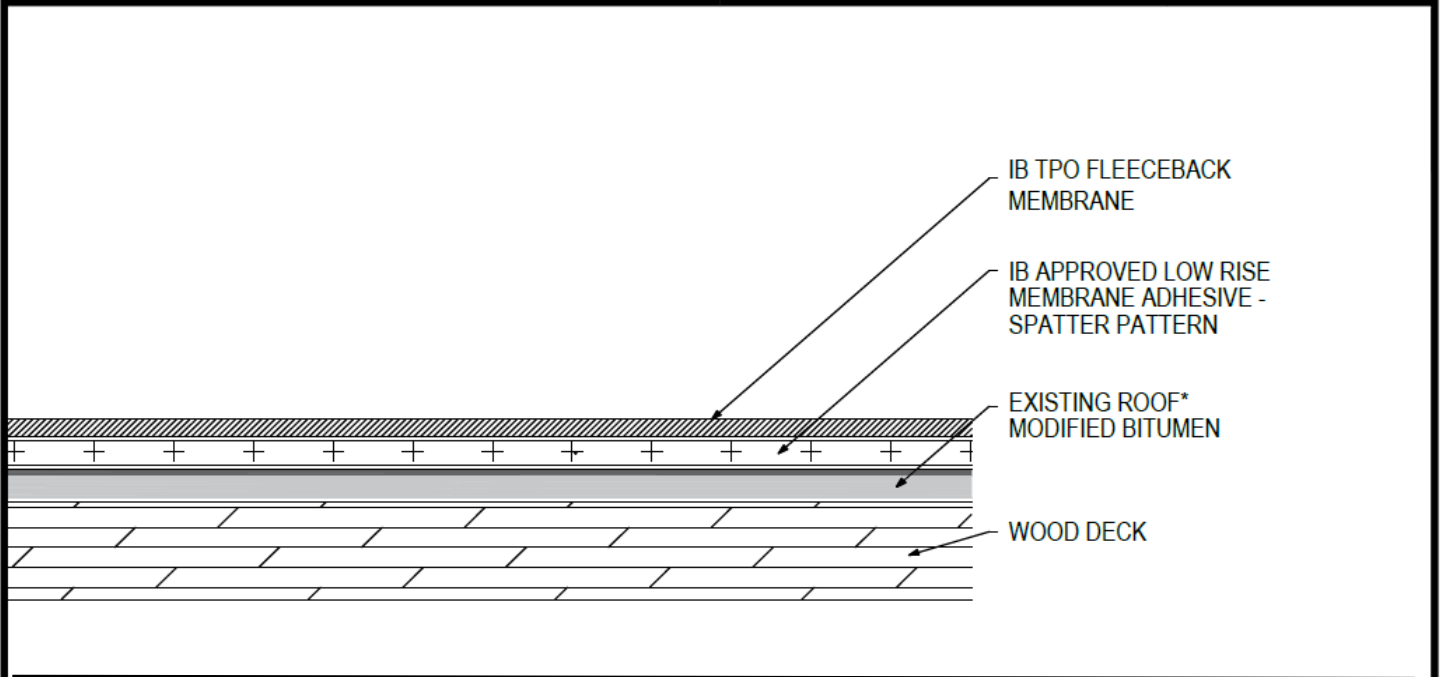

| Deck Type | IB TPO Fleeceback Membrane (over Existing Modified Bitumen Roof) | |
|---------------------|--|--|
| | Type ¹ | Attachment ^{2,3} |
| Min. 7/16" OSB | Existing Modified Bitumen Roof | IB Approved Low Rise Membrane Adhesive |
| Min. 1/2" Plywood | Existing Modified Bitumen Roof | IB Approved Low Rise Membrane Adhesive |
| Min. 19/32" Plywood | Existing Modified Bitumen Roof | IB Approved Low Rise Membrane Adhesive |

¹Existing Roof: APP or SBS modified bitumen, smooth or granule surfaced roof only.

²Approved Low Rise Membrane Adhesive: IB Rapid Set ECO₂ Spray Foam, Millennium PG-1 EF ECO₂ Adhesive.

³The use of some IB Approved Low Rise Membrane Adhesives may not achieve UL Classification.

System Uplift Note(s): **Refer to applicable Approval Guide for System Code and/or FM Approvals Information. ***Refer to Substrate Resistance Table for required pull-out values.

For additional information about IB Roof Systems requirements, recommendations, installation details, approvals, and limitations for the above assemblies, please refer to the latest edition of the IB Roof Systems Specifications Manual. For Technical Services please contact IB Technical Department at 800-426-1626.

| Membranes: | | Membrane Color: | | Warranty Length** | | | | Warranty Type** | |
|-----------------------------------|--|-----------------|--|---|---------|---------|--|--|---|
| IB TPO FB 115 Mil | | White* | | 10 Year | 15 Year | 20 Year | | Contractor Warranty Only | |
| IB TPO FB 135 Mil | | White* | | 10 Year | 15 Year | 20 Year | | Total Systems - No Dollar Limit (TSW) | |
| *Meets CRRC, Title 24, LEED (SRI) | | | | **Refer to Warranty Selection Guide for Warranty Riders, Term Length Limitations, and eligibility requirements of the IB Warranty Program | | | | | Warranty Plus (WP) |
| | | | | | | | | | Commercial Limited Material Warranty (CLMW) |
| | | | | | | | | Residential Limited Material Warranty (RLMW) | |

| | | | |
|---------------|--|---------------|--|
| Submitted By: | | Project Name: | |
| Company Name: | | Address: | |
| Email/Phone: | | City/State: | |

Adhered TPO Membrane (SP) - Existing Roof (SA) - Wood Deck (Recover)

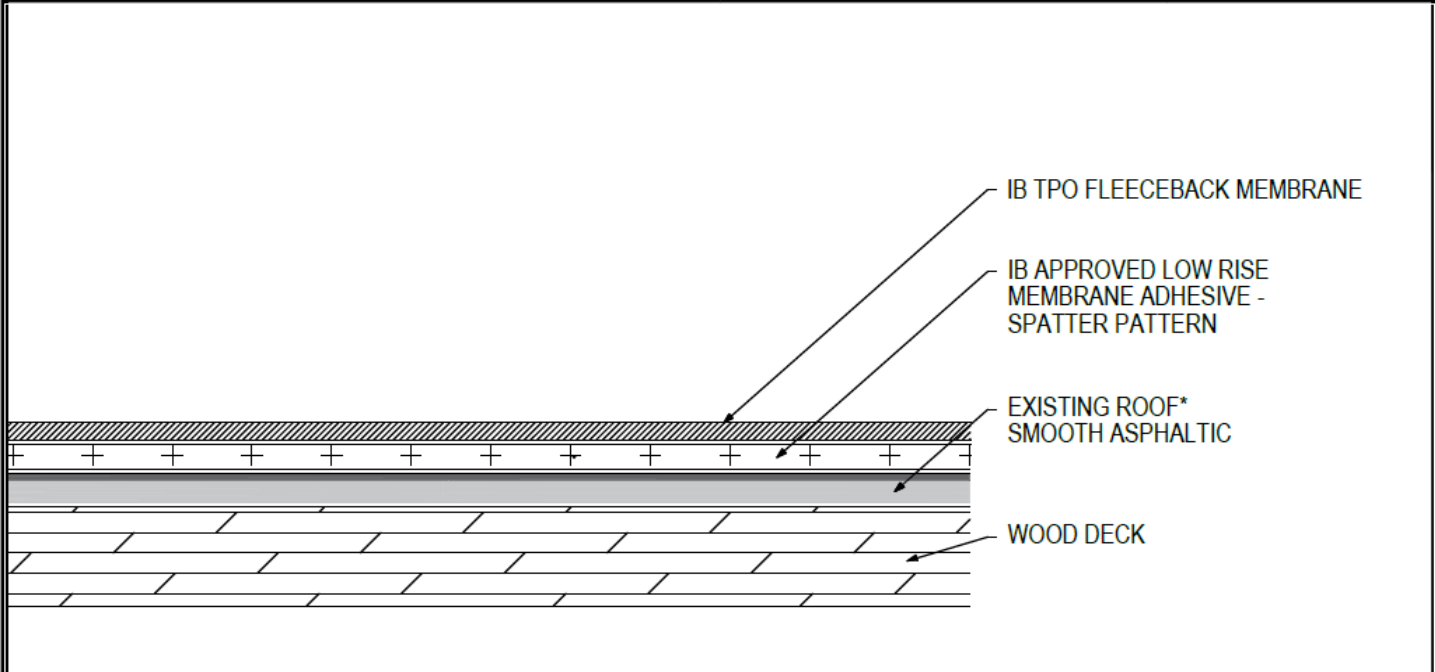

| Deck Type | IB TPO Fleeceback Membrane (over Existing Smooth Asphaltic Roof) | |
|---------------------|--|--|
| | Type ¹ | Attachment ^{2,3} |
| Min. 7/16" OSB | Existing Smooth Asphaltic Roof | IB Approved Low Rise Membrane Adhesive |
| Min. 1/2" Plywood | Existing Smooth Asphaltic Roof | IB Approved Low Rise Membrane Adhesive |
| Min. 19/32" Plywood | Existing Smooth Asphaltic Roof | IB Approved Low Rise Membrane Adhesive |

¹Existing Roof: APP or SBS modified bitumen, smooth or granule surfaced asphaltic built-up roof only.

²Approved Low Rise Membrane Adhesive: IB Rapid Set ECO₂ Spray Foam, Millennium PG-1 EF ECO₂ Adhesive.

³The use of some IB Approved Low Rise Membrane Adhesives may not achieve UL Classification.

System Uplift Note(s): **Refer to applicable Approval Guide for System Code and/or FM Approvals Information. ***Refer to Substrate Resistance Table for required pull-out values.

For additional information about IB Roof Systems requirements, recommendations, installation details, approvals, and limitations for the above assemblies, please refer to the latest edition of the IB Roof Systems Specifications Manual. For Technical Services please contact IB Technical Department at 800-426-1626.

| Membranes: | | Membrane Color: | | Warranty Length** | | | | Warranty Type** | |
|-----------------------------------|--|-----------------|--|---|---------|---------|--|---------------------------------------|--|
| IB TPO FB 115 Mil | | White* | | 10 Year | 15 Year | 20 Year | | Contractor Warranty Only | |
| IB TPO FB 135 Mil | | White* | | 10 Year | 15 Year | 20 Year | | Total Systems - No Dollar Limit (TSW) | |
| *Meets CRRC, Title 24, LEED (SRI) | | | | **Refer to Warranty Selection Guide for Warranty Riders, Term Length Limitations, and eligibility requirements of the IB Warranty Program | | | | | Warranty Plus (WP) |
| | | | | | | | | | Commercial Limited Material Warranty (CLMW) |
| | | | | | | | | | Residential Limited Material Warranty (RLMW) |
| Submitted By: | | | | Project Name: | | | | | |
| Company Name: | | | | Address: | | | | | |
| Email/Phone: | | | | City/State: | | | | | |