

**Adhered TPO Membrane (SP) - Lightweight Insulating Concrete - Concrete Deck (New)**

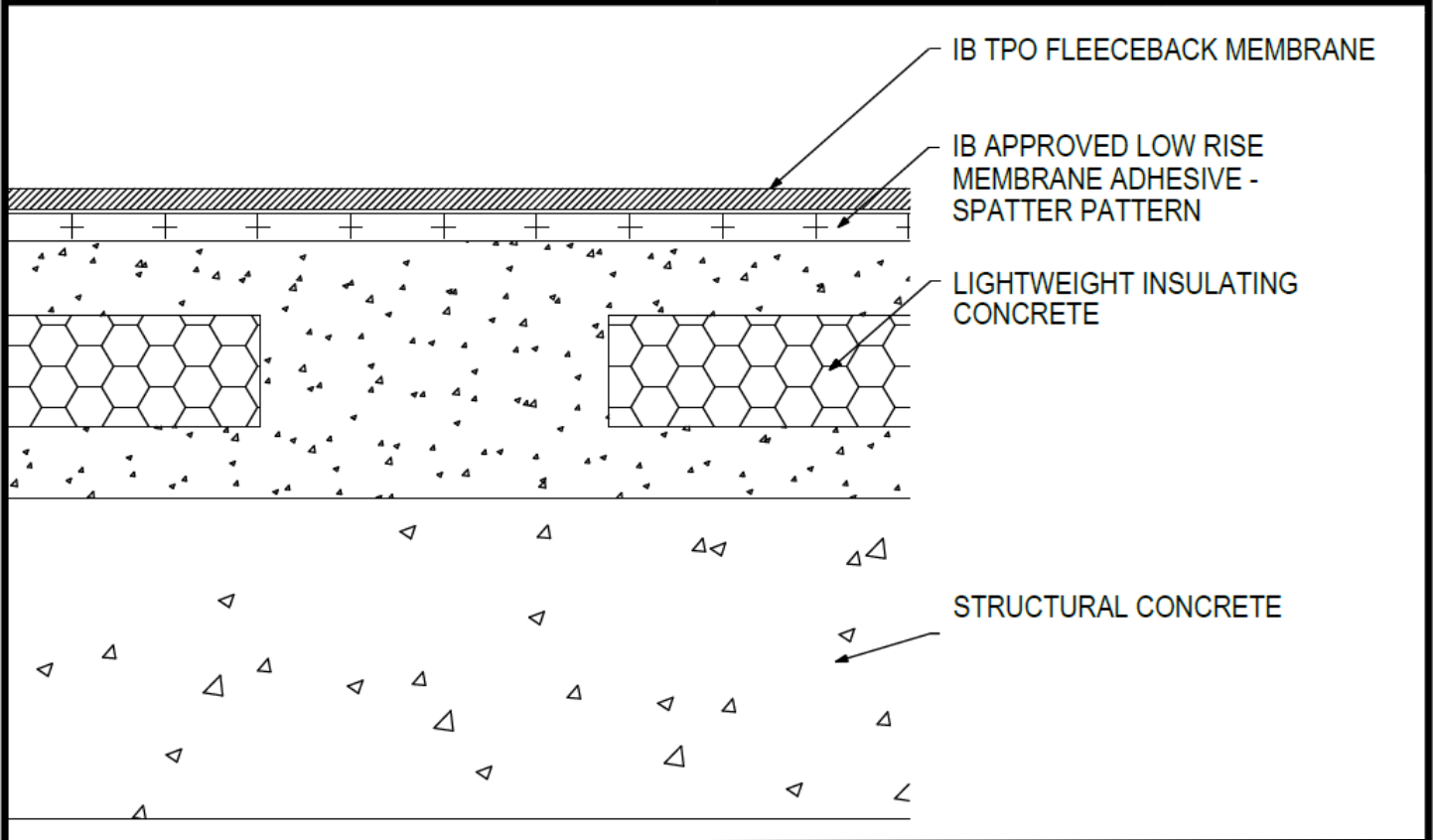

Deck Type <sup>1</sup>		IB TPO Fleeceback Membrane Attachment <sup>2,3</sup>
Sub-Deck	Top Deck	
Structural Concrete	Lightweight Concrete	IB Approved Low Rise Membrane Adhesive

<sup>1</sup>**Approved Lightweight Concrete:** Celcore = Min. 200 psi, min. 2" thick Celcore Cellular Concrete over Structural Concrete, Elastizell = Min 200 psi, min 2" thick Elastizell Lightweight Insulating Concrete over Structural Concrete, Mearcrete = Min 200 psi, min. 2" thick Mearcrete over Structural Concrete.

<sup>2</sup>**Approved Low Rise Membrane Adhesive:** IB Rapid Set ECO<sub>2</sub> Spray Foam, Millennium PG-1 EF ECO<sub>2</sub> Adhesive.

<sup>3</sup>The use of some IB Approved Low Rise Membrane Adhesives may not achieve UL Classification.

**System Uplift Note(s):** \*\*Refer to applicable Approval Guide for System Code and/or FM Approvals Information. \*\*\*Refer to Substrate Resistance Table for required pull-out values.

For additional information about IB Roof Systems requirements, recommendations, installation details, approvals, and limitations for the above assemblies, please refer to the latest edition of the IB Roof Systems Specifications Manual. For Technical Services please contact IB Technical Department at 800-426-1626.

Membranes:		Membrane Color:		Warranty Length**				Warranty Type**	
IB TPO FB 115 Mil		White*		10 Year	15 Year	20 Year		Contractor Warranty Only	
IB TPO FB 135 Mil		White*		15 Year	20 Year	25 Year		Total Systems - No Dollar Limit (TSW)	
*Meets CRRC, Title 24, LEED (SRI)				**Refer to Warranty Selection Guide for Warranty Riders, Term Length Limitations, and eligibility requirements of the IB Warranty Program					Warranty Plus (WP)
									Commercial Limited Material Warranty (CLMW)
									Residential Limited Material Warranty (RLMW)

Submitted By:		Project Name:	
Company Name:		Address:	
Email/Phone:		City/State:	

**Adhered TPO Membrane (SP) - Lightweight Insulating Concrete - Steel Sub Deck (New)**

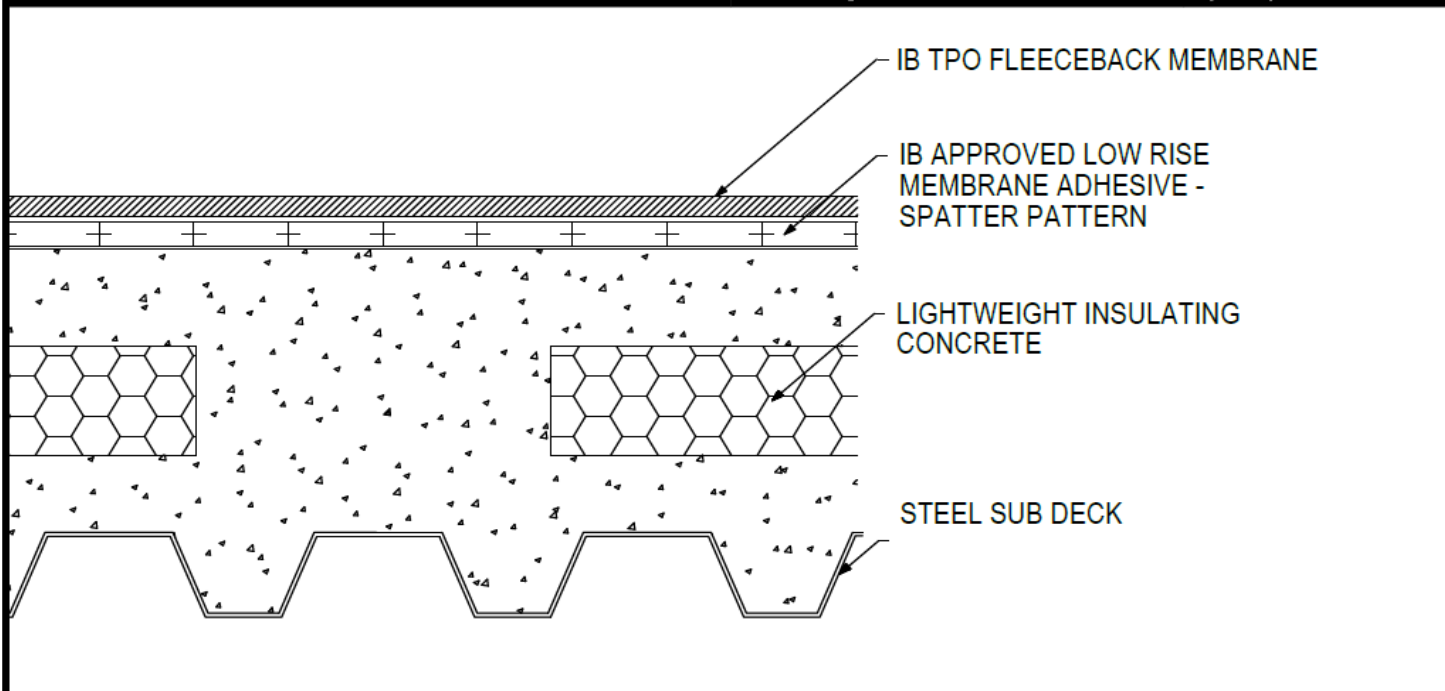

Deck Type <sup>1</sup>	IB TPO Fleeceback Membrane Attachment <sup>2,3</sup>
Lightweight Concrete / Steel	IB Approved Low Rise Membrane Adhesive

<sup>1</sup>Approved Lightweight Concrete: Celcore = Min. 200 psi, min. 2" thick Celcore Cellular Concrete over Structural Concrete, Elastizell = Min 200 psi, min 2" thick Elastizell Lightweight Insulating Concrete over Structural Concrete, Mearcrete = Min 200 psi, min. 2" thick Mearcrete over Structural Concrete.

<sup>2</sup>Approved Low Rise Membrane Adhesive: IB Rapid Set ECO<sub>2</sub> Spray Foam, Millennium PG-1 EF ECO<sub>2</sub> Adhesive.

<sup>3</sup>The use of some IB Approved Low Rise Membrane Adhesives may not achieve UL Classification.

System Uplift Note(s): \*\*Refer to applicable Approval Guide for System Code and/or FM Approvals Information. \*\*\*Refer to Substrate Resistance Table for required pull-out values.

For additional information about IB Roof Systems requirements, recommendations, installation details, approvals, and limitations for the above assemblies, please refer to the latest edition of the IB Roof Systems Specifications Manual. For Technical Services please contact IB Technical Department at 800-426-1626.

Membranes:	Membrane Color:	Warranty Length**			Warranty Type**
IB TPO FB 115 Mil	White*	10 Year	15 Year	20 Year	Contractor Warranty Only
IB TPO FB 135 Mil	White*	15 Year	20 Year	25 Year	Total Systems - No Dollar Limit (TSW)
*Meets CRRC, Title 24, LEED (SRI)		**Refer to Warranty Selection Guide for Warranty Riders, Term Length Limitations, and eligibility requirements of the IB Warranty Program			Warranty Plus (WP)
					Commercial Limited Material Warranty (CLMW)
					Residential Limited Material Warranty (RLMW)

Submitted By:	Project Name:
Company Name:	Address:
Email/Phone:	City/State: