

Adhered TPO Membrane - Cover Board (MA) - Existing Roof - Gypsum Deck (Recover)

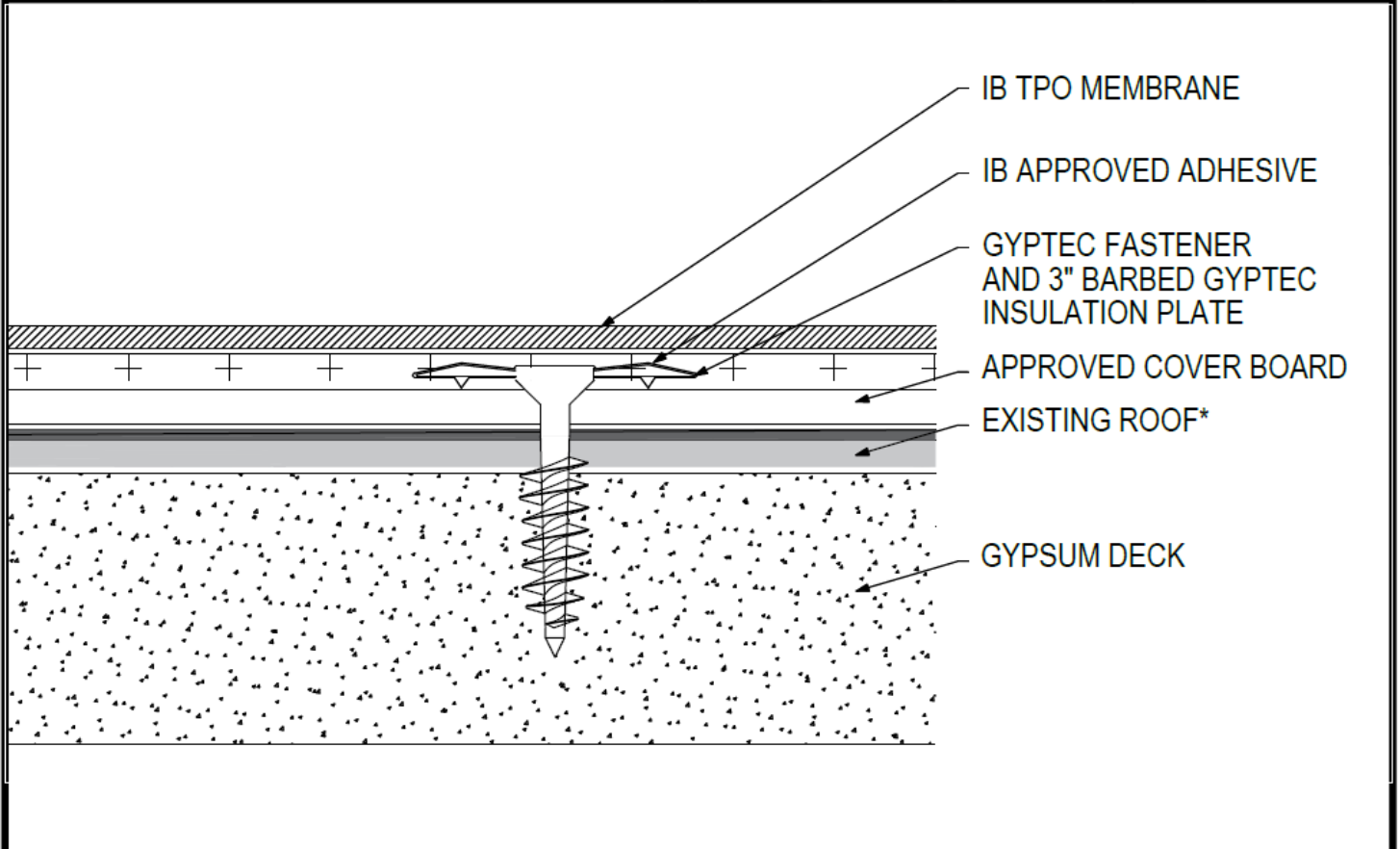

Deck Type	Cover Board (over Existing Roof) ¹			IB Membrane Securement ^{**}
	Type ^{2,3}	Attachment	Fastener/Plate ^{***}	Attachment ⁴
Poured Gypsum	Approved Cover Board	12 per 4' x 8' (1 per 2.67 sq. ft.)	GypTec or Deklite, 3" Insulation Plate	IB Approved Adhesive
Poured Gypsum	Approved Cover Board	16 per 4' x 8' (1 per 2.0 sq. ft.)	GypTec or Deklite, 3" Insulation Plate	IB Approved Adhesive
Poured Gypsum	Approved Cover Board	20 per 4' x 8' (1 per 1.6 sq. ft.)	GypTec or Deklite, 3" Insulation Plate	IB Approved Adhesive ^o
Poured Gypsum	Approved Cover Board	24 per 4' x 8' (1 per 1.3 sq. ft.)	GypTec or Deklite, 3" Insulation Plate	IB Approved Adhesive

¹Existing Roof: APP or SBS modified bitumen, smooth or granule surfaced asphaltic built-up roof, or single-ply membrane (CPA, CSPE, EPDM, PVC, or TPO).
²Approved Cover Board: DensDeck Prime, DensDeck ProFast Prime, DensDeck StormX Prime, Securock Ultralight Coated Glass-Mat, Securock Gypsum Fiber Board, or DEXcell FA Glass Mat Roof Board, minimum 1/4" thickness; or minimum 7/16" DEXcell Cement Roof Board; or minimum 1/2" IB HD ISO-J, or 1/2" IB Recovery Energy Board III-J.
³The use of some IB Approved Cover Boards may not achieve UL Classification.
⁴Approved Adhesive: IB TPO Water Based Adhesive, IB TPO Bonding Adhesive, IB TPO LVOC Adhesive, IB TPO CA LVOC Adhesive, or IB TPO Spray Contact Adhesive.
Note: IB TPO Bonding Adhesive, IB TPO LVOC Adhesive and IB TPO CA LVOC Adhesive cannot be used with IB TPO FB Membranes.
System Uplift Note(s): **Refer to applicable Approval Guide for System Code and/or FM Approvals Information. *Refer to Substrate Resistance Table for required pull-out values.**
For additional information about IB Roof Systems requirements, recommendations, installation details, approvals, and limitations for the above assemblies, please refer to the latest edition of the IB Roof Systems Specifications Manual. For Technical Services please contact IB Technical Department at 800-426-1626.

Membranes:	Membrane Color:	Warranty Length ^{**}			Warranty Type ^{**}
IB TPO SM 60 Mil	White* Gray Tan	10 Year	15 Year	20 Year	Contractor Warranty Only Total Systems - No Dollar Limit (TSW) Warranty Plus (WP) Commercial Limited Material Warranty (CLMW) Residential Limited Material Warranty (RLMW)
IB TPO SM 80 Mil	White* Gray Tan	10 Year	15 Year	20 Year	
IB TPO FB 115 Mil	White*	10 Year	15 Year	20 Year	
IB TPO FB 135 Mil	White*	10 Year	15 Year	20 Year	

*Meets CRRC, Title 24, LEED (SRI)

**Refer to Warranty Selection Guide for Warranty Riders, Term Length Limitations, and eligibility requirements of the IB Warranty Program

Submitted By:	Project Name:
Company Name:	Address:
Email/Phone:	City/State: