

# PMMA Flashing Roof Drains

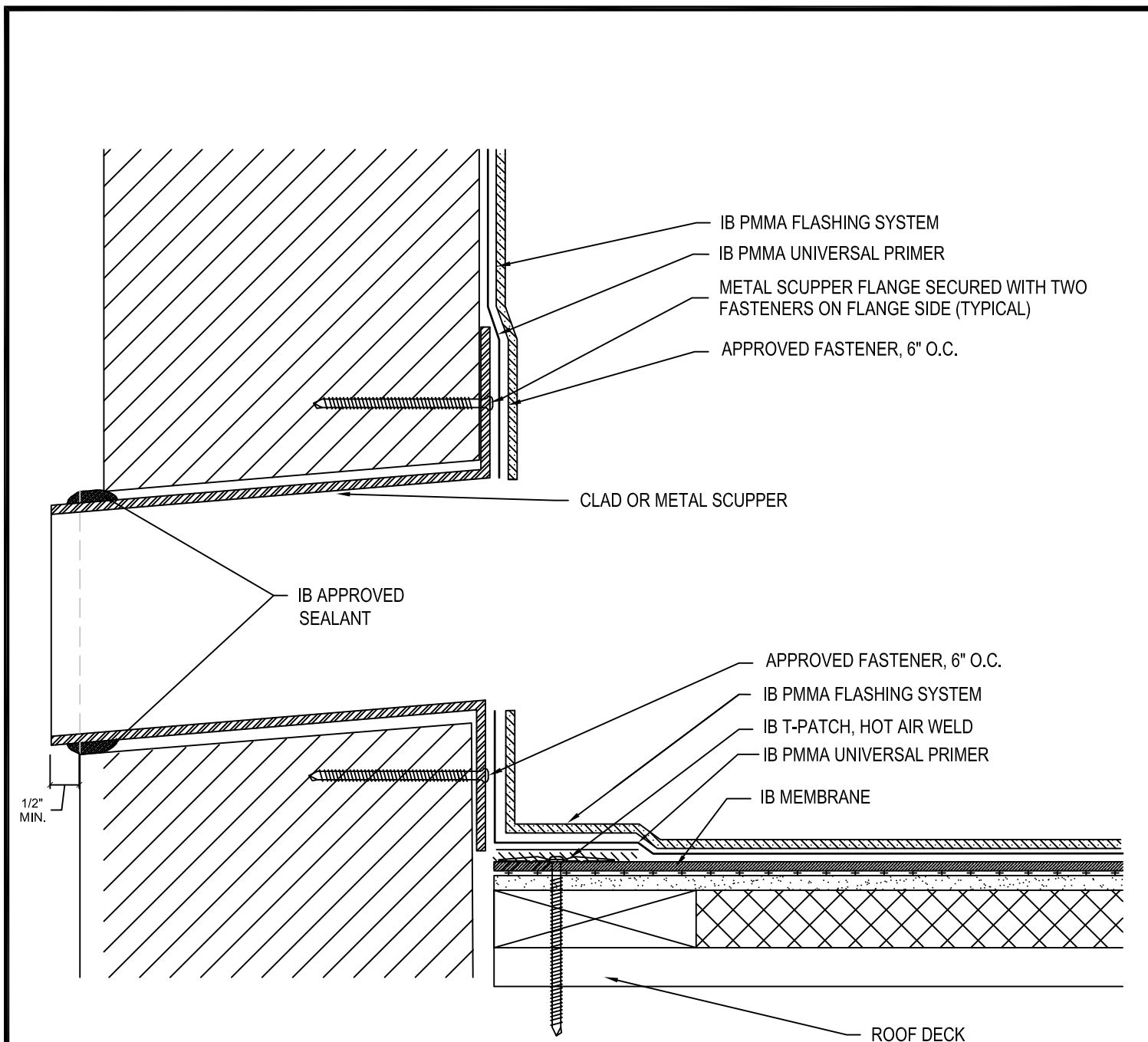

**NOTES:**

1. METAL SCUPPERS TO BE FASTENED AT DECK & WALL FLANGE WITH IB FASTENERS, MINIMUM 2 FASTENERS PER FLANGE.
2. METAL SCUPPERS TO BE ANGLED DOWN TO DIRECT WATER.
3. METAL TO BE PRIMED WITH A 10 MIL APPLICATION OF IB PMMA UNIVERSAL PRIMER.
4. REFER TO PM-FD-01 FOR STANDARD PMMA FLASHING DETAIL CONSTRUCTION.
5. REFER TO PM-FD-02 FOR TWO-PLY PMMA FLASHING APPLICATION FOR EXTENDED WARRANTY ELIGIBILITY.
6. MEMBRANE FASTENERS SHALL BE COVERED WITH AN ADDITIONAL LAYER OF IB MEMBRANE OR IB T-PATCH.
7. SEALANT REQUIRES PERIODIC OWNER MAINTENANCE.

|   |   |                                   |
|---|---|-----------------------------------|
| Scale:<br>NTS                           | Detail Name:<br><b>IB PMMA Flashing At Metal Overflow Scupper</b> | Detail Number:<br><b>PM-RD-04</b> |
| Submitted By:<br>Address:<br>Telephone: |   | Project:<br>Address:              |