

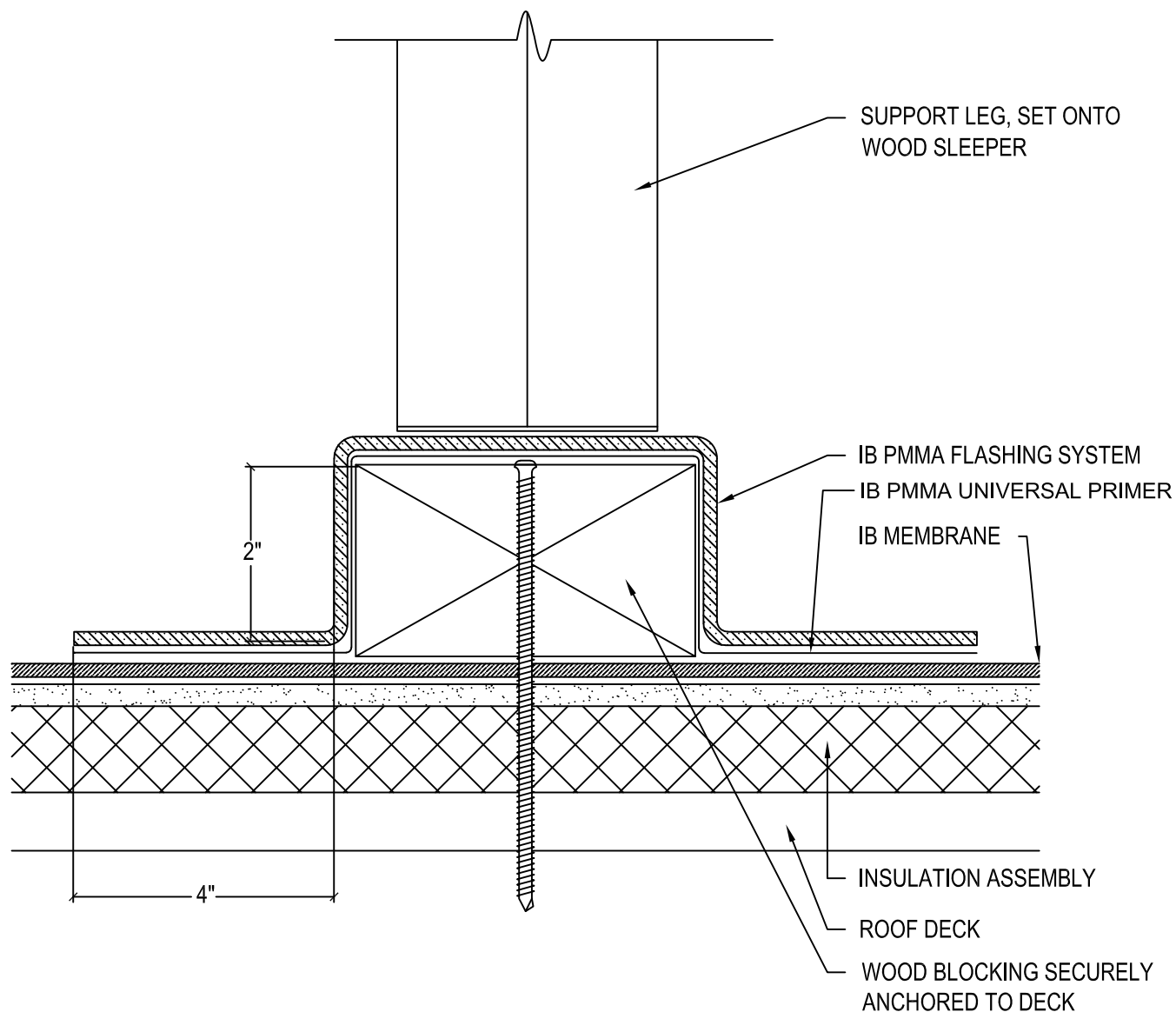

# PMMA Penetrations



## NOTES:

1. THE ABOVE DETAIL CAN BE USED FOR LIGHTWEIGHT EQUIPMENT OR DUCT SUPPORTS. INSTALL ADDITIONAL BLOCKING BELOW MEMBRANE WHERE NEEDED TO SUPPORT EXPECTED LOADS.
2. REFER TO PM-FD-01 FOR STANDARD PMMA FLASHING DETAIL CONSTRUCTION.
3. REFER TO PM-FD-02 FOR TWO-PLY PMMA FLASHING APPLICATION FOR EXTENDED WARRANTY ELIGIBILITY.

Scale: NTS	Detail Name: <b>PMMA Flashing At Support Curb</b>	Detail Number: <b>PM-PS-04</b>
Submitted By: Address: Telephone:	Project: Address:	