

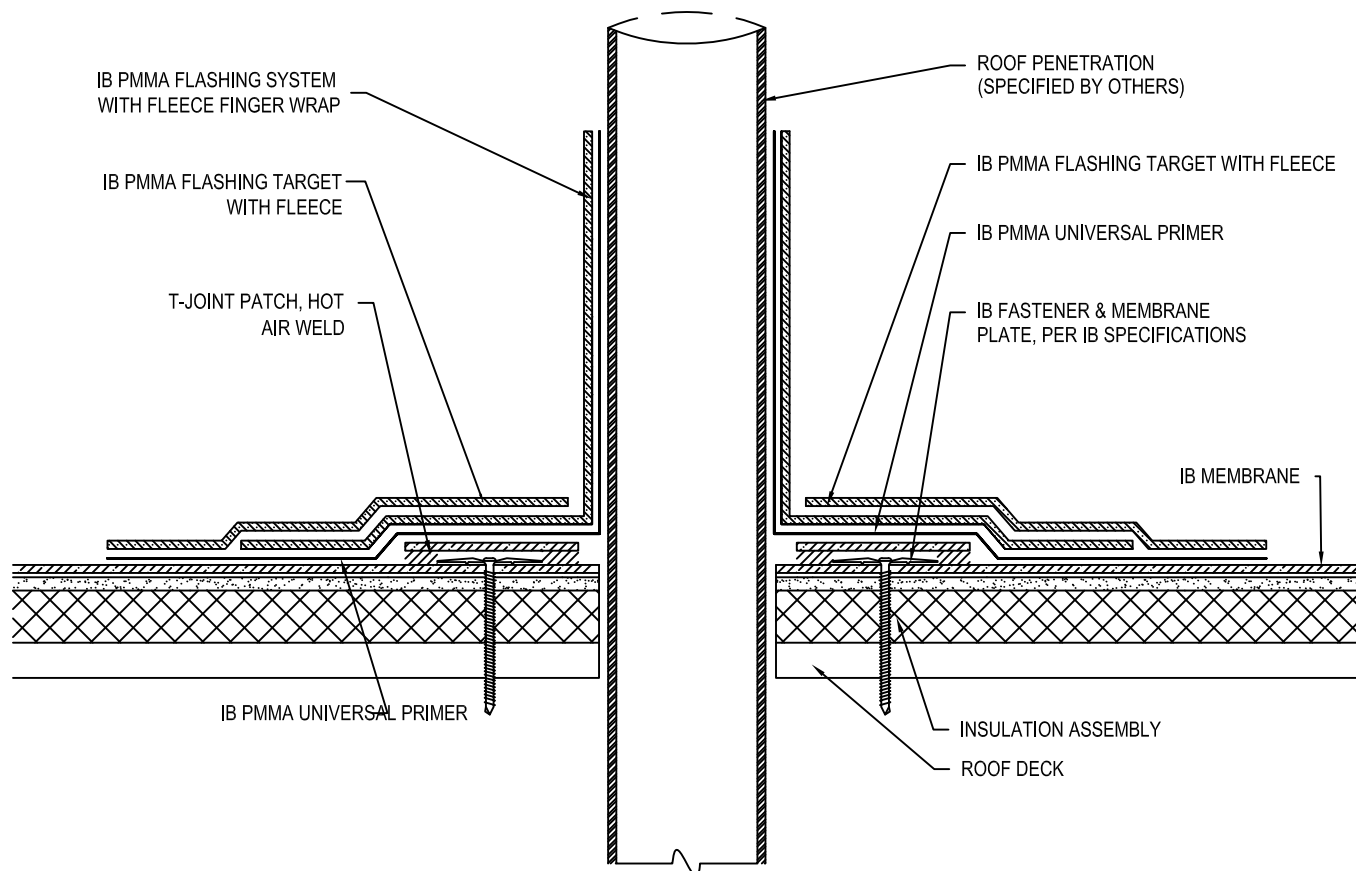

PMMA Penetrations

NOTES:

1. PIPE AND IB MEMBRANE ARE TO BE PRIMED WITH 10 MIL APPLICATION OF IB PMMA UNIVERSAL PRIMER.
2. EXTEND IB PMMA FLEECE A MINIMUM OF 4" VERTICALLY AND FINGERS A MINIMUM OF 2" BEYOND PENETRATION.
3. INSTALL IB PMMA TARGET FLEECE OVER PMMA FLEECE FINGERS.
4. REFER TO PM-FD-01 FOR STANDARD PMMA FLASHING DETAIL CONSTRUCTION.
5. REFER TO PM-FD-02 FOR TWO-PLY PMMA FLASHING APPLICATION FOR EXTENDED WARRANTY ELIGIBILITY.
6. MEMBRANE FASTENERS SHALL BE COVERED WITH AN ADDITIONAL LAYER OF IB MEMBRANE OR IB T-PATCH.

Scale: NTS	Detail Name: PMMA Flashing At Pipe Penetration	Detail Number: PM-PS-01
Submitted By: Address: Telephone:		Project: Address: