

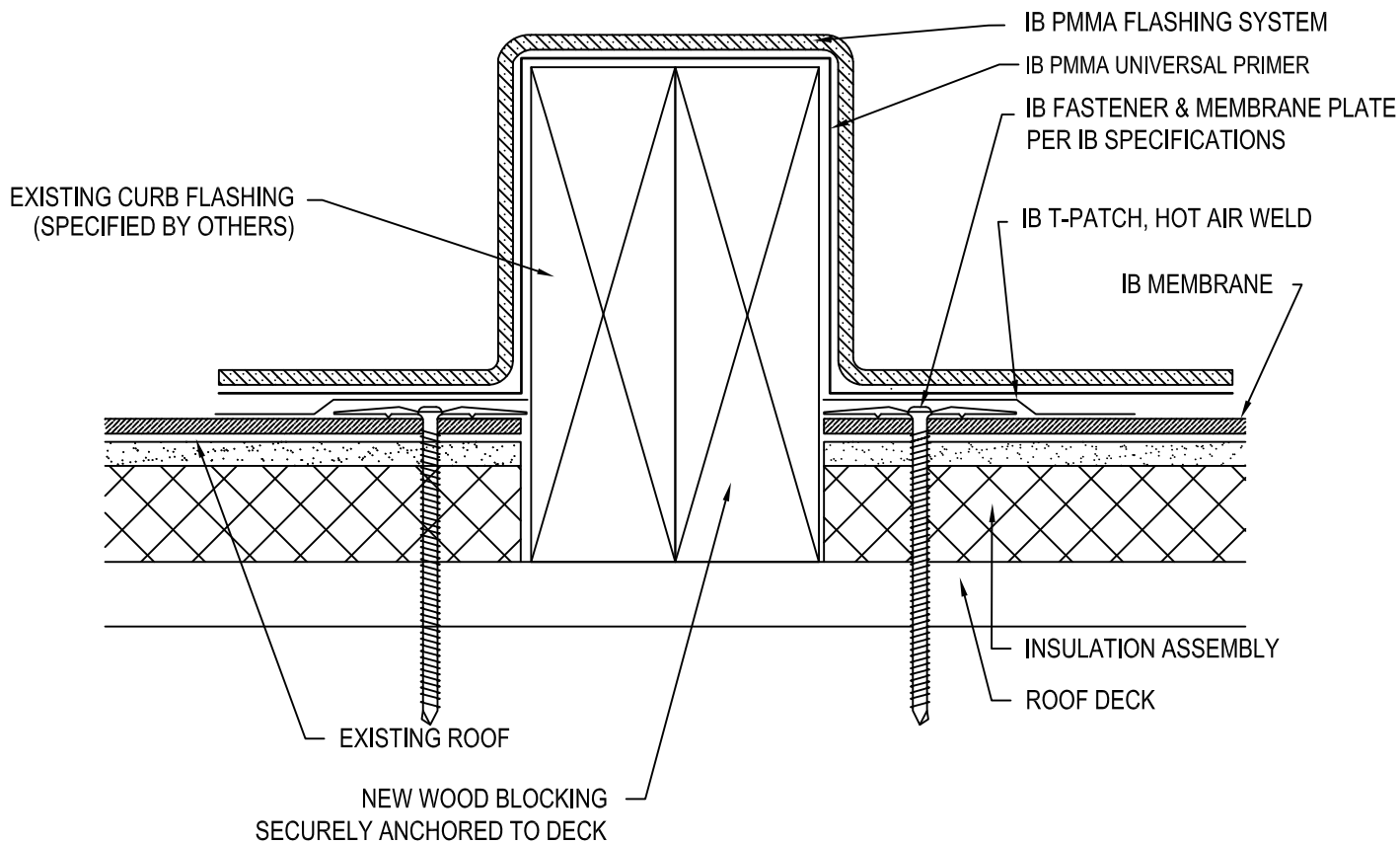

PMMA Dividers

NOTES:

1. PMMA STANDARD FLASHING HEIGHT IS MIN. 4" ABOVE THE ROOF. EXTEND HEIGHT AS NECESSARY TO WATERPROOF THE CONDITION.
2. REFER TO PM-FD-01 FOR STANDARD PMMA FLASHING DETAIL CONSTRUCTION.
3. REFER TO PM-FD-02 FOR TWO-PLY PMMA FLASHING APPLICATION FOR EXTENDED WARRANTY ELIGIBILITY.
4. MEMBRANE FASTENERS SHALL BE COVERED WITH AN ADDITIONAL LAYER OF IB MEMBRANE OR IB T- PATCH.

 Scale:
 NTS

 Detail Name: **PMMA Fashing At Area Divider / Equip Curb**

 Detail Number:
PM-XD-02

Submitted By:

 Address:
 Telephone:

Project:

Address: