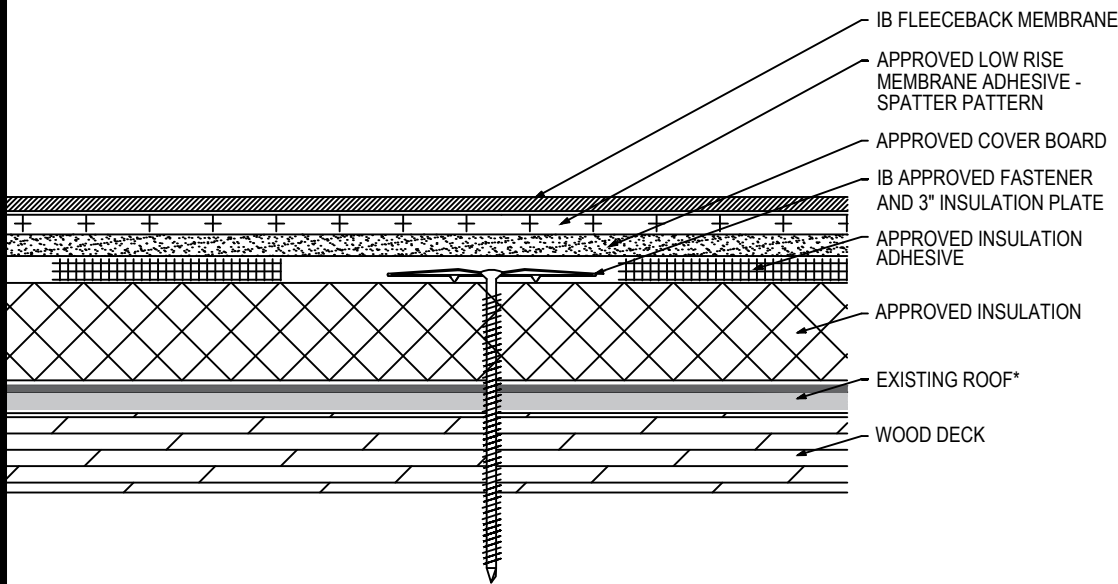

Fully Adhered Membrane (SP) - Cover Board (RB) - Insulation (MA) - Existing Roof - Wood Deck (Recover)

Fire Rating / Max. Slope	Deck Type	Insulation (over Existing Roof)			Cover Board			IB Fleeceback Membrane Attachment	Max. Design Pressure**
		Type	Attachment	Fasteners	Type	Insulation Adhesive	Pattern		
<input type="checkbox"/> Not Rated	7/16" OSB	Approved Insulation	16 per 4' x 8' (1 per 2 sq. ft.)	Min. IB SD #12 or HD #14, 3" IB Insulation Plate	Min. Approved 1/4" Cover Board	BM, CR20, OB500, OSFA, PG1, or RSIA	Four continuous ribbons, 12" o.c.	CR-20 Spatter Pattern 3.75 lbs/square	Minimum Req. for IB Warranty
<input type="checkbox"/> Not Rated	1/2" Plywood	Approved Insulation	10 per 4' x 8' (1 per 3.2 sq. ft.)	Min. IB SD #12 or HD #14, 3" IB Insulation Plate	Min. Approved 1/4" Cover Board	BM, CR20, OB500, OSFA, PG1, or RSIA	Four continuous ribbons, 12" o.c.	CR-20 Spatter Pattern 3.75 lbs/square	Minimum Req. for IB Warranty
<input type="checkbox"/> Maintains Existing Unlimited	1/2" Plywood	Min. 1.5" Approved Insulation	20 per 4' x 8' (1 per 1.6 sq. ft.)	Min. IB SD #12 or HD #14, 3" IB Insulation Plate	Min. Approved 1/4" Cover Board	BM, CR20, OB500, OSFA, PG1, or RSIA	Four continuous ribbons, 12" o.c.	CR-20 Spatter Pattern 3.75 lbs/square	-45.0 psf (Class 90)
<input type="checkbox"/> Maintains Existing Unlimited	19/32" Plywood	Min. 1.5" Approved Insulation	24 per 4' x 8' (1 per 1.3 sq. ft.)	Min. IB XHD #15, 3" IB Insulation Plate	Min. Approved 1/4" Cover Board	BM, CR20, OB500, OSFA, PG1, or RSIA	Four continuous ribbons, 12" o.c.	CR-20 Spatter Pattern 3.75 lbs/square	-75.0 psf (Class 150)
<input type="checkbox"/> Maintains Existing Unlimited	19/32" Plywood	Min. 1.5" Approved Insulation	24 per 4' x 8' (1 per 1.3 sq. ft.)	Min. IB XHD #15, 3" IB Insulation Plate	Min. Approved 1/4" Cover Board	BM, CR20, OB500, OSFA, PG1, or RSIA	Four continuous ribbons, 12" o.c.	CR-20 Spatter Pattern 3.75 lbs/square	-75.0 psf (Class 150)

Existing Roof: APP or SBS modified bitumen, smooth or granule surfaced asphaltic built-up roof, or single-ply membrane (CPA, CSPE, EPDM, PVC, or TPO)

Approved Insulation: IB Energy Board II or III, or IB Approved UL Classified Polyisocyanurate, IB Approved UL Classified Extruded Polystyrene, IB Approved UL Classified Extruded Polystyrene Insulation

Approved Cover Board: DensDeck Prime, Securock Gypsum Fiber Board, minimum 1/4" thickness; or minimum 1/2" IB HD ISO; or minimum 1/2" thick Structodek HD Primed

Approved Insulation Adhesive: BM = Polyset BoardMax, CR-20 = Polyset CR-20, OB500 = OlyBond 500 Adhesive Fastener, OSFA = Millennium One-Step Foamable Adhesive; PG-1 = Millennium PG-1 Pump Grade Adhesive; or RSIA = IB Rapid Set Insulation Adhesive; maximum bead spacing 12" o.c. unless otherwise indicated

Fire Classification Note(s): ¹Maintains existing with unlimited slope over any Class A, B or C UL Classified single ply membrane system, mechanically fastened or fully adhered, non-insulated or insulated when utilized with any of the following roof insulations: IB Energy Board II, IB Energy Board III, ACFoam II, ACFoam III or ACFoam-III HD Cover Board and any of the following gypsum cover boards: minimum 1/4" DensDeck Prime, Securock Ultralight Coated Glass-Mat, or DexCell FA Glass Mat Roof Board, or minimum 7/16" DexCell Cement Board with all joints staggered 6-in. from the plywood joints, mechanically attached or adhered. ²Maintains existing up to 1":12" slope over any Class A, B or C built up roof system when utilized with any of the following roof insulations: IB Energy Board II, IB Energy Board III, ACFoam II, ACFoam III or ACFoam-III HD Cover Board and any of the following gypsum cover boards: minimum 1/4" DensDeck Prime, Securock Ultralight Coated Glass-Mat, or DexCell FA Glass Mat Roof Board, or minimum 7/16" DexCell Cement Board with all joints staggered 6-in. from the plywood joints, mechanically attached or adhered. ³Use of other IB Approved Insulations and/or IB Approved Cover Boards may not achieve UL Classification.

**** Refer to Substrate Resistance table for required pull-out values.**

For additional information about IB Roof Systems requirements, recommendations, installation details, approvals and limitations for the above assemblies, please refer to the latest edition of the IB Roof Systems Specifications Manual. For Technical Services please contact us at 800-426-1626.

Membranes:	Membrane Color:	Warranty Length***	Warranty Type***
<input type="checkbox"/> IB PVC Single-Ply FB 50 Mil	<input type="checkbox"/> White*	<input type="checkbox"/> 10 Year <input type="checkbox"/> 15 Year <input type="checkbox"/> 20 Year	<input type="checkbox"/> Total System - No Dollar Limit (NDL)
<input type="checkbox"/> IB PVC Single-Ply FB 60 Mil	<input type="checkbox"/> White*	<input type="checkbox"/> 15 Year <input type="checkbox"/> 20 Year <input type="checkbox"/> 25 Year	<input type="checkbox"/> Warranty Plus (WP)
<input type="checkbox"/> IB PVC Single-Ply FB 80 Mil	<input type="checkbox"/> White*	<input type="checkbox"/> 15 Year <input type="checkbox"/> 20 Year <input type="checkbox"/> 25 Year	<input type="checkbox"/> Commercial Limited Material Warranty (CLMW)
			<input type="checkbox"/> Residential Limited Material Warranty (RLMW)

* Meets CRRC, Title-24, & EnergyStar Standards

*** Refer to Warranty Selection Guide for Warranty Riders, Term Length Limitations, and eligibility requirements of the Warranty Program

Submitted By: Address: Email:	Project Name: Address:
----------------------------------------------------------	-----------------------------------------