

**Fully Adhered Membrane - Insulation (MA) - Vapor Barrier - Steel Deck (New or Tear-Off)**

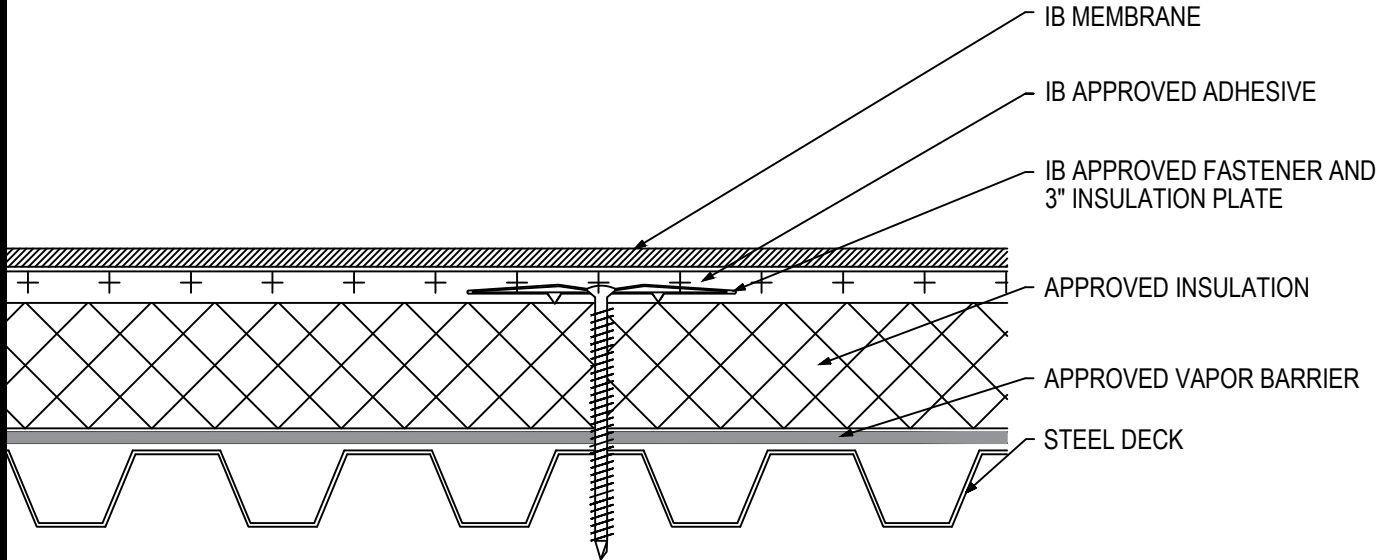

Fire Rating / Max. Slope	Deck Type	Insulation/Vapor Barrier			IB Membrane Attachment	Max. Design Pressure**
		Type	Attachment	Fasteners		
<input type="checkbox"/> Class "A" 1/2":12"	Min. 22 ga. Type B, Grade 33 Steel	Min. 2" Approved Insulation & Approved Vapor Barrier	8 per 4' x 8' (1 per 4.0 sq. ft.)	IB SD #12 or HD #14, IB 3" Insulation Plate	IB Approved Adhesive	Minimum Req. for IB Warranty
<input type="checkbox"/> Class "A" 1/2":12"	Min. 22 ga. Type B, Grade 33 Steel	Min. 1.5" Approved Insulation & Approved Vapor Barrier	10 per 4' x 8' (1 per 3.2 sq. ft.)	IB SD #12 or HD #14, IB 3" Insulation Plate	IB Approved Adhesive	Minimum Req. for IB Warranty
<input type="checkbox"/> Class "A" 1/2":12"	Min. 22 ga. Type B, Grade 33 Steel	Min. 1" Approved Insulation & Approved Vapor Barrier	12 per 4' x 8' (1 per 2.67 sq. ft.)	IB SD #12 or HD #14, IB 3" Insulation Plate	IB Approved Adhesive	Minimum Req. for IB Warranty

**Approved Vapor Barrier:** IB Barrier SA Membrane, SopraVap<sup>®</sup> SA, applied using self-adhesive techniques

**Approved Insulation:** IB EnergyBoard II or III, Atlas AC Foam II or III, H-Shield, or H-Shield CG

**Fire Classification Note(s):** <sup>1</sup>UL Class 'A' up to 1/2":12" when utilized with minimum 1" thickness H-Shield CG, or minimum 3" thickness AC Foam III or IB EnergyBoard III. <sup>2</sup>UL Class 'C' Classification with an unlimited slope when utilized with minimum 1" thickness H-Shield ISO or H-Shield CG. <sup>3</sup>Other IB Approved Insulations or lesser thicknesses may not achieve UL Classification.

\*\*Refer to Substrate Resistance Table for required pull-out values.

For additional information about IB Roof Systems requirements, recommendations, installation details, approvals and limitations for the above assemblies, please refer to the latest edition of the IB Roof Systems Specifications Manual. For Technical Services please contact us at 800-426-1626.

Membranes:	Membrane Color:	Warranty Length***	Warranty Type***
<input type="checkbox"/> IB PVC Single-Ply 50 Mil	<input type="checkbox"/> White* <input type="checkbox"/> Gray <input type="checkbox"/> Tan <input type="checkbox"/> Bronze <input type="checkbox"/> ChemGuard*	<input type="checkbox"/> 10 Year <input type="checkbox"/> 15 Year <input type="checkbox"/> 20 Year	<input type="checkbox"/> Total System - No Dollar Limit (NDL)
<input type="checkbox"/> IB PVC Single-Ply 60 Mil	<input type="checkbox"/> White* <input type="checkbox"/> Cool Sand* <input type="checkbox"/> Cool Stone* <input type="checkbox"/> Gray <input type="checkbox"/> Tan	<input type="checkbox"/> 15 Year <input type="checkbox"/> 20 Year <input type="checkbox"/> 25 Year	<input type="checkbox"/> Warranty Plus (WP)
<input type="checkbox"/> IB PVC Single-Ply 80 Mil	<input type="checkbox"/> White* <input type="checkbox"/> Gray <input type="checkbox"/> Tan <input type="checkbox"/> Bronze <input type="checkbox"/> ChemGuard*	<input type="checkbox"/> 20 Year <input type="checkbox"/> 25 Year <input type="checkbox"/> 30 Year	<input type="checkbox"/> Commercial Limited Material Warranty (CLMW)
			<input type="checkbox"/> Residential Limited Material Warranty (RLMW)

\* Meets CRRC, Title-24, & EnergyStar Standards

\*\*\* Refer to Warranty Selection Guide for Warranty Riders, Term Length Limitations, and eligibility requirements of the Warranty Program

**Submitted By:**

**Address:**

**Email:**

**Project Name:**

**Address:**