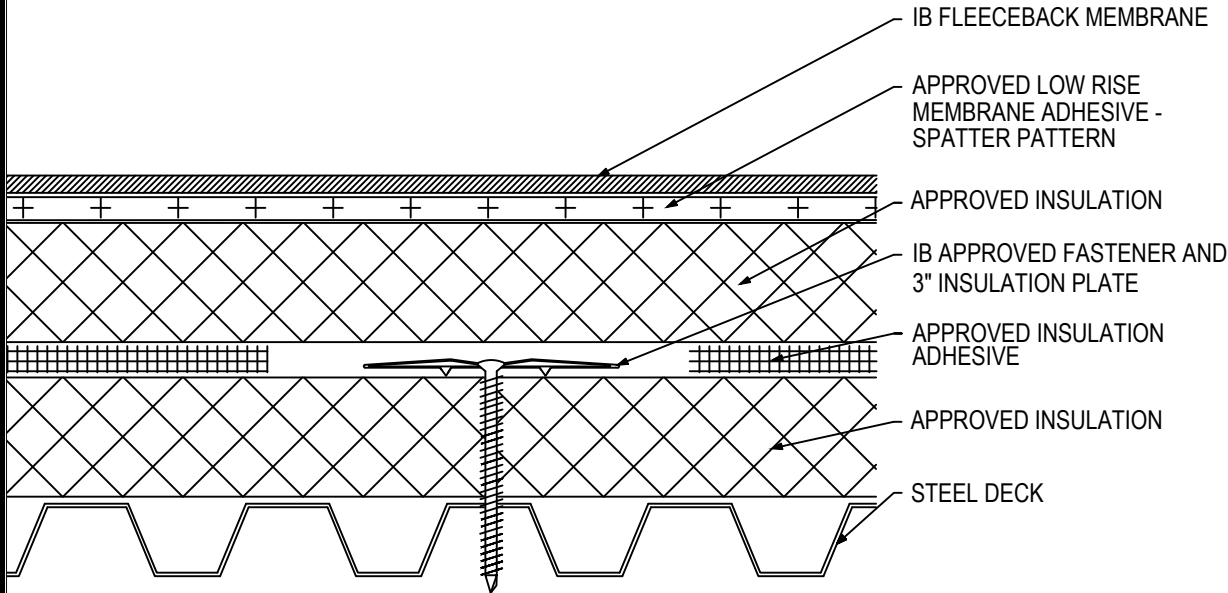

**Fully Adhered Membrane (SP) - Insulation (RB) - Insulation (MA) - Steel Deck (New and Tear-Off)**

Fire Rating / Max. Slope	Deck Type	Insulation			Insulation			IB Fleeceback Membrane Attachment	Max. Design Pressure**
		Type	Attachment	Fastener	Type	Insulation Adhesive	Pattern		
<input type="checkbox"/> Class "A" Unlimited	Min. 22 ga. Type B, Grade 33 Steel	Min 2" Approved Insulation	8 per 4' x 8' (1 per 4.0 sq. ft.)	Min. IB SD #12 or HD #14, 3" IB Insulation Plate	Min. 1" Approved Insulation	BM, CR20, OB500, OSFA, PG1, or RSIA	Four continuous ribbons, 12" o.c.	CR-20 Spatter Pattern 3.75 lbs/square	Minimum Req. for IB Warranty
<input type="checkbox"/> Class "A" Unlimited	Min. 22 ga. Type B, Grade 33 Steel	Min 1.5" Approved Insulation	10 per 4' x 8' (1 per 3.2 sq. ft.)	Min. IB SD #12 or HD #14, 3" IB Insulation Plate	Min. 1" Approved Insulation	BM, CR20, OB500, OSFA, PG1, or RSIA	Four continuous ribbons, 12" o.c.	CR-20 Spatter Pattern 3.75 lbs/square	Minimum Req. for IB Warranty
<input type="checkbox"/> Class "A" Unlimited	Min. 22 ga. Type B, Grade 33 Steel	Min 1.5" Approved Insulation	12 per 4' x 8' (1 per 2.67 sq. ft.)	Min. IB SD #12 or HD #14, 3" IB Insulation Plate	Min. 1" Approved Insulation	BM, CR20, OB500, OSFA, PG1, or RSIA	Four continuous ribbons, 12" o.c.	CR-20 Spatter Pattern 3.75 lbs/square	Minimum Req. for IB Warranty

**Approved Insulation:** IB EnergyBoard II or III, Atlas AC Foam II or III, H-Shield or H-Shield CG

**Approved Insulation Adhesive:** BM = Polyset BoardMax, CR-20 = Polyset CR-20, OB500 = OlyBond 500 Adhesive Fastener, OSFA = Millennium One-Step Foamable Adhesive; PG-1 = Millennium PG-1 Pump Grade Adhesive; or RSIA = IB Rapid Set Insulation Adhesive; maximum bead spacing 12" o.c. unless otherwise indicated

**Fire Classification Note(s):** <sup>1</sup>UL Class 'A' Classification with an unlimited slope when utilized with any of the following IB Approved ISO Insulations: IB Energy Board II, IB Energy Board III, ACfoam II, or ACfoam III any thickness mechanically attached or adhered with any UL Classified Insulation Adhesive. <sup>2</sup>UL Class 'A' up to  $\frac{1}{4}$ "-12" when utilized with minimum 1" IB H-Shield CG ISO, mechanically attached or adhered with any UL Classified Insulation Adhesive. <sup>3</sup>Use of other IB Approved Insulations may not achieve UL Classification.

\*\* Refer to Substrate Resistance table for required pull-out values.

For additional information about IB Roof Systems requirements, recommendations, installation details, approvals and limitations for the above assemblies, please refer to the latest edition of the IB Roof Systems Specifications Manual. For Technical Services please contact us at 800-426-1626.

Membranes:	Membrane Color:	Warranty Length***	Warranty Type***
<input type="checkbox"/> IB PVC Single-Ply FB 50 Mil	<input type="checkbox"/> White*	<input type="checkbox"/> 10 Year <input type="checkbox"/> 15 Year <input type="checkbox"/> 20 Year	<input type="checkbox"/> Total System - No Dollar Limit (NDL)
<input type="checkbox"/> IB PVC Single-Ply FB 60 Mil	<input type="checkbox"/> White*	<input type="checkbox"/> 15 Year <input type="checkbox"/> 20 Year <input type="checkbox"/> 25 Year	<input type="checkbox"/> Warranty Plus (WP)
<input type="checkbox"/> IB PVC Single-Ply FB 80 Mil	<input type="checkbox"/> White*	<input type="checkbox"/> 20 Year <input type="checkbox"/> 25 Year <input type="checkbox"/> 30 Year	<input type="checkbox"/> Commercial Limited Material Warranty (CLMW)
			<input type="checkbox"/> Residential Limited Material Warranty (RLMW)

\* Meets CRRC, Title-24, & EnergyStar Standards

\*\*\* Refer to Warranty Selection Guide for Warranty Riders, Term Length Limitations, and eligibility requirements of the Warranty Program

<b>Submitted By:</b> Address: Email:	<b>Project Name:</b> Address:
--	----------------------------------