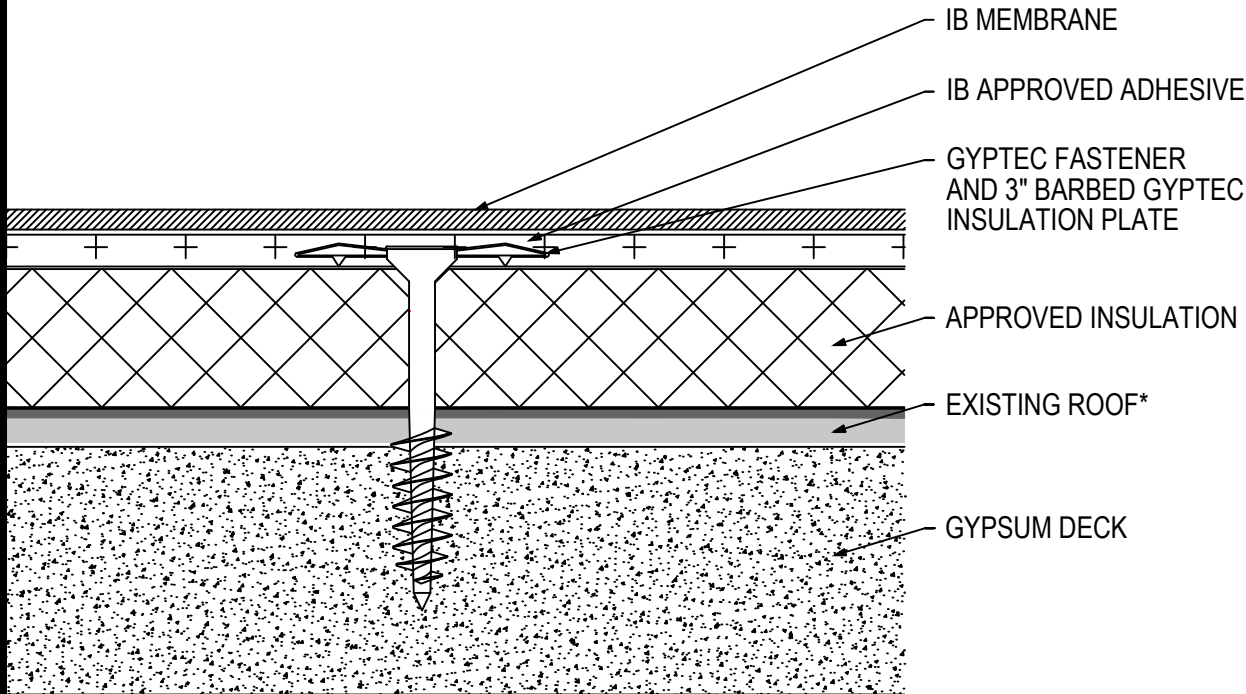

Fully Adhered Membrane - Insulation(MA) - Existing Roof - Gypsum Deck (Recover)

Fire Rating / Max. Slope	Deck Type	Insulation (over Existing Roof)			IB Membrane Attachment	Max. Design Pressure**
		Type	Attachment	Fasteners		
<input type="checkbox"/> ¹ Class "A" 3":12"	Poured Gypsum	Min. 1" Approved Insulation	16 per 4' x 8' (1 per 2.0 sq. ft.)	GypTec or Deklite, 3" IB GypTec or Deklite Plate	IB Approved Adhesive	Minimum Req for IB Warranty
<input type="checkbox"/> ¹ Class "A" 3":12"	Poured Gypsum	Min. 2" Approved Insulation	12 per 4' x 8' (1 per 2.67 sq. ft.)	GypTec or Deklite, 3" IB GypTec or Deklite Plate	IB Approved Adhesive	Minimum Req for IB Warranty

Existing Roof: APP or SBS modified bitumen, smooth or granule surfaced asphaltic built-up roof, or single-ply membrane (CPA, CSPE, EPDM, PVC, or TPO)

Approved Insulation: IB EnergyBoard II or III, H-Shield or H-Shield CG

Fire Classification Note(s): ¹UL Class A up to 3":12" when utilized with IB EnergyBoard II or AC Foam II, any thickness, over an existing insulated or non-insulated cap, sheet smooth or gravel surfaced (loose gravel may be removed). ²UL Class A up to 1/2":12" when utilized with one layer of 3" or two layers of 1.5" H-Shield CG, over an existing Class A, B or C roofing system (gravel may be removed from gravel built-up or ballasted single-ply system). ³UL Class B up to 1/2":12" when utilized with minimum 1.9" H-Shield CG over an existing Class A, B or C roofing system (gravel may be removed from gravel built-up or ballasted single-ply system). ⁴The use of other IB Approved Insulations or lesser thicknesses may not retain Classification.

** Refer to Substrate Resistance table for required pull-out values.

For additional information about IB Roof Systems requirements, recommendations, installation details, approvals and limitations for the above assemblies, please refer to the latest edition of the IB Roof Systems Specifications Manual. For Technical Services please contact us at 800-426-1626.

Membranes:	Membrane Color:	Warranty Length***	Warranty Type***
<input type="checkbox"/> IB PVC Single-Ply 50 Mil	<input type="checkbox"/> White* <input type="checkbox"/> Gray <input type="checkbox"/> Tan <input type="checkbox"/> Bronze <input type="checkbox"/> ChemGuard*	<input type="checkbox"/> 10 Year <input type="checkbox"/> 15 Year <input type="checkbox"/> 20 Year	<input type="checkbox"/> Total System - No Dollar Limit (NDL)
<input type="checkbox"/> IB PVC Single-Ply 60 Mil	<input type="checkbox"/> White* <input type="checkbox"/> Cool Sand* <input type="checkbox"/> Cool Stone* <input type="checkbox"/> Gray <input type="checkbox"/> Tan	<input type="checkbox"/> 15 Year <input type="checkbox"/> 20 Year <input type="checkbox"/> 25 Year	<input type="checkbox"/> Warranty Plus (WP)
<input type="checkbox"/> IB PVC Single-Ply 80 Mil	<input type="checkbox"/> White* <input type="checkbox"/> Gray <input type="checkbox"/> Tan <input type="checkbox"/> Bronze <input type="checkbox"/> ChemGuard*	<input type="checkbox"/> 15 Year <input type="checkbox"/> 20 Year <input type="checkbox"/> 25 Year	<input type="checkbox"/> Commercial Limited Material Warranty (CLMW)
			<input type="checkbox"/> Residential Limited Material Warranty (RLMW)

* Meets CRRC, Title-24, & EnergyStar Standards

*** Refer to Warranty Selection Guide for Warranty Riders, Term Length Limitations, and eligibility requirements of the Warranty Program

Submitted By:
Address:
Email:

Project Name:
Address: