

Fully Adhered Membrane - Cover Board (MA) - Gypsum Deck (Tear-Off)

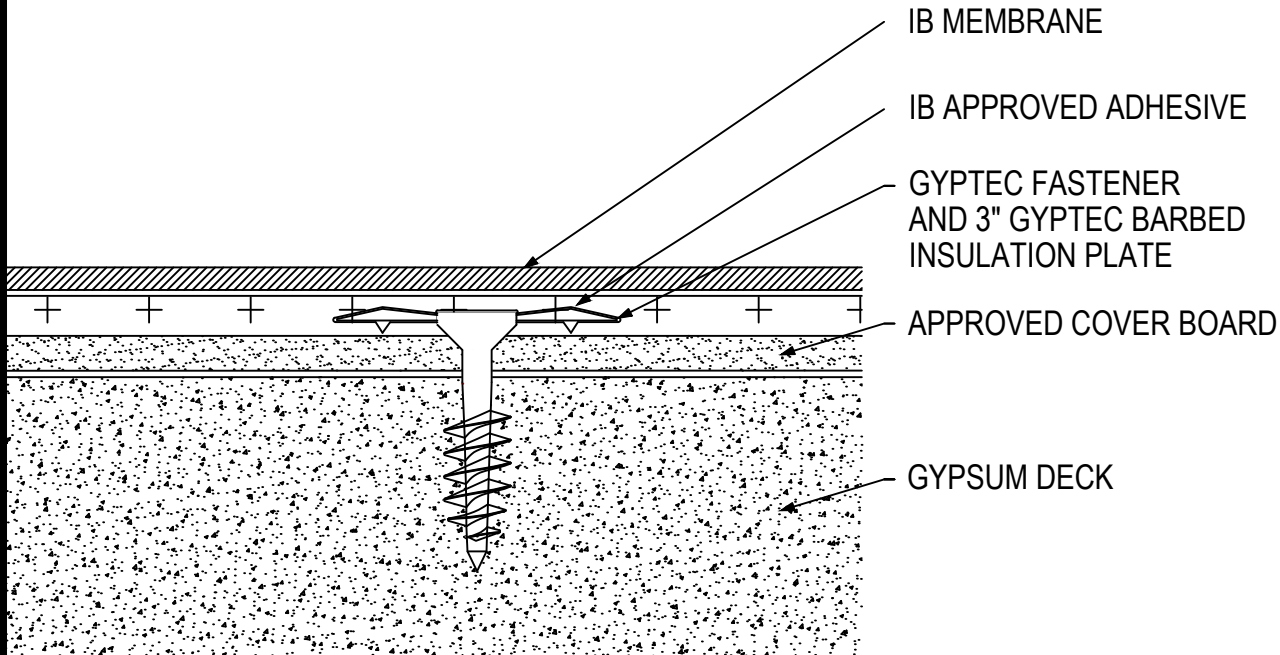

Fire Rating / Max. Slope	Deck Type	Cover Board			IB Membrane Attachment	Max. Design Pressure**
		Type	Attachment	Fasteners		
<input type="checkbox"/> 'Class 'A' Unlimited	Poured Gypsum	Approved 1/2" Cover Board	12 per 4' x 8' (1 per 2.67 sq. ft.)	GypTec or Deklite, 3" IB GypTec or Deklite Plate	IB Approved Adhesive	Minimum Req for IB Warranty
<input type="checkbox"/> 'Class 'A' Unlimited	Poured Gypsum	Approved 1/4" Cover Board	16 per 4' x 8' (1 per 2.0 sq. ft.)	GypTec or Deklite, 3" IB GypTec or Deklite Plate	IB Approved Adhesive	Minimum Req for IB Warranty

Approved Cover Board: DensDeck Prime, DexCell FA Glass Mat Roof Board, Securock Coated Glass Mat Roof Board, Securock Gypsum Fiber Board, minimum 1/4" thickness; 7/16" DexCell Cement Board, or minimum 1/2" IB HD ISO; or minimum 1/2" thick Structodek HD Primed

Fire Classification Note(s): ¹UL Class 'A' with unlimited slope when utilized with any of the following gypsum cover boards: minimum 1/4" DensDeck Prime, DexCell FA Glass Mat Roof Board, Securock Coated Glass Mat Roof Board, Securock Gypsum-Fiber Roof Board or minimum 7/16" DexCell Cement Board and membrane adhered using IB Vertibond 432 Bonding Adhesive. ²UL Class 'A' up to 1/2":12" when utilized with minimum 1/2" IB HD ISO or H-Shield HD ISO. ³The use of other IB Approved Cover Boards may not achieve UL classification.

** Refer to Substrate Resistance table for required pull-out values.

For additional information about IB Roof Systems requirements, recommendations, installation details, approvals and limitations for the above assemblies, please refer to the latest edition of the IB Roof Systems Specifications Manual. For Technical Services please contact us at 800-426-1626.

Membranes:	Membrane Color:	Warranty Length***	Warranty Type***
<input type="checkbox"/> IB PVC Single-Ply 50 Mil	<input type="checkbox"/> White* <input type="checkbox"/> Gray <input type="checkbox"/> Tan <input type="checkbox"/> Bronze <input type="checkbox"/> ChemGuard*	<input type="checkbox"/> 10 Year <input type="checkbox"/> 15 Year <input type="checkbox"/> 20 Year	<input type="checkbox"/> Total System - No Dollar Limit (NDL)
<input type="checkbox"/> IB PVC Single-Ply 60 Mil	<input type="checkbox"/> White* <input type="checkbox"/> Cool Sand* <input type="checkbox"/> Cool Stone* <input type="checkbox"/> Gray <input type="checkbox"/> Tan	<input type="checkbox"/> 15 Year <input type="checkbox"/> 20 Year <input type="checkbox"/> 25 Year	<input type="checkbox"/> Warranty Plus (WP)
<input type="checkbox"/> IB PVC Single-Ply 80 Mil	<input type="checkbox"/> White* <input type="checkbox"/> Gray <input type="checkbox"/> Tan <input type="checkbox"/> Bronze <input type="checkbox"/> ChemGuard*	<input type="checkbox"/> 20 Year <input type="checkbox"/> 25 Year <input type="checkbox"/> 30 Year	<input type="checkbox"/> Commercial Limited Material Warranty (CLMW)
			<input type="checkbox"/> Residential Limited Material Warranty (RLMW)

* Meets CRRC, Title-24, & EnergyStar Standards

*** Refer to Warranty Selection Guide for Warranty Riders, Term Length Limitations, and eligibility requirements of the Warranty Program

Submitted By: Address: Email:	Project Name: Address:
--	----------------------------------