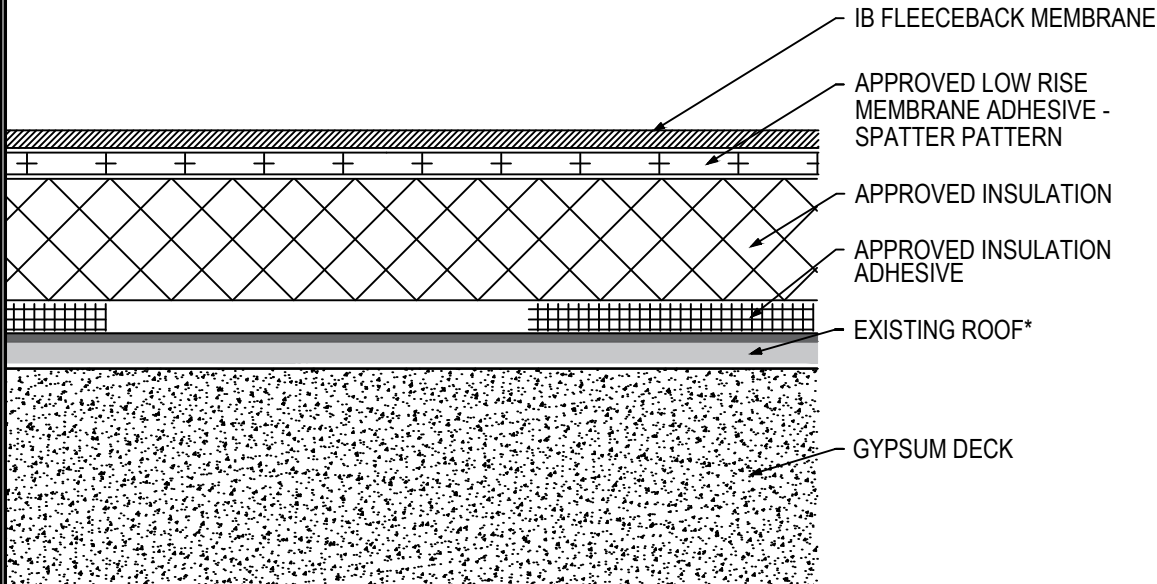

Fully Adhered Membrane (SP) - Insulation (RB) - Existing Roof - Gypsum Deck (Recover)

Fire Rating / Max Slope	Deck Type	Insulation (over Existing Asphaltic Roof)			IB Fleeceback Membrane Attachment	Max. Design Pressure**
		Type	Insulation Adhesive	Fasteners		
<input type="checkbox"/> Maintains Existing 1":12"	Poured Gypsum	Approved Insulation	BM, CR20, OB500, OSFA, PG1, or RSIA	Four continuous ribbons, 12" o.c.	CR-20 Spatter Pattern 3.75 lbs/square	Minimum Req for IB Warranty
<input type="checkbox"/> Maintains Existing 1":12"	Poured Gypsum	Approved 1.5" EnergyBoard II or AC Foam II Insulation	OB500	Four continuous ribbons, 12" o.c.	CR-20 Spatter Pattern 3.75 lbs/square	-120.0 psf (Class 240)
<input type="checkbox"/> Maintains Existing 1":12"	Poured Gypsum	Approved 1.5" EnergyBoard II or AC Foam II Insulation	OSFA, PG1, or RSIA	Four continuous ribbons, 12" o.c.	CR-20 Spatter Pattern 3.75 lbs/square	-215.0 psf (Class 430)
<input type="checkbox"/> Maintains Existing 1":12"	Poured Gypsum	Min 1" EnergyBoard II or III, AC Foam II or III, H-Shield or H-Shield CG Insulation	CR20	Four continuous ribbons, 12" o.c.	CR-20 Spatter Pattern 3.75 lbs/square	-262.5 psf (Class 525)

Existing Roof: APP or SBS modified bitumen, smooth or granule surfaced asphaltic built-up roof only

Approved Insulation: IB EnergyBoard II or III, H-Shield or H-Shield CG

Approved Insulation Adhesive: BM = Polyset BoardMax, CR-20 = Polyset CR-20, OB500 = OlyBond 500 Adhesive Fastener, OSFA = Millennium One-Step Foamable Adhesive; PG-1 = Millennium PG-1 Pump Grade Adhesive; or RSIA = IB Rapid Set Insulation Adhesive; maximum bead spacing 12" o.c. unless otherwise indicated.

Fire Classification Note(s): 'Maintains existing up to 1":12" slope over any Class A, B or C built up roof system when utilized with any of the following roof insulations: IB Energy Board II, IB Energy Board III, AC Foam II, or AC Foam III any thickness adhered with any UL Classified adhesive. 'Use of other IB Approved Insulations may not achieve UL Classification. 'Recover over modified bitumen may not retain fire classification.

**** Refer to Substrate Resistance table for required pull-out values.**

For additional information about IB Roof Systems requirements, recommendations, installation details, approvals and limitations for the above assemblies, please refer to the latest edition of the IB Roof Systems Specifications Manual. For Technical Services please contact us at 800-426-1626.

Membranes:	Membrane Color:	Warranty Length***	Warranty Type***
<input type="checkbox"/> IB PVC Single-Ply FB 50 Mil	<input type="checkbox"/> White*	<input type="checkbox"/> 10 Year <input type="checkbox"/> 15 Year <input type="checkbox"/> 20 Year	<input type="checkbox"/> Total System - No Dollar Limit (NDL)
<input type="checkbox"/> IB PVC Single-Ply FB 60 Mil	<input type="checkbox"/> White*	<input type="checkbox"/> 15 Year <input type="checkbox"/> 20 Year <input type="checkbox"/> 25 Year	<input type="checkbox"/> Warranty Plus (WP)
<input type="checkbox"/> IB PVC Single-Ply FB 80 Mil	<input type="checkbox"/> White*	<input type="checkbox"/> 15 Year <input type="checkbox"/> 20 Year <input type="checkbox"/> 25 Year	<input type="checkbox"/> Commercial Limited Material Warranty (CLMW)
			<input type="checkbox"/> Residential Limited Material Warranty (RLMW)

* Meets CRRC, Title-24, & EnergyStar Standards

*** Refer to Warranty Selection Guide for Warranty Riders, Term Length Limitations, and eligibility requirements of the Warranty Program

Submitted By:
Address:
Email:

Project Name:
Address: