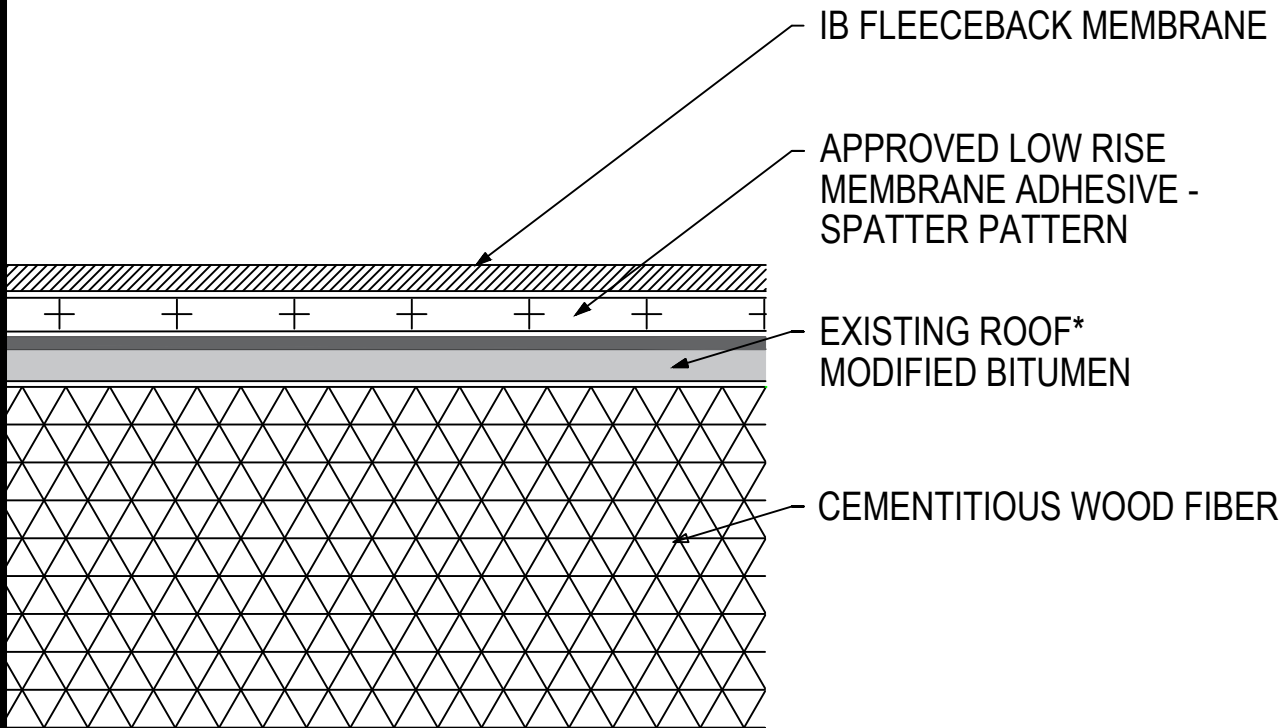

Fully Adhered Membrane (SP) - Existing Roof (Modified Bitumen) - Cementitious Wood Fiber Deck (Recover)

Fire Rating / Max. Slope		Deck Type	IB Fleeceback Membrane (over Existing Modified Bitumen Roof)		Max. Design Pressure**
			Attachment		
<input type="checkbox"/>	¹ Not Rated	Cementitious Wood Fiber	CR-20 Spatter Pattern 3.75 lbs/square		-112.5 psf (Class 225)

Existing Roof: APP or SBS modified bitumen, smooth or granule surfaced roof only.

Fire Classification Note(s): *This assembly is not UL Classified.

*** Refer to Substrate Resistance table for required pull-out values.*

For additional information about IB Roof Systems requirements, recommendations, installation details, approvals and limitations for the above assemblies, please refer to the latest edition of the IB Roof Systems Specifications Manual. For Technical Services please contact us at 800-426-1626.

Membranes:	Membrane Color:	Warranty Length***	Warranty Type***
<input type="checkbox"/> IB PVC Single-Ply FB 50 Mil	<input type="checkbox"/> White*	<input type="checkbox"/> 10 Year <input type="checkbox"/> 15 Year <input type="checkbox"/> 20 Year	<input type="checkbox"/> Total System - No Dollar Limit (NDL)
<input type="checkbox"/> IB PVC Single-Ply FB 60 Mil	<input type="checkbox"/> White*	<input type="checkbox"/> 15 Year <input type="checkbox"/> 20 Year <input type="checkbox"/> 25 Year	<input type="checkbox"/> Warranty Plus (WP)
<input type="checkbox"/> IB PVC Single-Ply FB 80 Mil	<input type="checkbox"/> White*	<input type="checkbox"/> 15 Year <input type="checkbox"/> 20 Year <input type="checkbox"/> 25 Year	<input type="checkbox"/> Commercial Limited Material Warranty (CLMW)
			<input type="checkbox"/> Residential Limited Material Warranty (RLMW)

* Meets CRRC, Title-24, & EnergyStar Standards

*** Refer to Warranty Selection Guide for Warranty Riders, Term Length Limitations, and eligibility requirements of the Warranty Program

Submitted By:
Address:
Email:

Project Name:
Address: