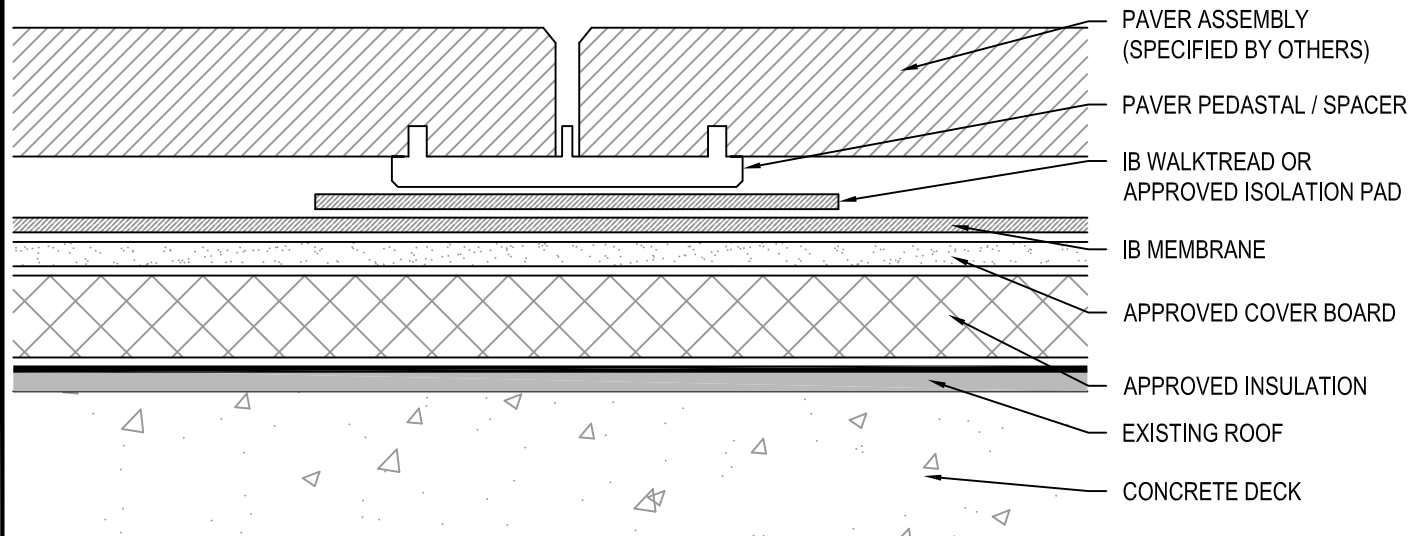

Pavers Ballasted Membrane - Cover Board - Insulation - Existing Roof - Concrete Deck (Recover)

| Fire Rating / Max. Slope | Deck Type | Cover Board / Insulation | | Membrane | Surfacing | Max. Design Pressure** |
|--|--------------------------------------|---|------------|----------------------------|--|---|
| | | Type | Attachment | | | |
| <input type="checkbox"/> Class 'A' 2" : 12" | Min. 2500 psi Structural Concrete | Approved Cover Board Approved Insulation | Loose-laid | Loose-laid 60 or 80 Mil | Approved Paver Assembly (Min. 22 lbs. / sq. ft.) | Refer to ANSI/SPRI RP-4 and Selected Paver Manufacturer Wind Approval Listing |

Approved Cover Board: Min. 1/4": DensDeck, DensDeck Prime, Securock, Min. 1/2" HS Cover Board.

Approved Insulation: 1": IB Energy Board II & III, IB Approved Polyisocyanurate, Approved Polystyrene - Expanded (EPS Type II, VIII or IX) or Extruded (XPS Type IV).

**** Refer to Substrate Resistance table for required pull-out values.**

For additional information about IB Roof Systems requirements, recommendations, installation details, approvals and limitations for the above assemblies, please refer to the latest edition of the IB Roof Systems Specifications Manual. For Technical Services please contact us at 800-426-1626.

| Membranes: | Colors: | Warranties: | Warranty Lengths: |
|--|---|---|---|
| <input type="checkbox"/> 60 Mil Membrane <input type="checkbox"/> 80 Mil Membrane | <input type="checkbox"/> White* <input type="checkbox"/> Cool Sand* <input type="checkbox"/> ChemGuard* <input type="checkbox"/> Gray <input type="checkbox"/> Green <input type="checkbox"/> Red <input type="checkbox"/> Tan <input type="checkbox"/> Brown <input type="checkbox"/> Custom: _____ <small>* Meets CRRC, Title-24, & EnergyStar Standards</small> | <input type="checkbox"/> Total System (NDL) <input type="checkbox"/> Warranty Plus <input type="checkbox"/> Commercial Limited Material <input type="checkbox"/> Lifetime Residential Limited Material | <input type="checkbox"/> 10 yr (60, and 80 mil) <input type="checkbox"/> 15 yr (60, and 80 mil) <input type="checkbox"/> 20 yr (60 and 80 mil) <input type="checkbox"/> 25 yr (80 mil) |

Submitted By:

 Address:
Telephone:

Project Name:

Address:

